

# MP PUMPS, INC.

## PETROLEUM 60

### End Suction Centrifugal Pump

Specifically designed for transfer of petroleum based fluids, MP's *Petroleum 60* series is available in three (3) distinct models: **SO 60**, **SG 60** and **SE 60**.

Designed to close-couple to 56C and 145TC frame electric motors, the models are also available as *Pumpaks*. Additional mounting options include pedestal.

Pump rotation in 90° increments.



### SPECIFICATIONS:

Suction and Discharge . . . . .	1 1/4" x 1" NPT
Housing . . . . .	SO 60... Cast Iron, Ductile Iron (optional) SG 60... Ductile Iron SE 60... Ductile Iron
Impeller, Enclosed . . .	SO 60... Cast Iron SG 60... Aluminum SE 60... Cast Iron
Mechanical Seal . . .	SO 60... Type 21 Viton/Carbon/NiResist/SS SG 60... Type 2 Viton/Carbon/Silicon Carbide/SS SE 60... Type 2 Viton/Carbon/Silicon Carbide/SS
Gasket, Flange . . . .	Composite
Shaft Sleeve . . . . .	Stainless Steel
Fasteners . . . . .	Stainless Steel
Clamp, Shaft . . . . .	Brass, Lead-Free

### COMPATIBLE FOR:

- **SO 60** - Biodiesel, Fuel Oil, Diesel
- **SG 60** - Gasoline, Avgas, Kerosene, Jet A/8
- **SE 60** - Ethanol, E 85

### MOUNTING OPTIONS:

Pedestal Or Close Coupled To Nema C Face Motors

- **SO 60** - TEFC
- **SG 60** - Explosion Proof Class 1 Group D
- **SE 60** - Explosion Proof Class 1 Group D

### PERFORMANCE TO:

65 GPM 112 HD. FT. @ 3450 RPM

motralec

4 rue Lavoisier . ZA Lavoisier . 95223 HERBLAY CEDEX  
Tel. : 01.39.97.65.10 / Fax. : 01.39.97.68.48  
Demande de prix / e-mail : service-commercial@motralec.com

www.motralec.com

# PETROLEUM 60

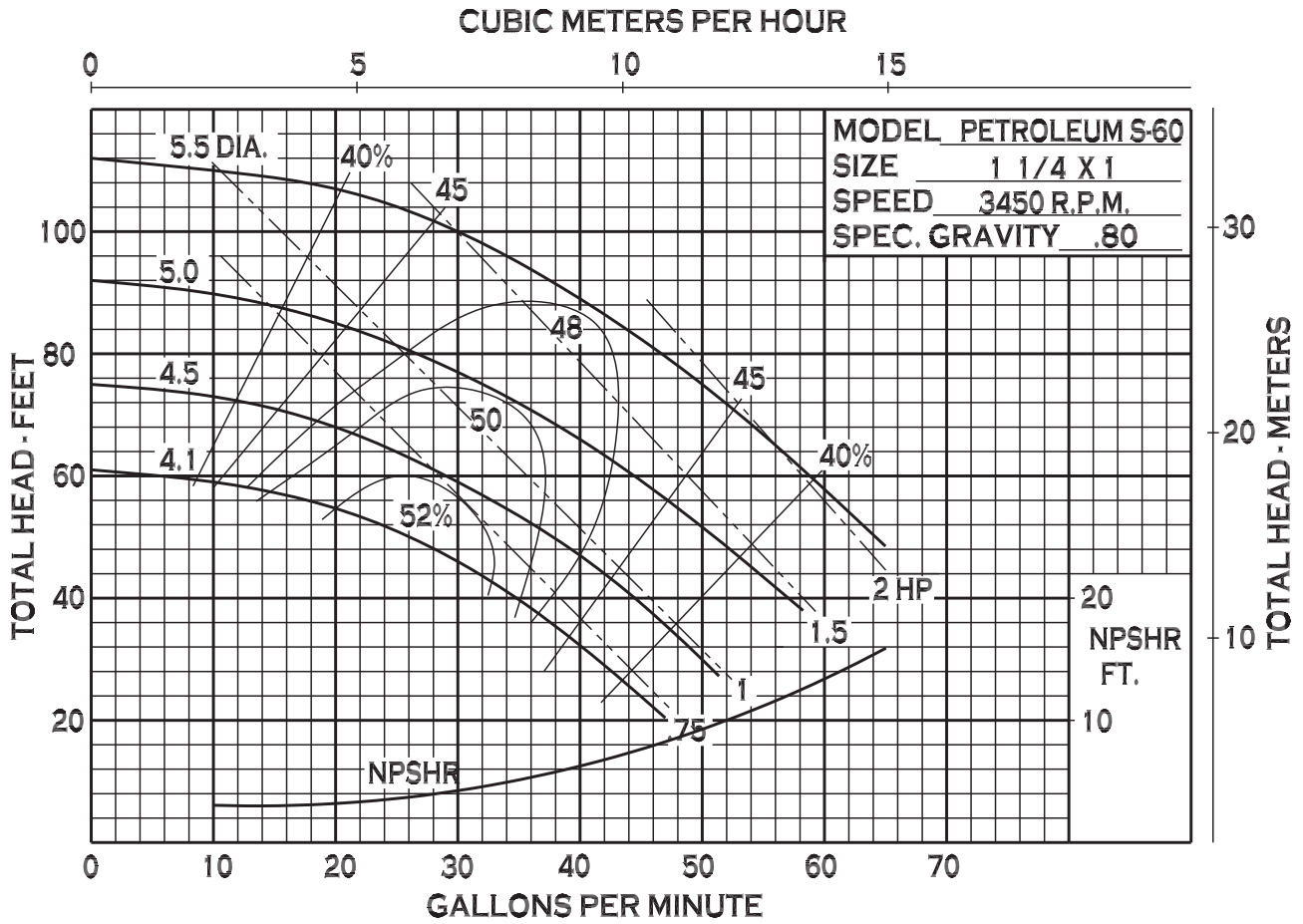

## CLOSE COUPLED - ELECTRIC MOTOR

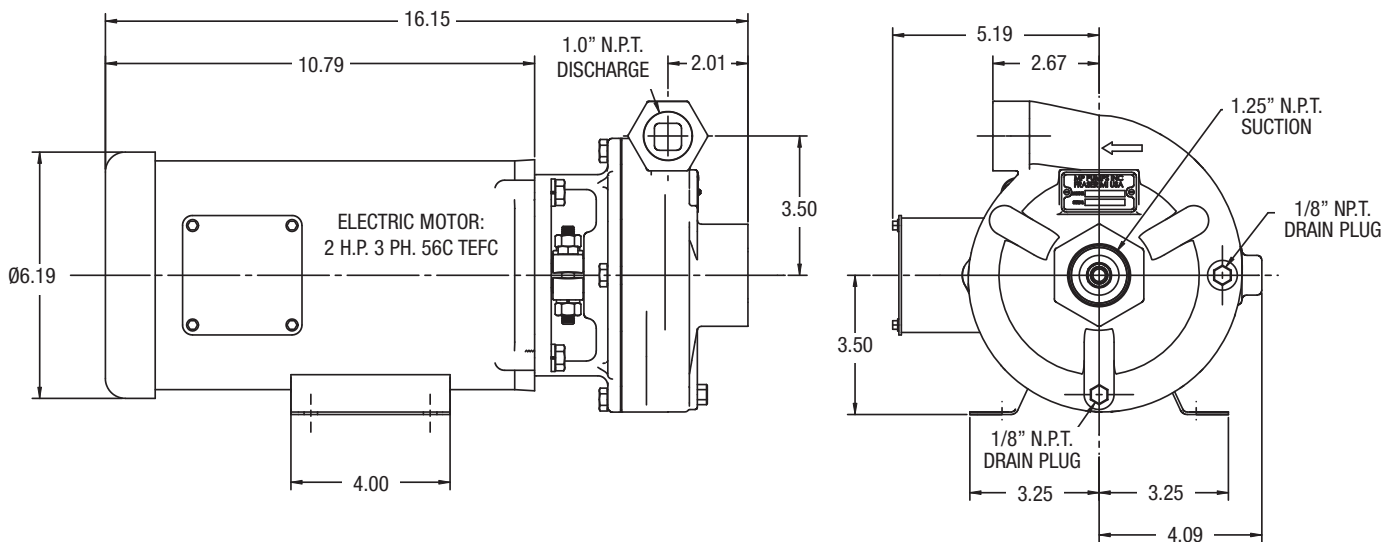

## CLOSE COUPLED - ELECTRIC MOTOR

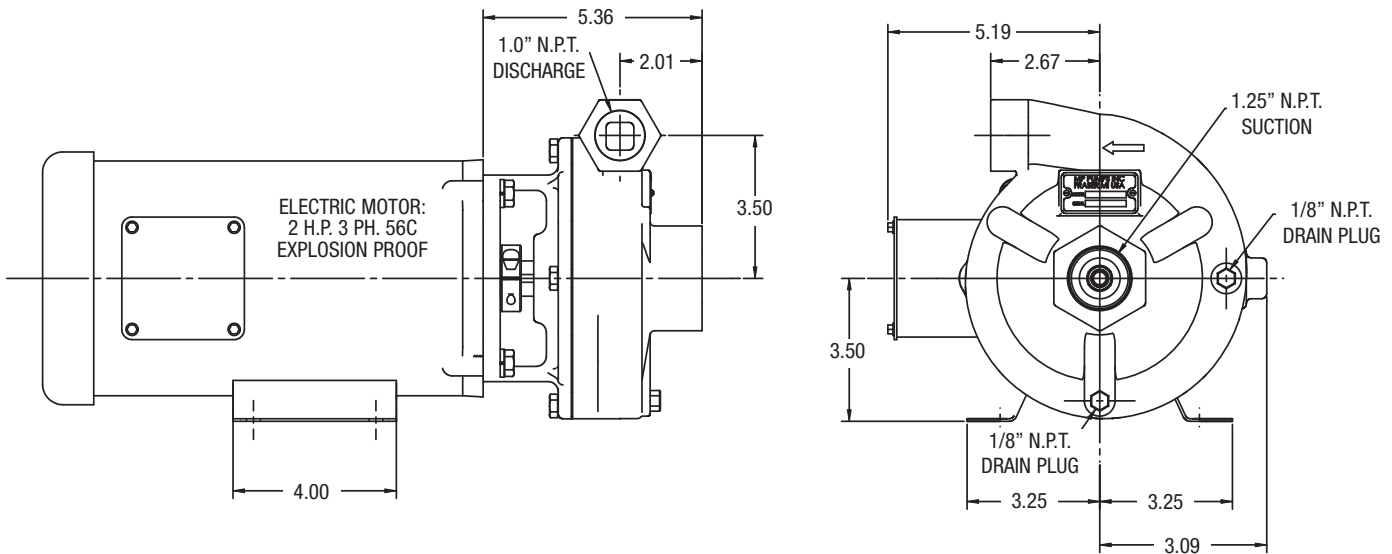

## CLOSE COUPLED - ELECTRIC MOTOR

