



SPX Process Equipment

motralec

4 rue Lavoisier . ZA Lavoisier . 95223 HERBLAY CEDEX
Tel. : 01.39.97.65.10 / Fax. : 01.39.97.68.48
Demande de prix / e-mail : service-commercial@motralec.com
www.motralec.com

ProCam^{MD}

Diaphragm Metering Pumps

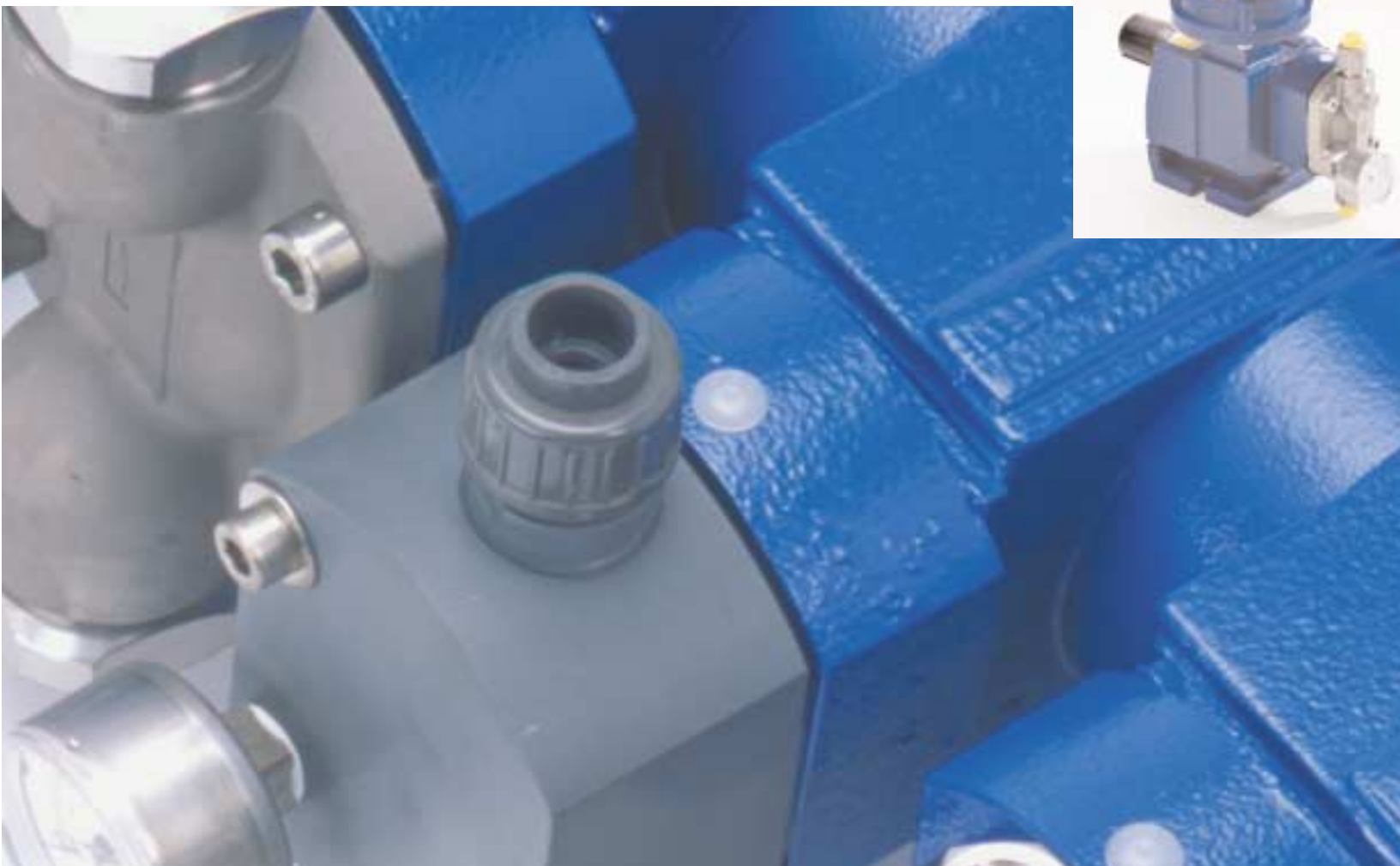

ProCam^{MD} Diaphragm Metering Pumps

Superior Design –
Exceptional Value,
Fast Delivery

ProCam^{MD} diaphragm metering pumps set the standard for ease of operation and reliability in the medium duty chemical metering market. Precision metering for single point injection to 80 GPH (3,000 l/h) and up to 300 psi (20 bar) is now available in a Bran+Luebbe diaphragm pump at an incredible value.

Applications

The ProCam^{MD} is the best in class in the medium duty market. Including...

- Chemical
- Food & Beverage
- Pulp & Paper
- Utilities
- Water Treatment
- ...and many more

Advantages

Economical Pumping of All Types of Liquids

- Unique double diaphragm design provides superior service life.
- Diaphragm monitoring system signals the onset of diaphragm wear.
- Metered liquid is protected from contamination by packing wear or pump lubricant.
- Adjustments to the pumphead are not required.
- Leak free, hermetically sealed fluid end.



DS15 with Stainless Steel Pumphead

Features

Metering Pumphead Design

- Mechanically actuated PTFE double-diaphragm.
- Diaphragm condition monitoring system with pressure gauge or optional pressure switch.
- Materials of construction:
 - 316 Stainless Steel
 - Alloy 20
 - PVC
 - PVDF (Kynar)

Robust Gear Technology

- Proven cam/spring design for long operating life.
- Linear stroke length adjustment.
- Rugged cast iron construction with bearing guided cam and shaft.

Motor

- 1/3 up to 1 HP TEFC 56C NEMA frame. (0.25 or 0.75 kw TEFC (IP54) IEC)
- Single phase or three phase voltage.
- Variable speed available as an option.

ProCam^{MD}: Mechanically Actuated Diaphragm Pumphead with Simple Drive Operation.

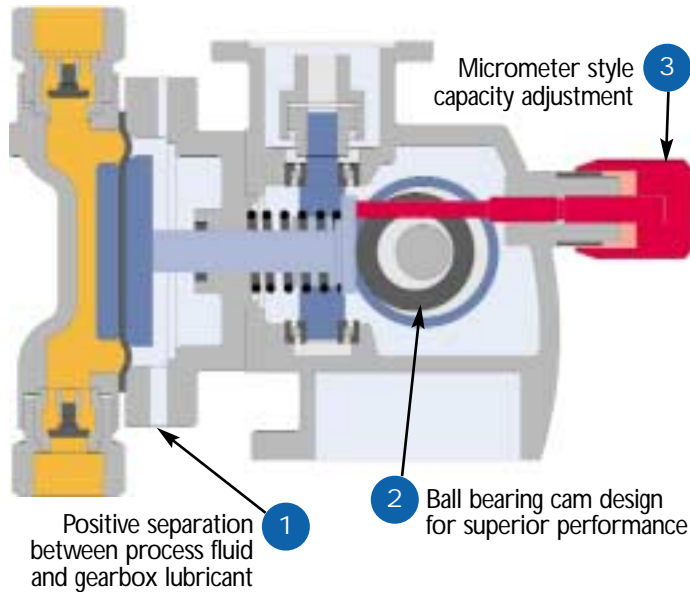

Standard Double Diaphragm Pumphead Design

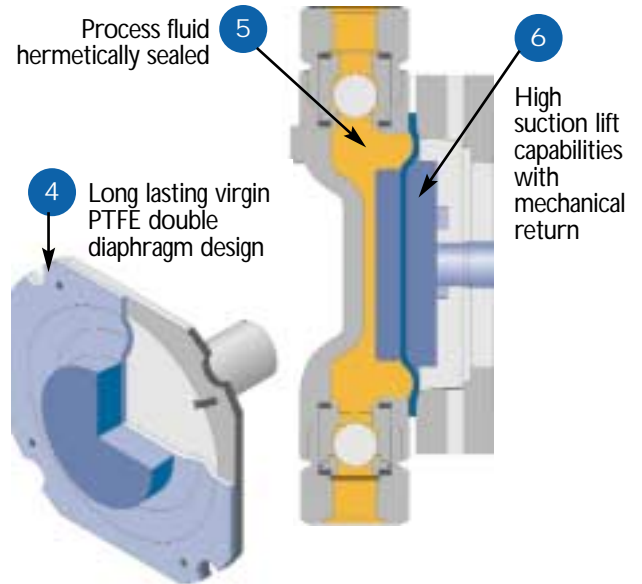

| TECHNICAL DATA | | | | | | | | | | | |
|----------------|-------------------------------------|-----|-----|-----|------------|------------|---------------------------|------------|----------|-------|-------------------|
| Pump Type | Capacity in GPH* per stroke speed** | | | | Connection | Max. Press | Materials of Construction | Dimensions | | | Approx. Wts. LBS. |
| | 64 | 94 | 127 | 188 | | | | A | B | C | |
| DS 15 | 1.8 | 2.7 | 3.6 | 5.4 | 3/8" | 300 | 316SS/Alloy 20 | 7.87" | 12.25" | 19.5" | 40 |
| DP 15 | | | | | | 150 | | | PVC/PVDF | | 12.87" |
| DS 50 | 6 | 9 | 12 | 18 | 3/8" | 150 | 316SS/Alloy 20 | 8" | 11.87" | 19.5" | 40 |
| DP 50 | | | | | | 150 | | | PVC/PVDF | | 12.87" |
| DS 200 | 27 | 40 | 54 | 80 | 1/2" | 175 | 316SS/Alloy 20 | 9.25" | 13.5" | 19.5" | 65 |
| DP 200 | | | | | | 150 | | | PVC/PVDF | | 16" |

* Note: Values at 100% volumetric efficiency.
 ** At 64 & 94 spm, motor RPM is 1750.
 ** At 127 & 188 spm, motor RPM is 3500.

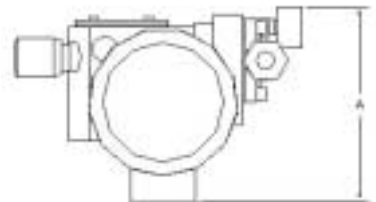

| TECHNICAL DATA | | | | | | | | | | | |
|----------------|-------------------------------------|-----|------|------|------------|------------|---------------------------|---------------|----------|-----|-----------------|
| Pump Type | Capacity in LPH* per stroke speed** | | | | Connection | Max. Press | Materials of Construction | Dimensions mm | | | Approx. Wts. KG |
| | 50 | 72 | 100 | 144 | | | | mm | BAR | A | |
| DS 15 | 5.3 | 7.8 | 10.6 | 15.6 | 9 | 20 | 316SS/Alloy 20 | 200 | 311 | 495 | 18 |
| DP 15 | | | | | | 10 | | | PVC/PVDF | | 327 |
| DS 50 | 17.5 | 26 | 35 | 52 | 9 | 10 | 316SS/Alloy 20 | 203 | 302 | 495 | 18 |
| DP 50 | | | | | | 10 | | | PVC/PVDF | | 327 |
| DS 200 | 79 | 115 | 158 | 230 | 13 | 12 | 316SS/Alloy 20 | 235 | 343 | 495 | 29.5 |
| DP 200 | | | | | | 10 | | | PVC/PVDF | | 406 |

* Note: Values at 100% volumetric efficiency.
 ** At 50 & 72 spm, motor RPM is 1400.
 ** At 100 & 144 spm, motor RPM is 2800.

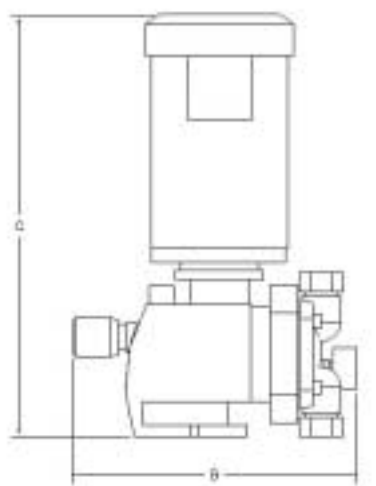

Global Headquarters:
SPX Process Equipment, Delavan, WI USA

motralec

4 rue Lavoisier . ZA Lavoisier . 95223 HERBLAY CEDEX
Tel. : 01.39.97.65.10 / Fax. : 01.39.97.68.48
Demande de prix / e-mail : service-commercial@motralec.com
www.motralec.com