

★★★★★ 4,7/5 sur +600 avis Google . Depuis 1976 . 3 agences : Herblay (95), Sèvres (92), Étréchy (91) . www.motralec.com

Fiche produit Motralec Ziehl Abegg Maxventowlet DN63V - fiche technique | Motralec

■ **DEMANDE DE PRIX RAPIDE** : <https://www.motralec.com/demandeContact>

MAXventowlet, AC-Technology

Medium Pressure Axial Fans North America

www.motralec.com / service-commercial@motralec.com / 01.39.97.65.10

MAXventowlet

for three phase alternating current, 2 pole

DN63V



Description

- Rated voltage U_N : 3-460 V*
- Rated frequency f_N : 60 Hz*
- Min. permitted ambient temperature $t_{amb(min)}$: -4 °F / -20 °C
- Max. permitted ambient temperature $t_{amb(max)}$: 122 °F / 50 °C
- Number of blades: 9
- Degree of protection : TEFC
- Blade: ZAmid, Impeller unpainted, Blue
- Motor: Standard motor NEMA
- * Rated data
- Other versions on request.

Characteristic curve

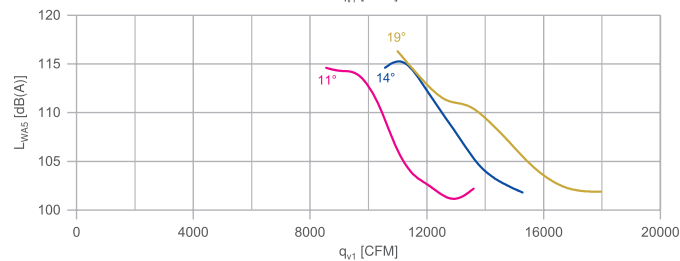
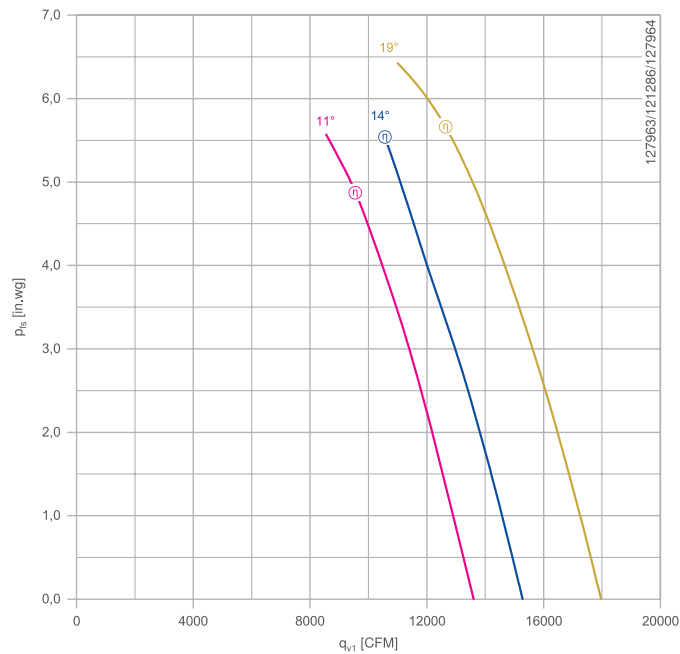

Measured in long casing with inlet bell mouth without guard grille in installation type A air flow impeller/ motor according to ISO 5801

Dimensions inch

Design F
Long casing

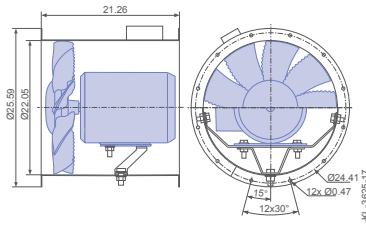

Design K
Short casing (on request)

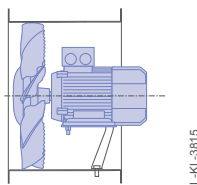

Design S - Short casing
with integrated inlet nozzle (on request)

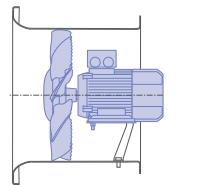

Technical data

Type	Blade setting	Rated power hp	Motor size	Motor technology	Design F	Efficiency	Efficiency grade
					Weight		
	°				lbs	n_{statA} %	N_{actual} %
DN63V-2DF.K7.11.G9	11	20	256T	PEM	364.7	51.1	51.1
DN63V-2DF.K7.14.G9	14	20	256T	PEM	364.7	49.7	49.5
DN63V-2DF.K7.19.G9	19	25	256T	PEM	407.9	47.1	46.7





Description

Rated voltage U_N : 3-460 V*
 Rated frequency f_N : 60 Hz*
 Min. permitted ambient temperature $t_{amb(min)}$: -4 °F / -20 °C
 Max. permitted ambient temperature $t_{amb(max)}$: 122 °F / 50 °C
 Number of blades: 9
 Degree of protection : TEFC
 Blade: High Performance Composite Material, Impeller unpainted, black
 Motor: Standard motor NEMA
 * Rated data
 Other versions on request.

Characteristic curve

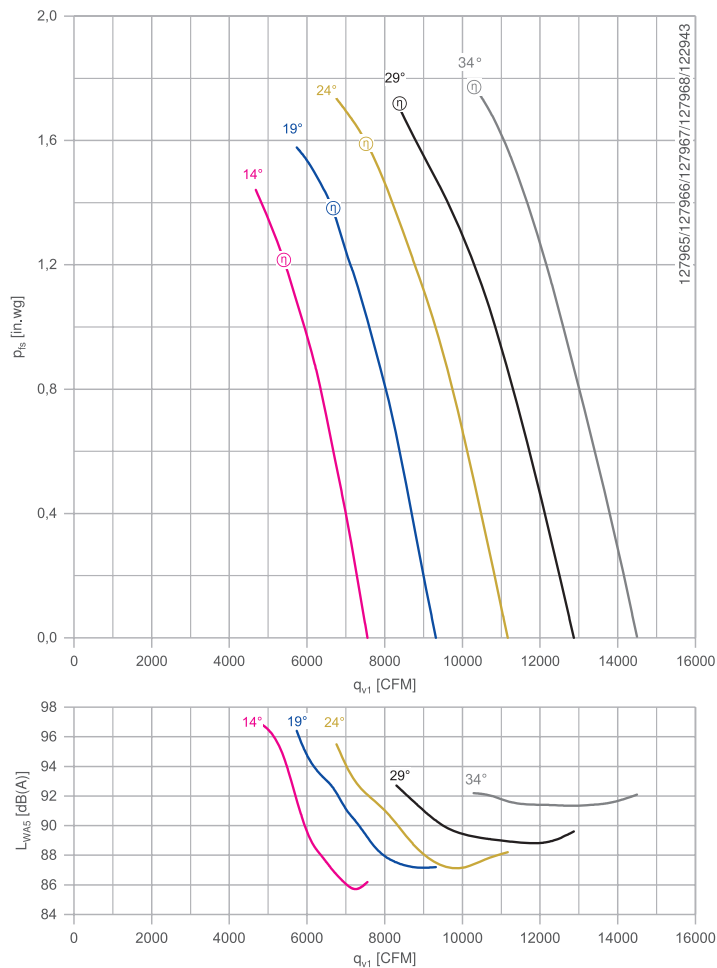

Measured in long casing with inlet bell mouth without guard grille in installation type A air flow impeller/ motor according to ISO 5801

Dimensions inch

Design F
 Long casing

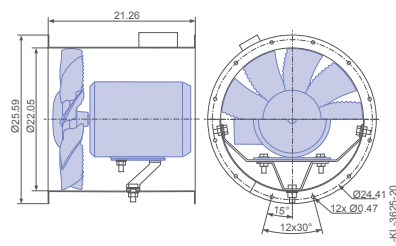

Design K
 Short casing (on request)

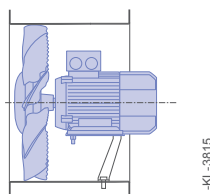

Design S - Short casing
 with integrated inlet nozzle (on request)

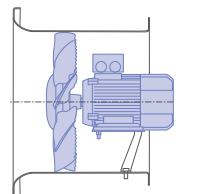

Technical data

Type	Blade setting °	Rated power hp	Motor size	Motor technology	Design F Weight lbs	Efficiency	Efficiency grade
						η_{statA} %	N_{actual} %
DN63V-4DF.E7.14.G9	14	3	182T	PEM	163.8	50.8	55.9
DN63V-4DF.E7.19.G9	19	3	182T	PEM	163.8	52.1	56.4
DN63V-4DF.F7.24.G9	24	5	184T	PEM	183.9	49.5	52.9
DN63V-4DF.F7.29.G9	29	5	184T	PEM	183.9	45.4	48.0
DN63V-4DF.G7.34.G9	34	7.5	213T	PEM	243.4	41.5	43.2

www.ziehl-abegg.com

Besoin d'un prix ou d'un conseil technique ?

Ventilateur Ziehl Abegg MAXVENTOWLET DN63V



4,7/5 . +600 avis Google

- Devis rapide et conseil technique par nos spécialistes
- Plus de 200 000 références et 30 marques distribuées
- Vente, réparation, bobinage et SAV en atelier
- Livraison partout en France, accompagnement avant et après-vente

Voir la gamme Ziehl Abegg sur notre site :

www.motralec.com/.../ziehl-abegg

DEMANDER UN PRIX >