

**Fiche produit Motralec Ziehl Abegg Maxventowlet DN50V - fiche technique | Motralec**

■ **DEMANDE DE PRIX RAPIDE : <https://www.motralec.com/demandeContact>**

MAXventowlet, AC-Technology

Medium Pressure Axial Fans North America

[www.motralec.com](http://www.motralec.com) / [service-commercial@motralec.com](mailto:service-commercial@motralec.com) / 01.39.97.65.10

# MAXventowlet

for three phase alternating current, 2 pole

DN50V



**Description**

- Rated voltage  $U_N$ : 3-460 V\*
- Rated frequency  $f_N$ : 60 Hz\*
- Min. permitted ambient temperature  $t_{amb(min)}$ : -4 °F / -20 °C
- Max. permitted ambient temperature  $t_{amb(max)}$ : 122 °F / 50 °C
- Number of blades: 9
- Degree of protection : TEFC
- Blade: ZAmid, Impeller unpainted, Blue
- Motor: Standard motor NEMA
- \* Rated data
- Other versions on request.

**Characteristic curve**

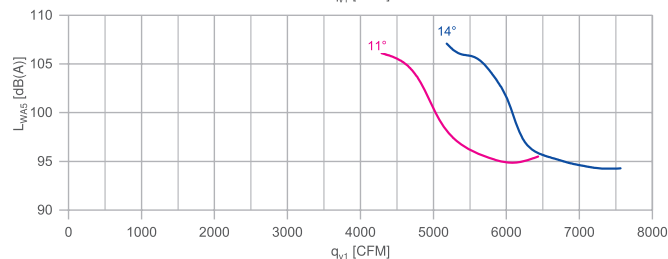
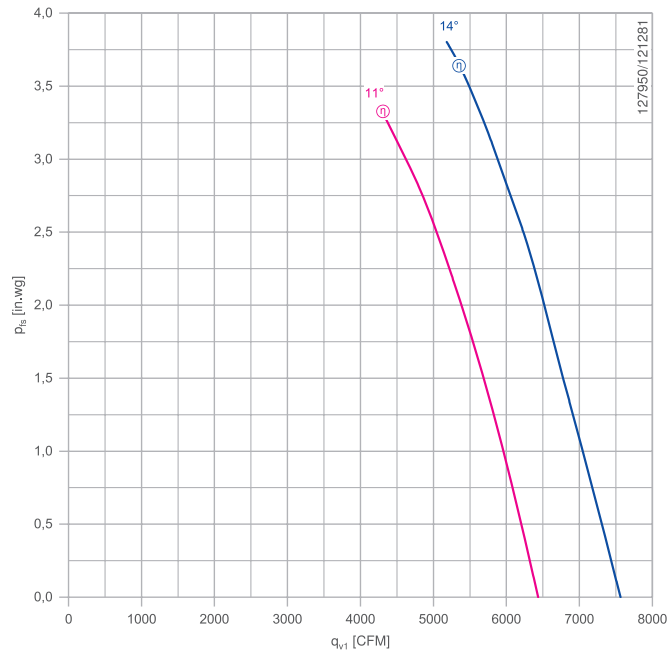

Measured in long casing with inlet bell mouth without guard grille in installation type A air flow impeller/ motor according to ISO 5801

**Dimensions inch**

Design F  
Long casing

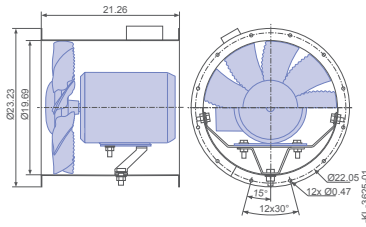

Design K  
Short casing (on request)

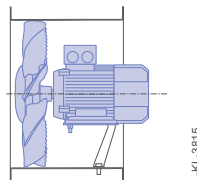

Design S - Short casing  
with integrated inlet nozzle (on request)

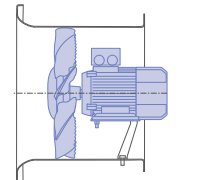

**Technical data**

Type	Blade setting	Rated power hp	Motor size	Motor technology	Design F	Efficiency	Efficiency grade
					Weight lbs		
DN50V-2DF.F7.11.G9	11	7.5	184T	PEM	159.9	47.0	49.8
DN50V-2DF.F7.14.G9	14	7.5	184T	PEM	159.9	48.4	50.4



**Description**

Rated voltage  $U_N$ : 3-460 V\*  
 Rated frequency  $f_N$ : 60 Hz\*  
 Min. permitted ambient temperature  $t_{amb(min)}$ : -4 °F / -20 °C  
 Max. permitted ambient temperature  $t_{amb(max)}$ : 122 °F / 50 °C  
 Number of blades: 9  
 Degree of protection: TEFC  
 Blade: High Performance Composite Material, Impeller unpainted, black  
 Motor: Standard motor NEMA  
 \* Rated data  
 Other versions on request.

**Characteristic curve**

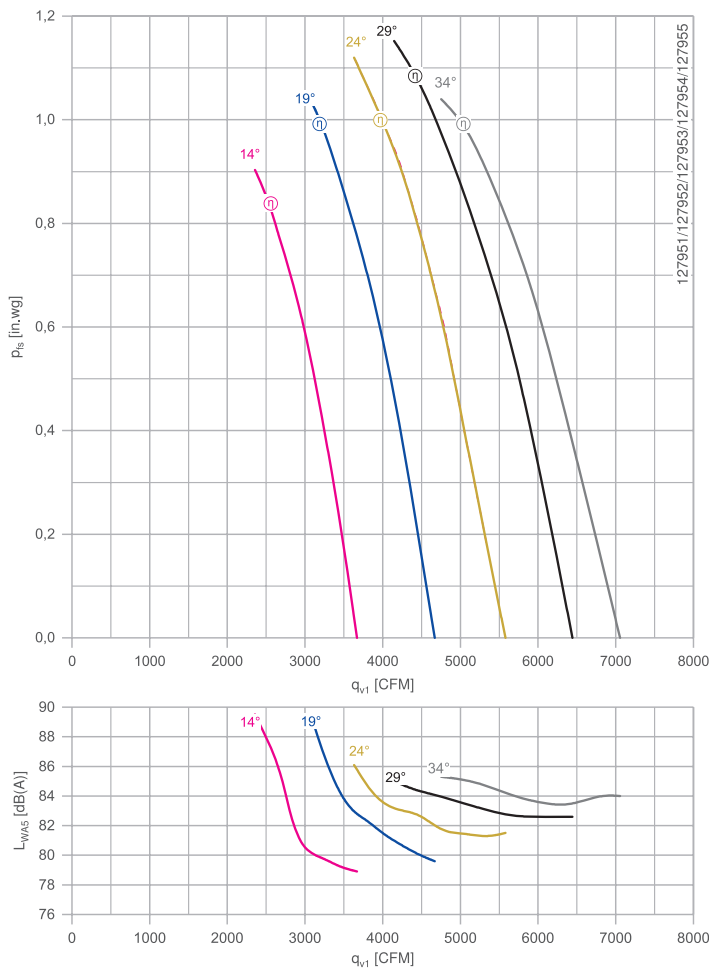

Measured in long casing with inlet bell mouth without guard grille in installation type A air flow impeller/ motor according to ISO 5801

**Dimensions inch**

Design F  
 Long casing

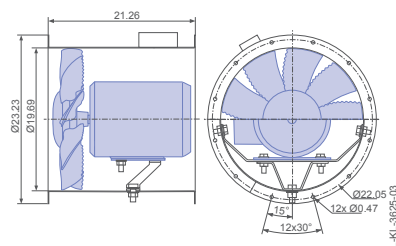

Design K  
 Short casing (on request)

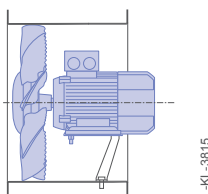

Design S - Short casing  
 with integrated inlet nozzle (on request)

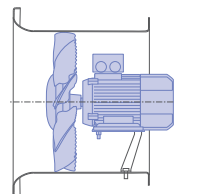

**Technical data**

Type	Blade setting °	Rated power hp	Motor size	Motor technology	Design F Weight lbs	Efficiency	
						$\eta_{statA}$ %	$N_{actual}$ %
DN50V-4DF.B7.14.G9	14	0.75	56	EEM	81.4	42.1	49.8
DN50V-4DF.B7.19.G9	19	1	56	PEM	91.1	40.3	46.8
DN50V-4DF.D7.24.G9	24	1.5	145T	PEM	97.9	43.6	49.7
DN50V-4DF.D7.29.G9	29	1.5	145T	PEM	97.9	41.6	47.0
DN50V-4DF.D7.34.G9	34	2	145T	PEM	101.9	36.1	41.0

www.ziehl-abegg.com



## Besoin d'un prix ou d'un conseil technique ?

Ventilateur Ziehl Abegg MAXVENTOWLET DN50V



4,7/5 . +600 avis Google

- Devis rapide et conseil technique par nos spécialistes
- Plus de 200 000 références et 30 marques distribuées
- Vente, réparation, bobinage et SAV en atelier
- Livraison partout en France, accompagnement avant et après-vente

Voir la gamme Ziehl Abegg sur notre site :

[www.motralec.com/.../ziehl-abegg](http://www.motralec.com/.../ziehl-abegg)

**DEMANDER UN PRIX >**