

★★★★★ 4,7/5 sur +600 avis Google . Depuis 1976 . 3 agences : Herblay (95), Sèvres (92), Étréchy (91) . www.motralec.com

Fiche produit Motralec Ziehl Abegg Maxventowlet DN45V - fiche technique | Motralec

■ **DEMANDE DE PRIX RAPIDE : <https://www.motralec.com/demandeContact>**

MAXventowlet, AC-Technology

Medium Pressure Axial Fans North America

www.motralec.com / service-commercial@motralec.com / **01.39.97.65.10**

MAXventowlet

for three phase alternating current, 2 pole

DN45V



Description

- Rated voltage U_N : 3-460 V*
- Rated frequency f_N : 60 Hz*
- Min. permitted ambient temperature $t_{amb(min)}$: -4 °F / -20 °C
- Max. permitted ambient temperature $t_{amb(max)}$: 122 °F / 50 °C
- Number of blades: 9
- Degree of protection : TEFC
- Blade: ZAmid, Impeller unpainted, Blue
- Motor: Standard motor NEMA
- * Rated data
- Other versions on request.

Characteristic curve

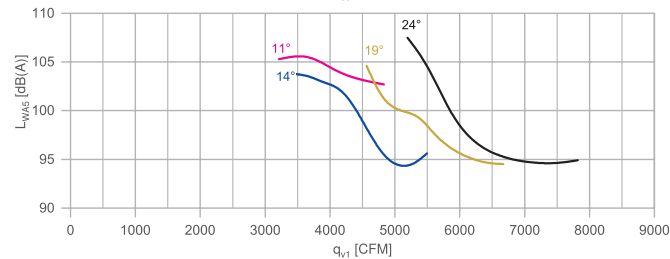
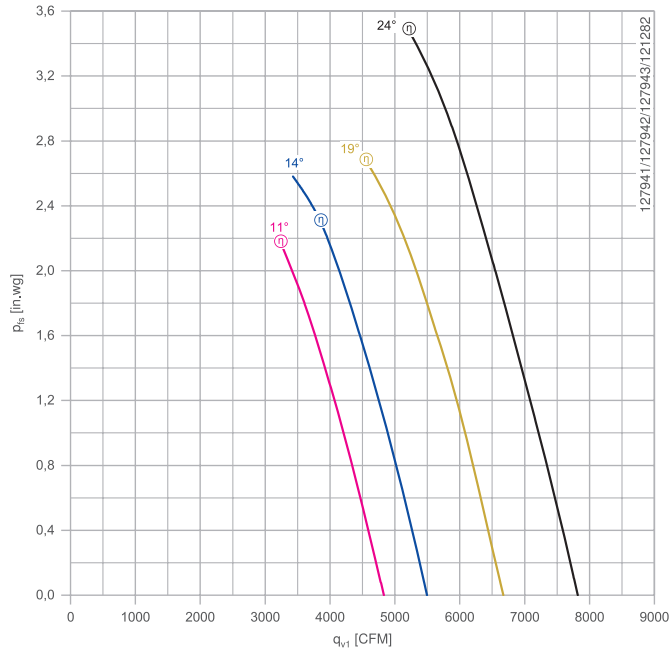

Measured in long casing with inlet bell mouth without guard grille in installation type A air flow impeller/ motor according to ISO 5801

Dimensions inch

Design F
Long casing

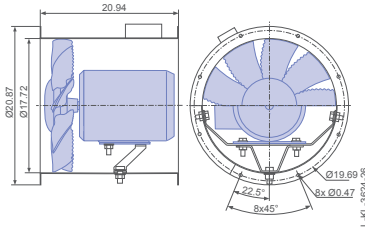

Design K
Short casing (on request)

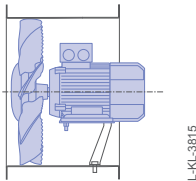

Design S - Short casing
with integrated inlet nozzle (on request)

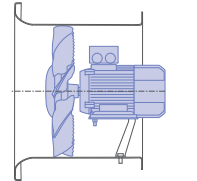

Technical data

Type	Blade setting	Rated power hp	Motor size	Motor technology	Design F Weight lbs	Efficiency	
						η_{statA} %	N_{actual} %
DN45V-2DF.F7.11.G9	11	5	184T	PEM	131.0	44.3	48.9
DN45V-2DF.F7.14.G9	14	5	184T	PEM	131.0	46.5	50.5
DN45V-2DF.F7.19.G9	19	5	184T	PEM	131.0	46.7	49.8
DN45V-2DF.F7.24.G9	24	7.5	184T	PEM	154.1	44.9	46.9



Description

Rated voltage U_N : 3-460 V*
 Rated frequency f_N : 60 Hz*
 Min. permitted ambient temperature $t_{amb(min)}$: -4 °F / -20 °C
 Max. permitted ambient temperature $t_{amb(max)}$: 122 °F / 50 °C
 Number of blades: 9
 Degree of protection : TEFC
 Blade: High Performance Composite Material, Impeller unpainted, black
 Motor: Standard motor NEMA
 * Rated data
 Other versions on request.

Characteristic curve

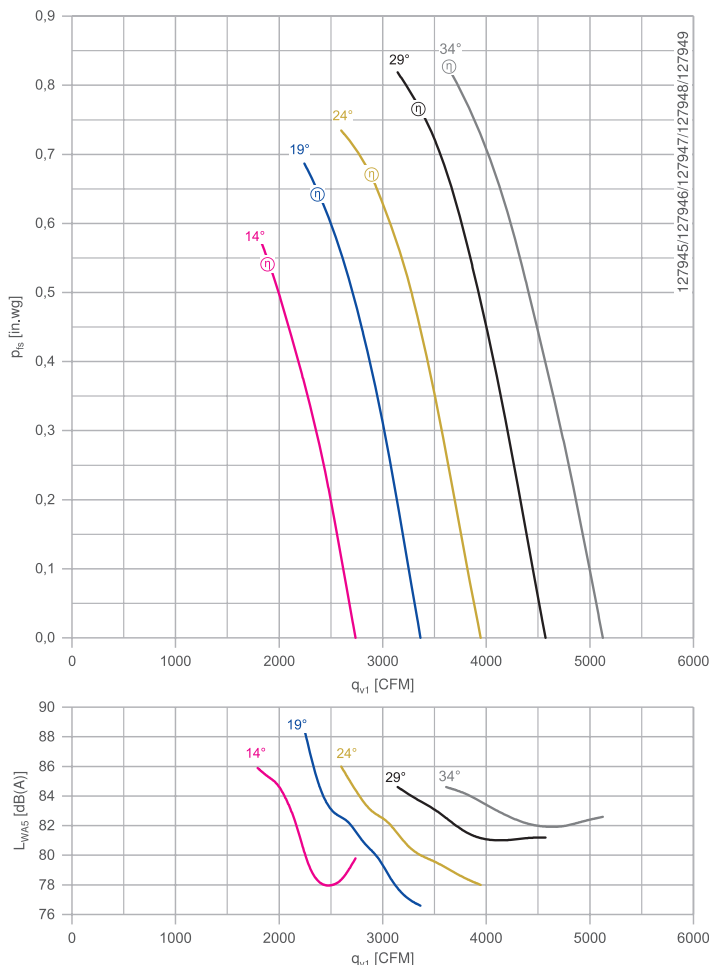

Measured in long casing with inlet bell mouth without guard grille in installation type A air flow impeller/ motor according to ISO 5801

Dimensions inch

Design F
 Long casing

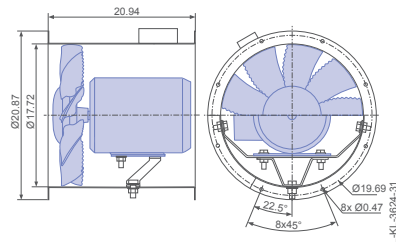

Design K
 Short casing (on request)

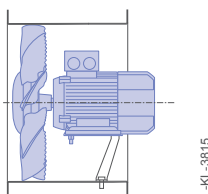

Design S - Short casing
 with integrated inlet nozzle (on request)

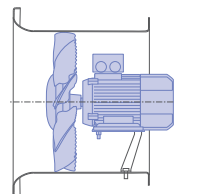

Technical data

Type	Blade setting °	Rated power hp	Motor size	Motor technology	Design F Weight lbs	Efficiency	Efficiency grade
						η_{statA} %	N_{actual} %
DN45V-4DF.B7.14.G9	14	0.5	56	PEM	78.9	41.9	51.5
DN45V-4DF.B7.19.G9	19	0.5	56	PEM	78.9	42.4	51.0
DN45V-4DF.B7.24.G9	24	0.75	56	EEM	76.1	38.1	45.8
DN45V-4DF.B7.29.G9	29	1	56	PEM	86.0	37.9	44.8
DN45V-4DF.D7.34.G9	34	1.5	145T	PEM	90.4	37.3	43.8

www.ziehl-abegg.com



Besoin d'un prix ou d'un conseil technique ?

Ventilateur Ziehl Abegg MAXVENTOWLET DN45V



4,7/5 . +600 avis Google

- Devis rapide et conseil technique par nos spécialistes
- Plus de 200 000 références et 30 marques distribuées
- Vente, réparation, bobinage et SAV en atelier
- Livraison partout en France, accompagnement avant et après-vente

Voir la gamme Ziehl Abegg sur notre site :

www.motralec.com/.../ziehl-abegg

DEMANDER UN PRIX >