

Fiche produit Motralec Ziehl Abegg Maxventowlet DN40V - fiche technique | Motralec

■ **DEMANDE DE PRIX RAPIDE : <https://www.motralec.com/demandeContact>**

MAXventowlet, AC-Technology

Medium Pressure Axial Fans North America

www.motralec.com / service-commercial@motralec.com / 01.39.97.65.10

MAXventowlet

for three phase alternating current, 2 pole

DN40V



Description

- Rated voltage U_N : 3-460 V*
- Rated frequency f_N : 60 Hz*
- Min. permitted ambient temperature $t_{amb(min)}$: -4 °F / -20 °C
- Max. permitted ambient temperature $t_{amb(max)}$: 122 °F / 50 °C
- Number of blades: 9
- Degree of protection : TEFC
- Blade: ZAmid, Impeller unpainted, Blue
- Motor: Standard motor NEMA
- * Rated data
- Other versions on request.

Characteristic curve

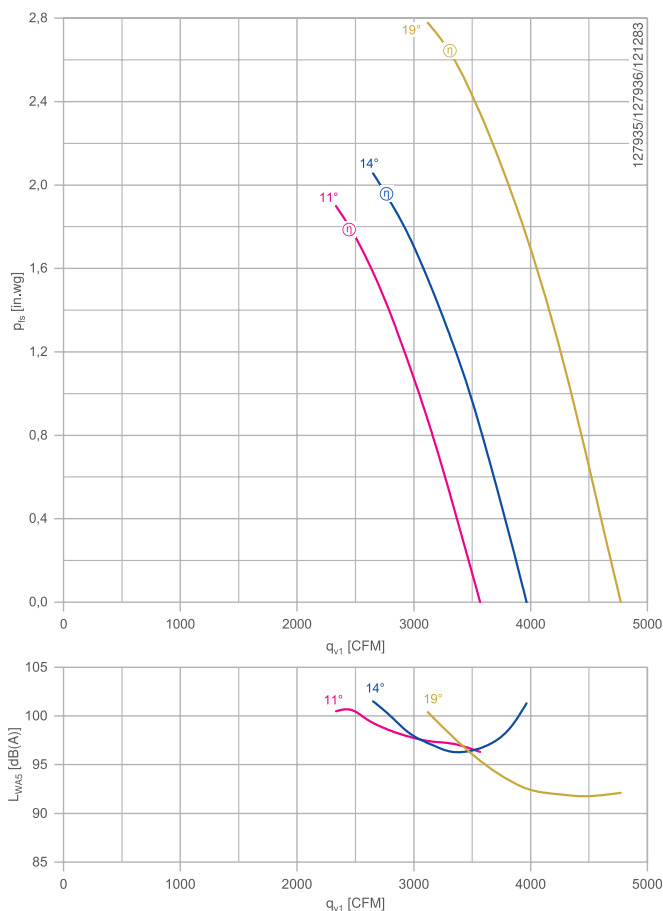

Measured in long casing with inlet bell mouth without guard grille in installation type A air flow impeller/ motor according to ISO 5801

Dimensions inch

Design F
Long casing

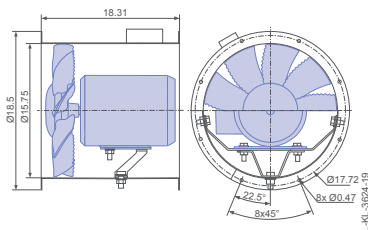

Design K
Short casing (on request)

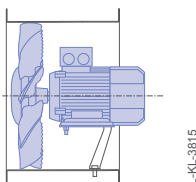

Design S - Short casing
with integrated inlet nozzle (on request)

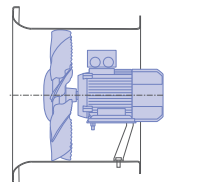

Technical data

Type	Blade setting	Rated power hp	Motor size	Motor technology	Design F	Efficiency	
					Weight lbs	η_{statA} %	N_{actual} %
DN40V-2DF.B7.11.G9	11	2	56	PEM	73.4	44.0	49.8
DN40V-2DF.B7.14.G9	14	2	56	PEM	73.4	41.6	46.7
DN40V-2DF.D7.19.G9	19	3	145T	PEM	88.4	43.2	47.1



Description

Rated voltage U_N : 3-460 V*
 Rated frequency f_N : 60 Hz*
 Min. permitted ambient temperature $t_{amb(min)}$: -4 °F / -20 °C
 Max. permitted ambient temperature $t_{amb(max)}$: 122 °F / 50 °C
 Number of blades: 9
 Degree of protection : TEFC
 Blade: High Performance Composite Material, Impeller unpainted, black
 Motor: Standard motor NEMA
 * Rated data
 Other versions on request.

Characteristic curve

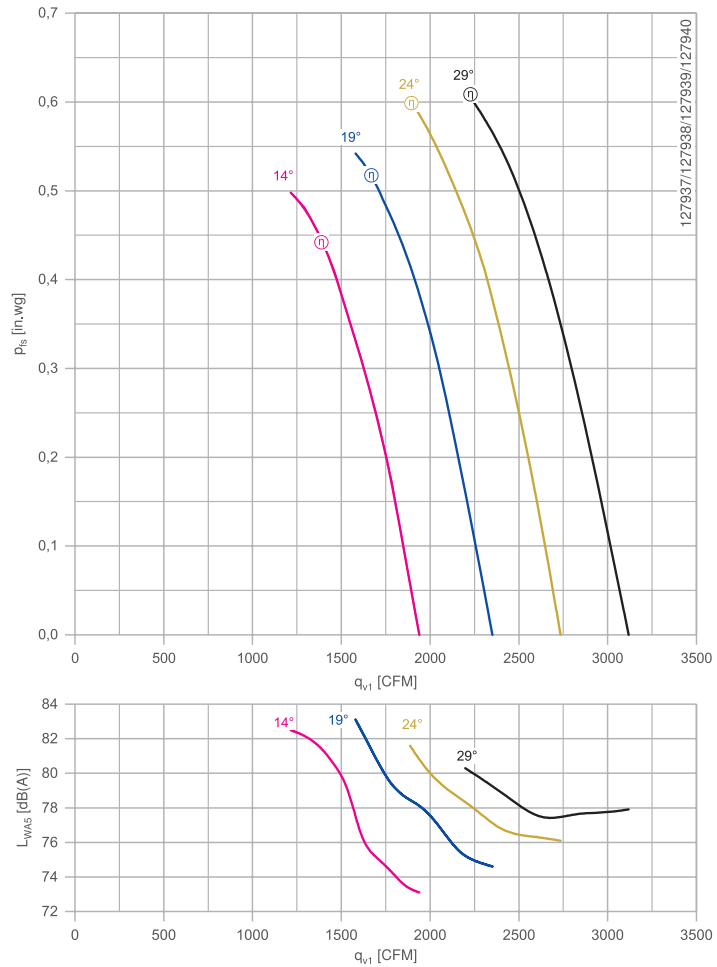

Measured in long casing with inlet bell mouth without guard grille in installation type A air flow impeller/ motor according to ISO 5801

Dimensions inch

Design F
 Long casing

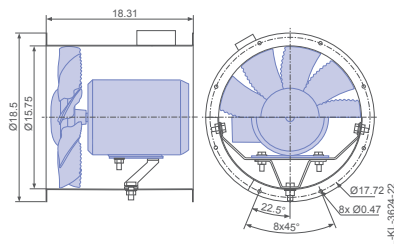

Design K
 Short casing (on request)

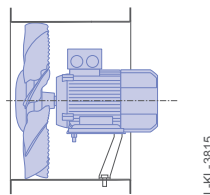

Design S - Short casing
 with integrated inlet nozzle (on request)

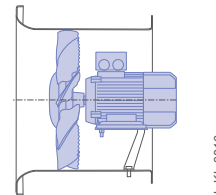

Technical data

Type	Blade setting °	Rated power hp	Motor size	Motor technology	Design F Weight lbs	Efficiency	
						η_{statA} %	N_{actual} %
DN40V-4DF.A7.14.G9	14	0.25	48	EEM	56.0	27.7	37.6
DN40V-4DF.A7.19.G9	19	0.33	48	EEM	57.8	31.1	40.4
DN40V-4DF.B7.24.G9	24	0.5	56	PEM	57.8	36.3	45.3
DN40V-4DF.B7.29.G9	29	0.5	56	PEM	57.8	34.5	42.9

www.ziehl-abegg.com

Besoin d'un prix ou d'un conseil technique ?

Ventilateur Ziehl Abegg MAXVENTOWLET DN40V



4,7/5 . +600 avis Google

- Devis rapide et conseil technique par nos spécialistes
- Plus de 200 000 références et 30 marques distribuées
- Vente, réparation, bobinage et SAV en atelier
- Livraison partout en France, accompagnement avant et après-vente

Voir la gamme Ziehl Abegg sur notre site :

www.motralec.com/.../ziehl-abegg

DEMANDER UN PRIX >