

Fiche produit Motralec Ziehl Abegg Maxventowlet DN31V - fiche technique | Motralec

■ **DEMANDE DE PRIX RAPIDE : <https://www.motralec.com/demandeContact>**

MAXventowlet, AC-Technology

Medium Pressure Axial Fans North America

www.motralec.com / service-commercial@motralec.com / 01.39.97.65.10

MAXventowlet

for three phase alternating current, 2 pole

DN31V

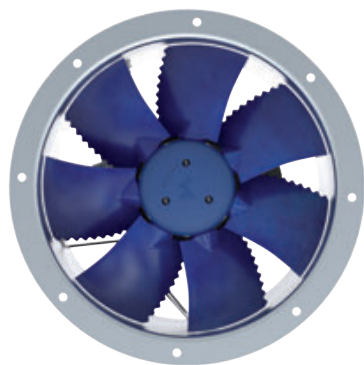

Description

- Rated voltage U_N : 3-460 V*
- Rated frequency f_N : 60 Hz*
- Min. permitted ambient temperature $t_{amb(min)}$: -4 °F / -20 °C
- Max. permitted ambient temperature $t_{amb(max)}$: 122 °F / 50 °C
- Number of blades: 7
- Degree of protection : TEFC
- Blade: ZAmid, Impeller unpainted, Blue
- Motor: Standard motor NEMA
- * Rated data
- Other versions on request.

Characteristic curve

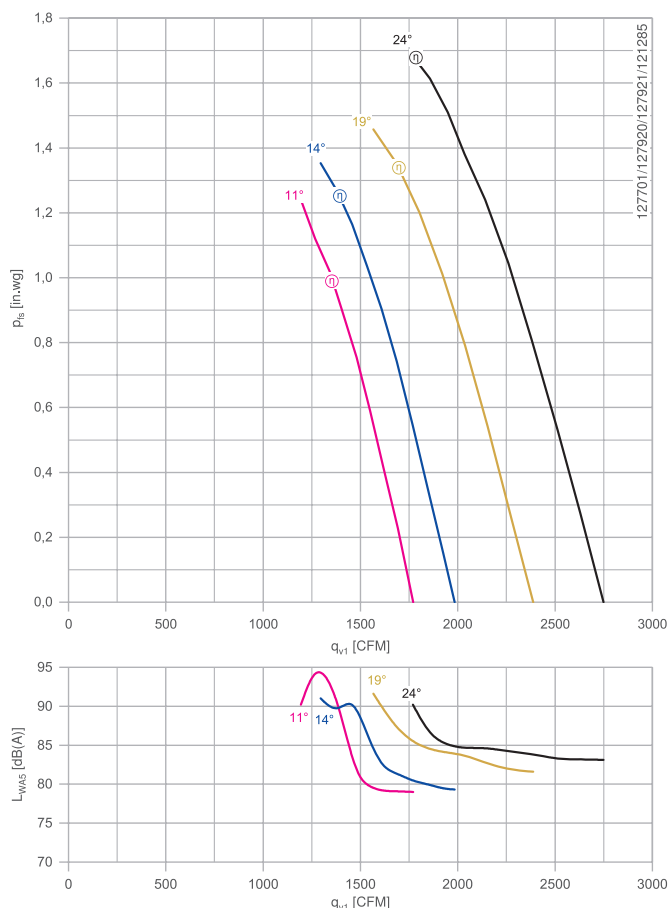

Measured in long casing with inlet bell mouth without guard grille in installation type A air flow impeller/ motor according to ISO 5801

Dimensions inch

Design F
Long casing

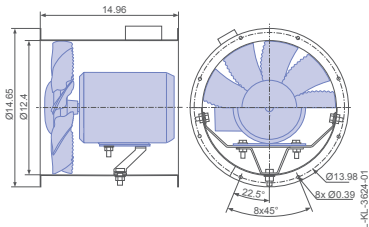

Design K
Short casing (on request)

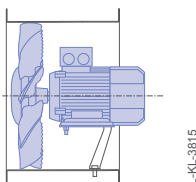

Design S - Short casing
with integrated inlet nozzle (on request)

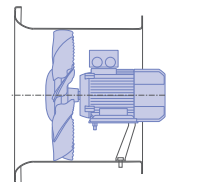

Technical data

Type	Blade setting	Rated power hp	Motor size	Motor technology	Design F Weight lbs	Efficiency	
						η_{statA} %	N_{actual} %
DN31V-2DF.A7.11.G7	11	0.75	48	PEM	44.1	35.2	43.4
DN31V-2DF.A7.14.G7	14	0.75	48	PEM	44.1	36.0	43.8
DN31V-2DF.B7.19.G7	19	1	56	PEM	46.3	36.8	43.9
DN31V-2DF.B7.24.G7	24	1	56	PEM	46.3	35.8	42.2



Description

Rated voltage U_N : 3-460 V*
 Rated frequency f_N : 60 Hz*
 Min. permitted ambient temperature $t_{amb(min)}$: -4 °F / -20 °C
 Max. permitted ambient temperature $t_{amb(max)}$: 122 °F / 50 °C
 Number of blades: 7
 Degree of protection : TEFC
 Blade: High Performance Composite Material, Impeller unpainted, black
 Motor: Standard motor NEMA
 * Rated data
 Other versions on request.

Characteristic curve

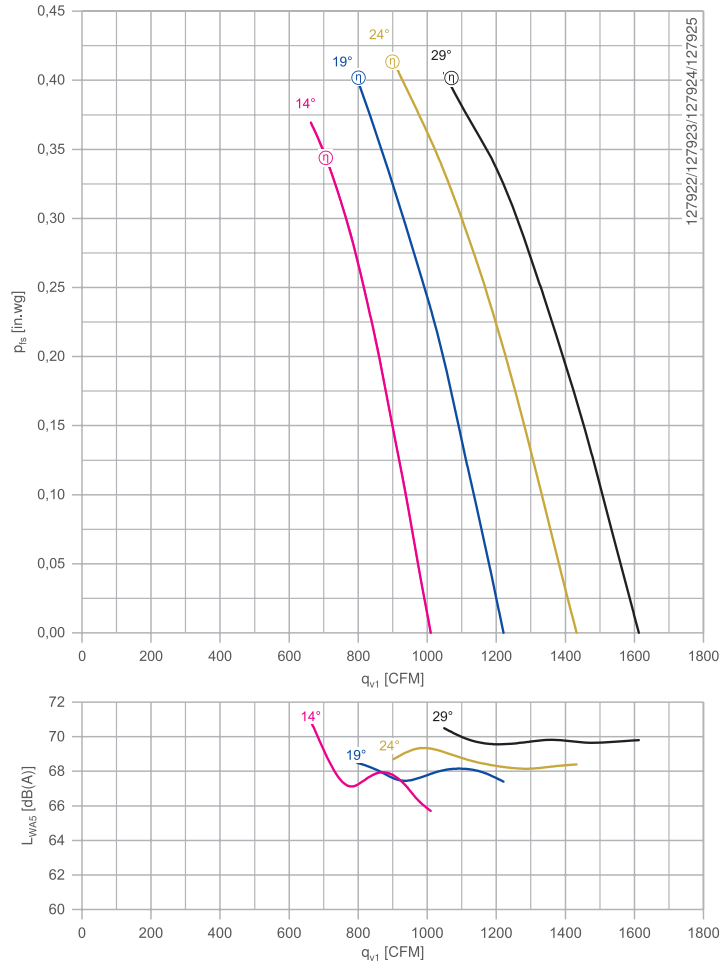

Measured in long casing with inlet bell mouth without guard grille in installation type A air flow impeller/ motor according to ISO 5801

Dimensions inch

Design F
 Long casing

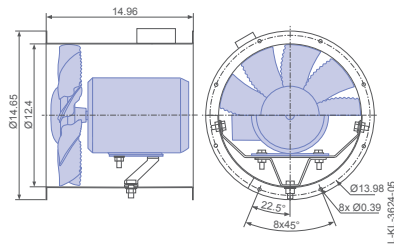

Design K
 Short casing (on request)

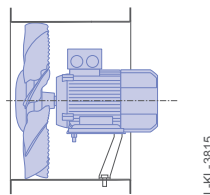

Design S - Short casing
 with integrated inlet nozzle (on request)

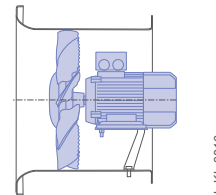

Technical data

Type	Blade setting °	Rated power hp	Motor size	Motor technology	Design F Weight lbs	Efficiency	
						η_{statA} %	N_{actual} %
DN31V-4DF.97.14.G7	14	0.13	42	EEM	38.8	18.7	30.1
DN31V-4DF.97.19.G7	19	0.13	42	EEM	38.8	20.3	31.2
DN31V-4DF.97.24.G7	24	0.17	42	EEM	39.7	27.6	38.9
DN31V-4DF.97.29.G7	29	0.17	42	EEM	39.7	25.6	36.3

Besoin d'un prix ou d'un conseil technique ?

Ventilateur Ziehl Abegg MAXVENTOWLET DN31V



4,7/5 . +600 avis Google

- Devis rapide et conseil technique par nos spécialistes
- Plus de 200 000 références et 30 marques distribuées
- Vente, réparation, bobinage et SAV en atelier
- Livraison partout en France, accompagnement avant et après-vente

Voir la gamme Ziehl Abegg sur notre site :

www.motralec.com/.../ziehl-abegg

DEMANDER UN PRIX >