

Fiche produit Motralec Ziehl Abegg M Series RH45M 4D - fiche technique | Motralec

■ **DEMANDE DE PRIX RAPIDE** : <https://www.motralec.com/demandeContact>

M-series AC technology
Size 450

Fans for railroad engineering
01/2017

M-series

for three phase alternating current, 4 pole

RH45M-4D



Description

Motor technology: AC
 Rated voltage U_N :
3- 230/400 V (Δ/Y) | 3-230/400 V (Δ/Y) | 3-265/460 V (Δ/Y) *
 Rated frequency f_N : **50 Hz | 60 Hz | 60 Hz***
 Input power P_i :
820 W | 1.25 kW | 1.35 kW*
 Rated current I_N :
3.20/1.85 A | 3.80/2.20 A | 3.80/2.20 A*
 Rated speed n_N :
1410 min⁻¹ | 1600 min⁻¹ | 1650 min⁻¹*
 Starting current I_A : **16.00/9,50 A | 15,00/8,50 A | 17,00/10,00 A**
 Current increase ΔI : **10 % | 15 % | 15 %**
 Thermal class: THCL155*
 Min. permitted ambient temperature $t_{R(min)}$: **-40 °C*****
 Max. permitted ambient temperature $t_{R(max)}$:
70 °C | 40 °C | 40 °C
 Electrical connection: Supply cable side, 105cm
 Degree of protection : IP54
 Motor protection: thermal contact
 Impeller : aluminium, unpainted
 Motor: Aluminium, 1 coat paint, pebble grey
 Conformity: CE
 * Rated data
 *** Continuous operation with occasional starts (S1) according to DIN EN 60034-1:2011-02. Occasional starting between -40 °C and -25 °C is permissible. Continuous operation below -25 °C only with special bearings for refrigeration applications on request.

Characteristic curve

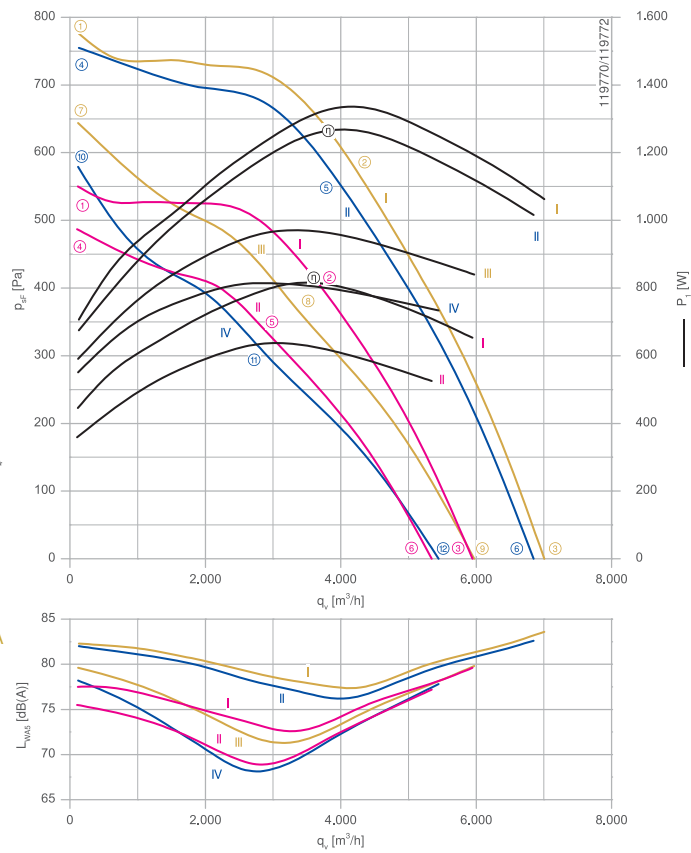

Measured with inlet ring, without guard grille according to ISO 5801

Inlet ring	00400383	RAL 7032	Page 303
		(pebble grey)	
Inlet ring	00275571	unpainted	
Connection diagram	1360-106XA		Page 327

Dimensions mm

Free-running motorized impeller RH
in installation position H/Vu

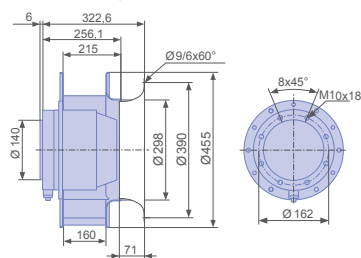

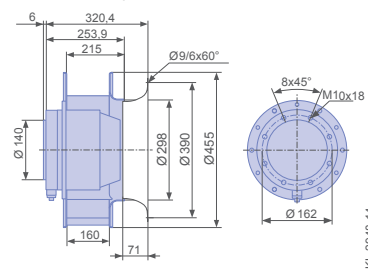

Free-running motorized impeller RH
in installation position H/Vo



Type	Characteristic curve	Voltage	Frequency	Operating point	Current	Input power	Speed	Suction side sound power level
		U V	f Hz		I A	P _i W	n min ⁻¹	L _{WAS} dB(A)
RH45M-4DK.6F.1R	I	400	50	①	1.50	440	1460	78
		400*		②	1.85*	820*	1410*	73
		400		③	1.70	660	1430	80
		230		④	1.10	360	1370	76
		230		⑤	1.85	640	1230	69
		230		⑥	1.55	520	1290	77
	II	460	60	①	1.50	700	1730	82
		460*		②	2.20*	1350*	1650*	77
		460		③	1.85	1050	1690	84
		400		④	1.40	680	1710	82
		400*		⑤	2.20*	1250*	1600*	76
		400		⑥	1.85	1000	1650	83
III	265		⑦	1.55	600	1580	80	
	265		⑧	2.60	980	1330	71	
	265		⑨	2.20	840	1440	80	
IV	230		⑩	1.65	560	1500	78	
	230		⑪	2.60	820	1190	68	
	230		⑫	2.30	740	1310	78	

*rated data

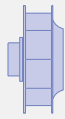
Fan ordering information

Design	RH*	RH*
Installation position	H/Vu	H/Vo
		
Type	RH45M-4DK.6F.1R	RH45M-4DK.6F.1R
Article no.	172151	175238
Weight kg	16.00	16.00
* inlet ring not included		

Information

ZArail

Cpro-ECblue

C-ECblue

C series

N series

M series

FE2owlet

www.motralec.com / service-commercial@motralec.com / 01.39.97.65.10  237

Fiche produit Motralec Ziehl Abegg M Series RH45M 4D - fiche technique | Motralec

■ **DEMANDE DE PRIX RAPIDE** : <https://www.motralec.com/demandeContact>

Besoin d'un prix ou d'un conseil technique ?

Ventilateur Ziehl Abegg M SERIES RH45M 4D



4,7/5 . +600 avis Google

- Devis rapide et conseil technique par nos spécialistes
- Plus de 200 000 références et 30 marques distribuées
- Vente, réparation, bobinage et SAV en atelier
- Livraison partout en France, accompagnement avant et après-vente

Voir la gamme Ziehl Abegg sur notre site :

www.motralec.com/.../ziehl-abegg

DEMANDER UN PRIX >