

Fiche produit Motralec Ziehl Abegg M Series RH40M 4D - fiche technique | Motralec

■ **DEMANDE DE PRIX RAPIDE** : <https://www.motralec.com/demandeContact>

M-series AC technology  
Size 400

Fans for railroad engineering  
01/2017

# M-series

for three phase alternating current, 4 pole

RH40M-4D



### Description

Motor technology: AC  
 Rated voltage  $U_N$ :  
**3- 230/400 V ( $\Delta/Y$ ) | 3-230/400 V ( $\Delta/Y$ ) | 3-265/460 V ( $\Delta/Y$ ) \***  
 Rated frequency  $f_N$ : **50 Hz | 60 Hz | 60 Hz\***  
 Input power  $P_i$ :  
**420 W | 600 W | 660 W\***  
 Rated current  $I_N$ :  
**1.80/1.05 A | 2.00/1.15 A | 2.10/1.20 A\***  
 Rated speed  $n_N$ :  
**1350 min<sup>-1</sup> | 1510 min<sup>-1</sup> | 1570 min<sup>-1</sup>\***  
 Starting current  $I_A$ : **7.50/4.20 A | 7.00/4.00 A | 8.00/4.60 A**  
 Current increase  $\Delta I$ : **0 % | 0 % | 0 %**  
 Thermal class: THCL155\*  
 Min. permitted ambient temperature  $t_{R(min)}$ : **-40 °C\*\*\***  
 Max. permitted ambient temperature  $t_{R(max)}$ :  
**70 °C | 70 °C | 70 °C**  
 Electrical connection: Supply cable side, 105cm  
 Degree of protection : IP54  
 Motor protection: thermal contact  
 Impeller : aluminium, unpainted  
 Motor: Aluminium, 1 coat paint, pebble grey  
 Conformity: CE  
 \* Rated data  
 \*\*\* Continuous operation with occasional starts (S1) according to DIN EN 60034-1:2011-02. Occasional starting between -40 °C and -25 °C is permissible. Continuous operation below -25 °C only with special bearings for refrigeration applications on request.

### Characteristic curve

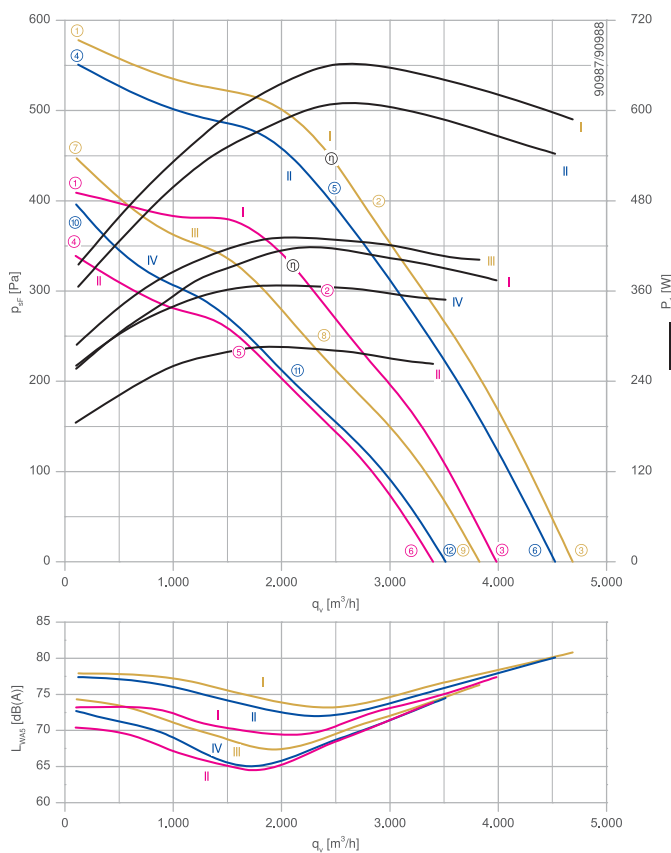

Measured with inlet ring, without guard grille according to ISO 5801

Inlet ring	00279265	RAL 7032 (pebble grey)	Page 303
Inlet ring	00275570	unpainted	
Connection diagram	1360-106XA		Page 327

### Dimensions mm

Free-running motorized impeller RH  
in installation position H/Vu

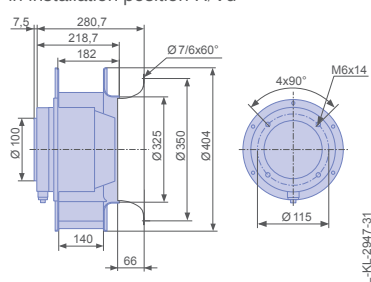

Free-running motorized impeller RH  
in installation position H/Vo

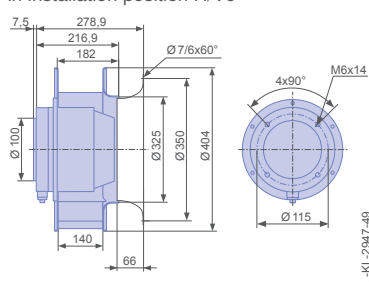

Type	Characteristic curve	Voltage	Frequency	Operating point	Current	Input power	Speed	Suction side sound power level
		U V	f Hz		I A	P <sub>i</sub> W	n min <sup>-1</sup>	L <sub>WAS</sub> dB(A)
RH40M-4DK.4I.1R	I	400	50	①	0.94	260	1420	73
		400*		②	1.05*	420*	1350*	70
		400		③	1.00	370	1360	77
		230		④	0.64	180	1280	70
		230		⑤	0.88	290	1130	65
		230		⑥	0.82	260	1170	74
	II	460	60	①	0.94	400	1680	78
		460*		②	1.20*	660*	1570*	74
		460		③	1.10	580	1600	81
		400		④	0.86	370	1650	77
		400*		⑤	1.15*	600*	1510*	72
		400		⑥	1.05	540	1540	80
III	265		⑦	0.78	290	1470	74	
	265		⑧	1.10	440	1260	68	
	265		⑨	1.05	400	1310	76	
IV	230		⑩	0.80	260	1400	73	
	230		⑪	1.10	370	1150	66	
	230		⑫	1.05	350	1210	75	

\*rated data

### Fan ordering information

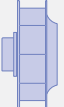
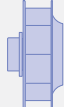
Design	RH*	RH*
Installation position	H/Vu	H/Vo
		
<b>Type</b>	<b>RH40M-4DK.4I.1R</b>	<b>RH40M-4DK.4I.1R</b>
<b>Article no.</b>	<b>172150</b>	<b>175237</b>
Weight kg	9.70	9.70
* inlet ring not included		

Information

ZArail

Cpro-ECblue

C-ECblue

C series

N series

M series

FE2owllet

[www.motralec.com](http://www.motralec.com) / [service-commercial@motralec.com](mailto:service-commercial@motralec.com) / 01.39.97.65.10 235

Fiche produit Motralec Ziehl Abegg M Series RH40M 4D - fiche technique | Motralec

■ **DEMANDE DE PRIX RAPIDE** : <https://www.motralec.com/demandeContact>

## Besoin d'un prix ou d'un conseil technique ?

Ventilateur Ziehl Abegg M SERIES RH40M 4D



4,7/5 . +600 avis Google

- Devis rapide et conseil technique par nos spécialistes
- Plus de 200 000 références et 30 marques distribuées
- Vente, réparation, bobinage et SAV en atelier
- Livraison partout en France, accompagnement avant et après-vente

Voir la gamme Ziehl Abegg sur notre site :

[www.motralec.com/.../ziehl-abegg](http://www.motralec.com/.../ziehl-abegg)

**DEMANDER UN PRIX >**