

Fiche produit Motralec Ziehl Abegg M Series RH35M 4D - fiche technique | Motralec

■ **DEMANDE DE PRIX RAPIDE** : <https://www.motralec.com/demandeContact>

M-series AC technology  
Size 355

Fans for railroad engineering  
01/2017

# M-series

for three phase alternating current, 4 pole

RH35M-4D



### Description

Motor technology: AC  
 Rated voltage  $U_N$ :  
**3- 230/400 V ( $\Delta/Y$ ) | 3~230/400 V ( $\Delta/Y$ ) | 3~265/460 V ( $\Delta/Y$ ) \***  
 Rated frequency  $f_N$ : **50 Hz | 60 Hz | 60 Hz\***  
 Input power  $P_i$ :  
**290 W | 420 W | 460 W\***  
 Rated current  $I_N$ :  
**1.20/0.68 A | 1.30/0.76 A | 1.35/0.78 A\***  
 Rated speed  $n_N$ :  
**1360 min<sup>-1</sup> | 1520 min<sup>-1</sup> | 1590 min<sup>-1</sup>\***  
 Starting current  $I_A$ : **4.00/2.40 A | 3.60/2.20 A | 4.40/2.40 A**  
 Current increase  $\Delta I$ : **0 % | 5 % | 0 %**  
 Thermal class: THCL155\*  
 Min. permitted ambient temperature  $t_{R(min)}$ : **-40 °C\*\*\***  
 Max. permitted ambient temperature  $t_{R(max)}$ :  
**80 °C | 70 °C | 70 °C**  
 Electrical connection: Supply cable side, 105cm  
 Degree of protection : IP54  
 Motor protection: thermal contact  
 Impeller : aluminium, unpainted  
 Motor: Aluminium, 1 coat paint, pebble grey  
 Conformity: CE  
 \* Rated data  
 \*\*\* Continuous operation with occasional starts (S1) according to DIN EN 60034-1:2011-02. Occasional starting between -40 °C and -25 °C is permissible. Continuous operation below -25 °C only with special bearings for refrigeration applications on request.

Characteristic curve

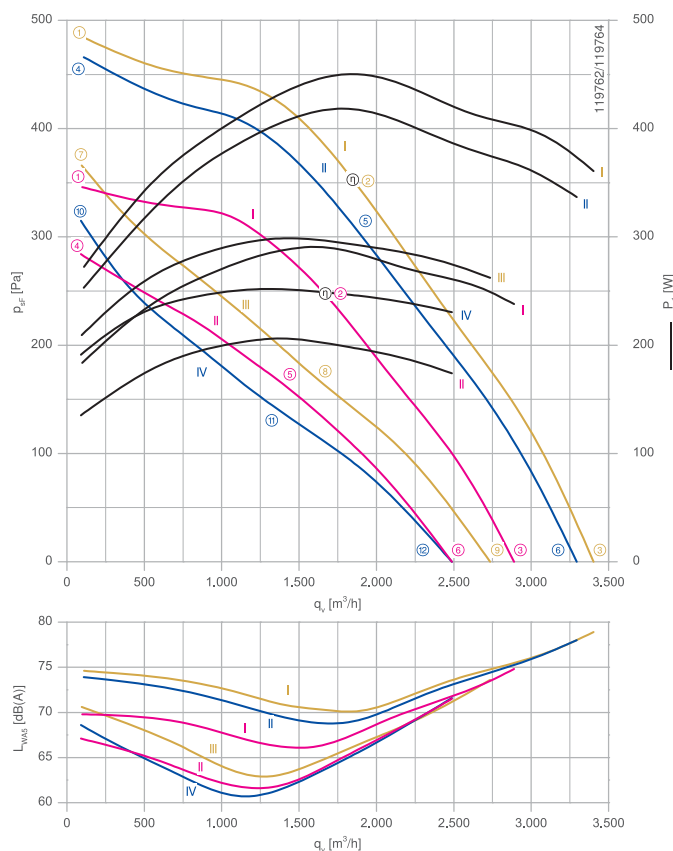

Measured with inlet ring, without guard grille according to ISO 5801

Inlet ring	00402617	RAL 7032	Page 303
		(pebble grey)	
Inlet ring	00275850	unpainted	
Connection diagram	1360-106XA		Page 327

### Dimensions mm

Free-running motorized impeller RH in installation position H/Vu

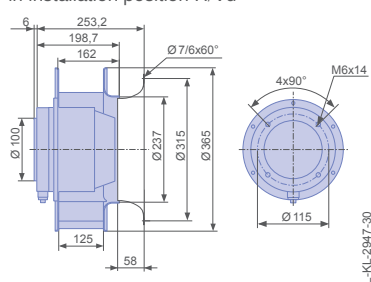

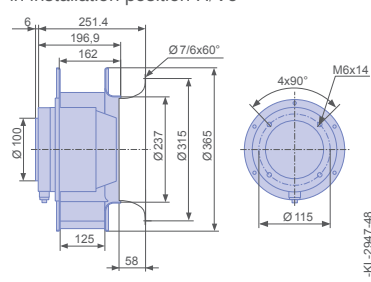

Free-running motorized impeller RH in installation position H/Vo



Type	Characteristic curve	Voltage	Frequency	Operating point	Current	Input power	Speed	Suction side sound power level	
		U V	f Hz		I A	P <sub>i</sub> W	n min <sup>-1</sup>	L <sub>WAS</sub> dB(A)	
RH35M-4DK.4C.1R	I	400	50	①	0.60	180	1420	70	
		400*		②	0.68*	290*	1360*	66	
		400		③	0.66	240	1400	75	
		230		④	0.44	140	1290	67	
		230		⑤	0.62	210	1130	62	
		230		⑥	0.52	170	1210	72	
	II	I	460	60	①	0.60	270	1690	75
			460*		②	0.78*	460*	1590*	70
			460		③	0.68	360	1640	79
		II	400		④	0.54	250	1660	74
			400*		⑤	0.76*	420*	1520*	69
			400		⑥	0.64	340	1590	78
III	265	⑦	0.56	210	1460	71			
	265	⑧	0.78	300	1200	64			
	265	⑨	0.68	260	1320	74			
IV	230	⑩	0.58	190	1360	69			
	230	⑪	0.78	250	1070	62			
	230	⑫	0.70	230	1210	72			

\*rated data

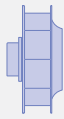
### Fan ordering information

Design	RH*	RH*
Installation position	H/Vu	H/Vo
		
<b>Type</b>	<b>RH35M-4DK.4C.1R</b>	<b>RH35M-4DK.4C.1R</b>
<b>Article no.</b>	<b>172149</b>	<b>175236</b>
Weight kg	6.30	6.30
* inlet ring not included		

Information

ZArail

Cpro-ECblue

C-ECblue

C series

N series

M series

FE2owllet

[www.motralec.com](http://www.motralec.com) / [service-commercial@motralec.com](mailto:service-commercial@motralec.com) / 01.39.97.65.10 233

Fiche produit Motralec Ziehl Abegg M Series RH35M 4D - fiche technique | Motralec

■ **DEMANDE DE PRIX RAPIDE** : <https://www.motralec.com/demandeContact>

## Besoin d'un prix ou d'un conseil technique ?

Ventilateur Ziehl Abegg M SERIES RH35M 4D



4,7/5 . +600 avis Google

- Devis rapide et conseil technique par nos spécialistes
- Plus de 200 000 références et 30 marques distribuées
- Vente, réparation, bobinage et SAV en atelier
- Livraison partout en France, accompagnement avant et après-vente

Voir la gamme Ziehl Abegg sur notre site :

[www.motralec.com/.../ziehl-abegg](http://www.motralec.com/.../ziehl-abegg)

**DEMANDER UN PRIX >**