

Fiche produit Motralec Ziehl Abegg M Series RH31M 4D - fiche technique | Motralec

■ **DEMANDE DE PRIX RAPIDE** : <https://www.motralec.com/demandeContact>

M-series AC technology
Size 315

Fans for railroad engineering
01/2017

M-series

for three phase alternating current, 4 pole

RH31M-4D



Description

Motor technology: AC
 Rated voltage U_N :
3- 230/400 V (Δ/Y) | 3~230/400 V (Δ/Y) | 3~265/460 V (Δ/Y) *
 Rated frequency f_N : **50 Hz | 60 Hz | 60 Hz***
 Input power P_i :
150 W | 220 W | 230 W*
 Rated current I_N :
0.62/0.36 A | 0.66/0.38 A | 0.68/0.39 A*
 Rated speed n_N :
1370 min⁻¹ | 1540 min⁻¹ | 1600 min⁻¹*
 Starting current I_A : **2.20/1.20 A | 2.00/1.20 A | 2.40/1.40 A**
 Current increase ΔI : **0 % | 5 % | 0 %**
 Thermal class: THCL155°
 Min. permitted ambient temperature $t_{R(min)}$: **-40 °C*****
 Max. permitted ambient temperature $t_{R(max)}$:
70 °C | 70 °C | 70 °C
 Electrical connection: Supply cable side, 105cm
 Degree of protection : IP54Z
 Motor protection: thermal contact
 Impeller : aluminium, unpainted
 Motor: Aluminium, 1 coat paint, pebble grey
 Conformity: CE
 * Rated data
 *** Continuous operation with occasional starts (S1) according to DIN EN 60034-1:2011-02. Occasional starting between -40 °C and -25 °C is permissible. Continuous operation below -25 °C only with special bearings for refrigeration applications on request.

Characteristic curve

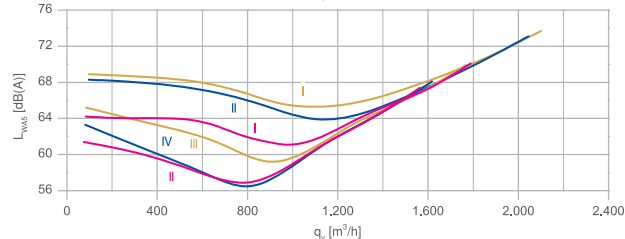
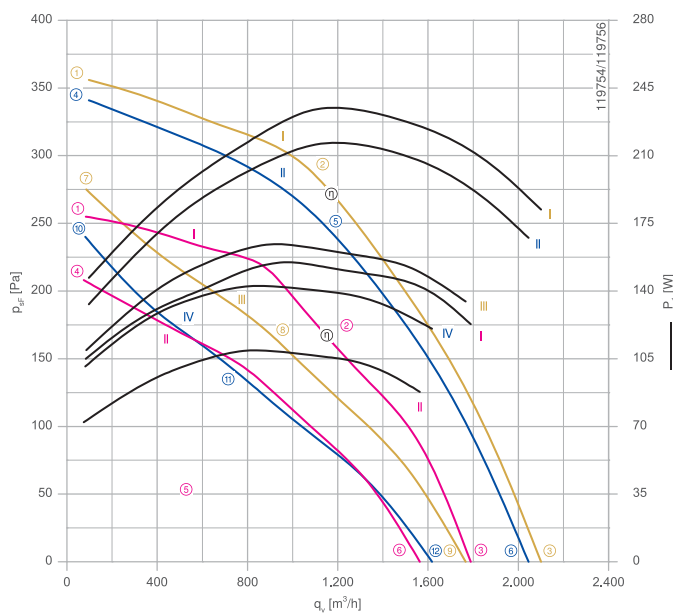

Measured with inlet ring, without guard grille according to ISO 5801

Inlet ring	00400327	RAL 7032	Page 303
		(pebble grey)	
Inlet ring	00279152	unpainted	
Connection diagram	1360-106XA		Page 327

Dimensions mm

Free-running motorized impeller RH in installation position H/Vu

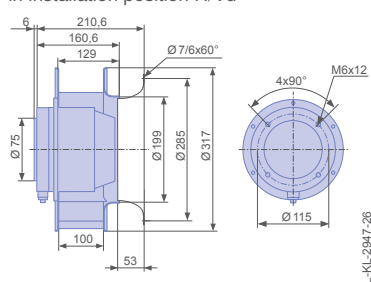

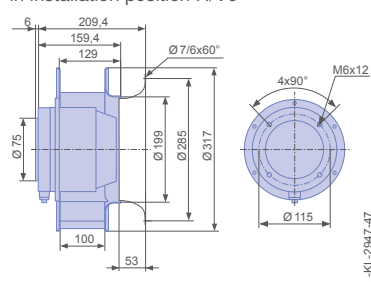

Free-running motorized impeller RH in installation position H/Vo



Type	Characteristic curve	Voltage	Frequency	Operating point	Current	Input power	Speed	Suction side sound power level
		U V	f Hz		I A	P _i W	n min ⁻¹	L _{WAS} dB(A)
RH31M-4DK.2C.1R	I	400	50	①	0.33	110	1430	64
		400*		②	0.36*	150*	1370*	61
		400		③	0.34	120	1410	70
		230		④	0.23	70	1290	61
		230		⑤	0.31	110	1140	57
		230		⑥	0.26	90	1230	67
	II	460	60	①	0.32	150	1690	69
		460*		②	0.39*	230*	1600*	65
		460		③	0.35	180	1650	74
		400		④	0.29	130	1650	68
		400*		⑤	0.38*	220*	1540*	64
		400		⑥	0.32	170	1610	73
III	265		⑦	0.28	110	1490	65	
	265		⑧	0.39	160	1250	59	
	265		⑨	0.33	130	1390	70	
IV	230		⑩	0.28	100	1380	63	
	230		⑪	0.39	140	1120	57	
	230		⑫	0.33	120	1280	68	

*rated data

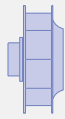
Fan ordering information

Design	RH*	RH*
Installation position	H/Vu	H/Vo
		
Type	RH31M-4DK.2C.1R	RH31M-4DK.2C.1R
Article no.	172146	175233
Weight kg	4.00	4.00
* inlet ring not included		

Information

ZArail

Cpro-ECblue

C-ECblue

C series

N series

M series

FE2owlet

www.motralec.com / service-commercial@motralec.com / 01.39.97.65.10  227

Fiche produit Motralec Ziehl Abegg M Series RH31M 4D - fiche technique | Motralec

■ **DEMANDE DE PRIX RAPIDE** : <https://www.motralec.com/demandeContact>

Besoin d'un prix ou d'un conseil technique ?

Ventilateur Ziehl Abegg M SERIES RH31M 4D



4,7/5 . +600 avis Google

- Devis rapide et conseil technique par nos spécialistes
- Plus de 200 000 références et 30 marques distribuées
- Vente, réparation, bobinage et SAV en atelier
- Livraison partout en France, accompagnement avant et après-vente

Voir la gamme Ziehl Abegg sur notre site :

www.motralec.com/.../ziehl-abegg

DEMANDER UN PRIX >