

Fiche produit Motralec Ziehl Abegg M Series RH31M 2D - fiche technique | Motralec

■ **DEMANDE DE PRIX RAPIDE** : <https://www.motralec.com/demandeContact>

M-series AC technology
Size 315

Fans for railroad engineering
01/2017

M-series

for three phase alternating current, 2 pole

RH31M-2D



Description

Motor technology: AC
 Rated voltage U_N :
3- 230/400 V (Δ/Y) | 3~230/400 V (Δ/Y) | 3~265/460 V (Δ/Y) *
 Rated frequency f_N : **50 Hz | 60 Hz | 60 Hz***
 Input power P_i :
680 W | 1.05 kW | 1.10 kW*
 Rated current I_N :
2.30/1.30 A | 2.90/1.70 A | 2.80/1.60 A*
 Rated speed n_N :
2830 min⁻¹ | 3210 min⁻¹ | 3300 min⁻¹*
 Starting current I_A : **13,00/7,50 A | 12,00/7,00 A | 14,00/8,00 A**
 Current increase ΔI : **20 % | 20 % | 30 %**
 Thermal class: THCL155*
 Min. permitted ambient temperature $t_{R(min)}$: **-40 °C*****
 Max. permitted ambient temperature $t_{R(max)}$:
70 °C | 40 °C | 40 °C
 Electrical connection: Supply cable side, 105cm
 Degree of protection : IP54
 Motor protection: thermal contact
 Impeller : aluminium, unpainted
 Motor: Aluminium, 1 coat paint, pebble grey
 Conformity: CE
 * Rated data
 *** Continuous operation with occasional starts (S1) according to DIN EN 60034-1:2011-02. Occasional starting between -40 °C and -25 °C is permissible. Continuous operation below -25 °C only with special bearings for refrigeration applications on request.

Characteristic curve

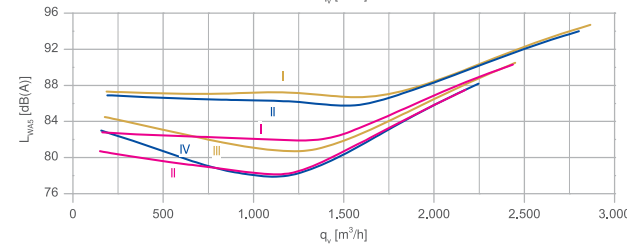
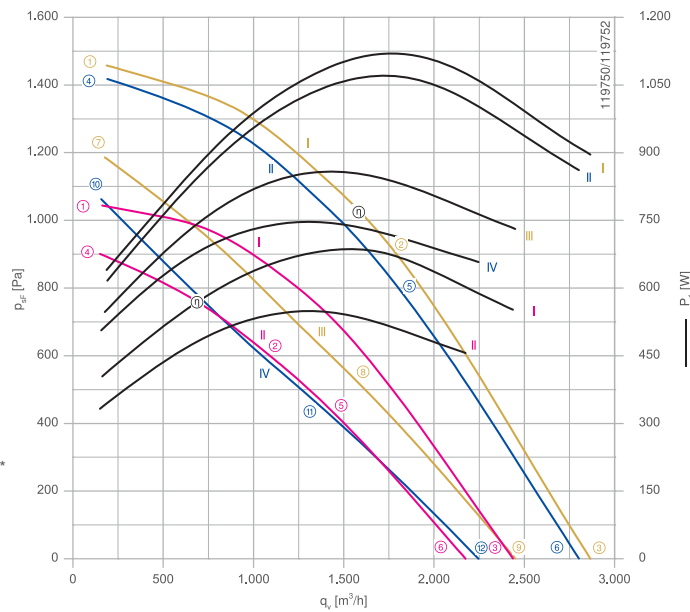

Measured with inlet ring, without guard grille according to ISO 5801

Inlet ring	00400327	RAL 7032 (pebble grey)	Page 303
Inlet ring	00279152	unpainted	
Connection diagram	1360-106XA		Page 327

Dimensions mm

Free-running motorized impeller RH in installation position H/Vu

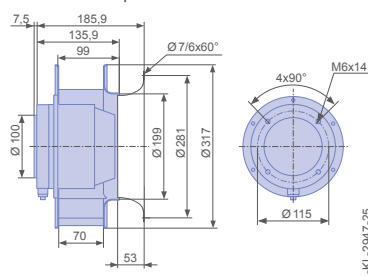

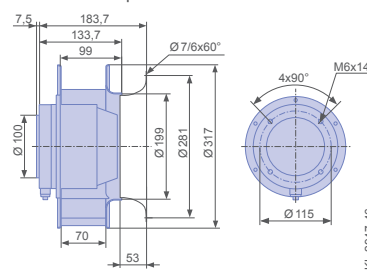

Free-running motorized impeller RH in installation position H/Vo



Type	Characteristic curve	Voltage	Frequency	Operating point	Current	Input power	Speed	Suction side sound power level
		U V	f Hz		I A	P _i W	n min ⁻¹	L _{WAS} dB(A)
RH31M-2DK.3I.2R	I	400	50	①	1.00	400	2910	83
		400*		②	1.30*	680*	2830*	83
		400		③	1.15	560	2860	90
		230		④	0.92	330	2710	81
		230		⑤	1.50	540	2450	80
		230		⑥	1.25	460	2570	88
	II	460	60	①	1.10	640	3450	87
		460*		②	1.60*	1100*	3300*	87
		460		③	1.35	900	3370	95
		400		④	1.05	620	3400	87
		400*		⑤	1.70*	1050*	3210*	87
		400		⑥	1.40	860	3300	94
III	265		⑦	1.30	540	3110	85	
	265		⑧	2.00	860	2690	82	
	265		⑨	1.70	740	2900	91	
IV	230		⑩	1.35	500	2950	83	
	230		⑪	2.00	740	2430	79	
	230		⑫	1.80	660	2660	88	

*rated data

Fan ordering information

Design	RH*	RH*
Installation position	H/Vu	H/Vo
		
Type	RH31M-2DK.3I.2R	RH31M-2DK.3I.2R
Article no.	172145	175232
Weight kg	9.10	9.10
* inlet ring not included		

Information

ZArail

Cpro-ECblue

C-ECblue

C series

N series

M series

FE2owlet

www.motralec.com / service-commercial@motralec.com / 01.39.97.65.10  225

Fiche produit Motralec Ziehl Abegg M Series RH31M 2D - fiche technique | Motralec

■ **DEMANDE DE PRIX RAPIDE** : <https://www.motralec.com/demandeContact>

Besoin d'un prix ou d'un conseil technique ?

Ventilateur Ziehl Abegg M SERIES RH31M 2D



4,7/5 . +600 avis Google

- Devis rapide et conseil technique par nos spécialistes
- Plus de 200 000 références et 30 marques distribuées
- Vente, réparation, bobinage et SAV en atelier
- Livraison partout en France, accompagnement avant et après-vente

Voir la gamme Ziehl Abegg sur notre site :

www.motralec.com/.../ziehl-abegg

DEMANDER UN PRIX >