

Fiche produit Motralec Ziehl Abegg M Series RH25M 2D - fiche technique | Motralec

■ **DEMANDE DE PRIX RAPIDE** : <https://www.motralec.com/demandeContact>

M-series AC technology
Size 250

Fans for railroad engineering
01/2017

M-series

for three phase alternating current, 2 pole

RH25M-2D



Description

Motor technology: AC
 Rated voltage U_N :
3- 230/400 V (Δ/Y) | 3~230/400 V (Δ/Y) | 3~265/460 V (Δ/Y) *
 Rated frequency f_N : **50 Hz | 60 Hz | 60 Hz***
 Input power P_i :
330 W | 520 W | 540 W*
 Rated current I_N :
1.25/0.72 A | 1.50/0.86 A | 1.45/0.84 A*
 Rated speed n_N :
2850 min⁻¹ | 3300 min⁻¹ | 3380 min⁻¹*
 Starting current I_A : **7.50/4.40 A | 7.00/4.20 A | 8.50/4.80 A**
 Current increase ΔI : **20 % | 30 % | 30 %**
 Thermal class: THCL155*
 Min. permitted ambient temperature $t_{R(min)}$: **-40 °C*****
 Max. permitted ambient temperature $t_{R(max)}$:
70 °C | 70 °C | 70 °C
 Electrical connection: Supply cable side, 105cm
 Degree of protection : IP54
 Motor protection: thermal contact
 Impeller : aluminium, unpainted
 Motor: Aluminium, 1 coat paint, pebble grey
 Conformity: CE
 * Rated data
 *** Continuous operation with occasional starts (S1) according to DIN EN 60034-1:2011-02. Occasional starting between -40 °C and -25 °C is permissible. Continuous operation below -25 °C only with special bearings for refrigeration applications on request.

Characteristic curve

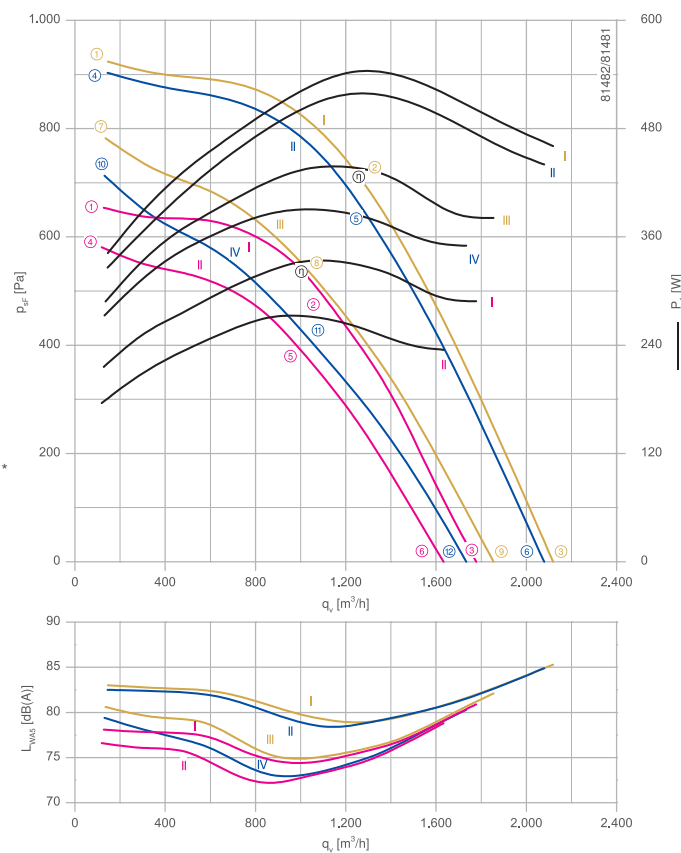

Measured with inlet ring, without guard grille according to ISO 5801

Inlet ring	00401735	RAL 7032	Page 303
		(pebble grey)	
Inlet ring	00275847	unpainted	
Connection diagram	1360-106XA		Page 327

Dimensions mm

Free-running motorized impeller RH in installation position H/Vu

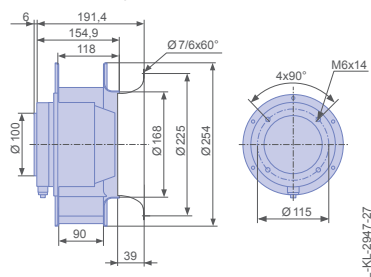

Free-running motorized impeller RH in installation position H/Vo

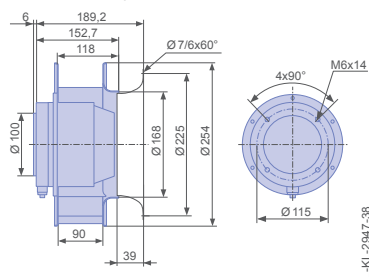

Type	Characteristic curve	Voltage	Frequency	Operating point	Current	Input power	Speed	Suction side sound power level
		U V	f Hz		I A	P _i W	n min ⁻¹	L _{WAS} dB(A)
RH25M-2DK.3F.1R	I	400	50	①	0.62	220	2910	78
		400*		②	0.72*	330*	2850*	75
		400		③	0.66	290	2880	81
		230		④	0.50	180	2750	77
		230		⑤	0.76	270	2570	73
		230		⑥	0.66	230	2650	79
	II	460	60	①	0.64	340	3470	83
		460*		②	0.84*	540*	3380*	79
		460		③	0.76	460	3410	85
		400		④	0.60	330	3430	83
		400*		⑤	0.86*	520*	3300*	79
		400		⑥	0.76	440	3350	85
III	265		⑦	0.70	290	3190	81	
	265		⑧	1.05	440	2880	75	
	265		⑨	0.92	380	3010	82	
IV	230		⑩	0.74	270	3050	79	
	230		⑪	1.10	390	2650	73	
	230		⑫	0.96	350	2820	80	

*rated data

Fan ordering information

Design	RH*	RH*
Installation position	H/Vu	H/Vo
		
Type	RH25M-2DK.3F.1R	RH25M-2DK.3F.1R
Article no.	172137	175224
Weight kg	6.90	6.90
* inlet ring not included		

Information

ZArail

Cpro-ECblue

C-ECblue

C series

N series

M series

FE2owllet

www.motralec.com / service-commercial@motralec.com / 01.39.97.65.10  211

Fiche produit Motralec Ziehl Abegg M Series RH25M 2D - fiche technique | Motralec

■ **DEMANDE DE PRIX RAPIDE** : <https://www.motralec.com/demandeContact>

Besoin d'un prix ou d'un conseil technique ?

Ventilateur Ziehl Abegg M SERIES RH25M 2D



4,7/5 . +600 avis Google

- Devis rapide et conseil technique par nos spécialistes
- Plus de 200 000 références et 30 marques distribuées
- Vente, réparation, bobinage et SAV en atelier
- Livraison partout en France, accompagnement avant et après-vente

Voir la gamme Ziehl Abegg sur notre site :

www.motralec.com/.../ziehl-abegg

DEMANDER UN PRIX >