

Fiche produit Motralec Ziehl Abegg M Series RH22M 2D - fiche technique | Motralec

■ **DEMANDE DE PRIX RAPIDE : <https://www.motralec.com/demandeContact>**

M-series AC technology
Size 225

Fans for railroad engineering
01/2017

M-series

for three phase alternating current, 2 pole

RH22M-2D



Description

Motor technology: AC
 Rated voltage U_N :
3- 230/400 V (Δ/Y) | 3-230/400 V (Δ/Y) | 3-265/460 V (Δ/Y) *
 Rated frequency f_N : **50 Hz | 60 Hz | 60 Hz***
 Input power P_i :
210 W | 320 W | 340 W*
 Rated current I_N :
0.76/0.44 A | 0.90/0.52 A | 0.86/0.50 A*
 Rated speed n_N :
2840 min⁻¹ | 3260 min⁻¹ | 3350 min⁻¹*
 Starting current I_A : **4.00/2.20 A | 3.80/2.20 A | 4.40/2.60 A**
 Current increase ΔI : **20 % | 30 % | 35 %**
 Thermal class: THCL155*
 Min. permitted ambient temperature $t_{R(min)}$: **-40 °C*****
 Max. permitted ambient temperature $t_{R(max)}$:
70 °C | 70 °C | 70 °C
 Electrical connection: Supply cable side, 105cm
 Degree of protection : IP54Z
 Motor protection: thermal contact
 Impeller : aluminium, unpainted
 Motor: Aluminium, 1 coat paint, pebble grey
 Conformity: CE
 * Rated data
 *** Continuous operation with occasional starts (S1) according to DIN EN 60034-1:2011-02. Occasional starting between -40 °C and -25 °C is permissible. Continuous operation below -25 °C only with special bearings for refrigeration applications on request.

Characteristic curve

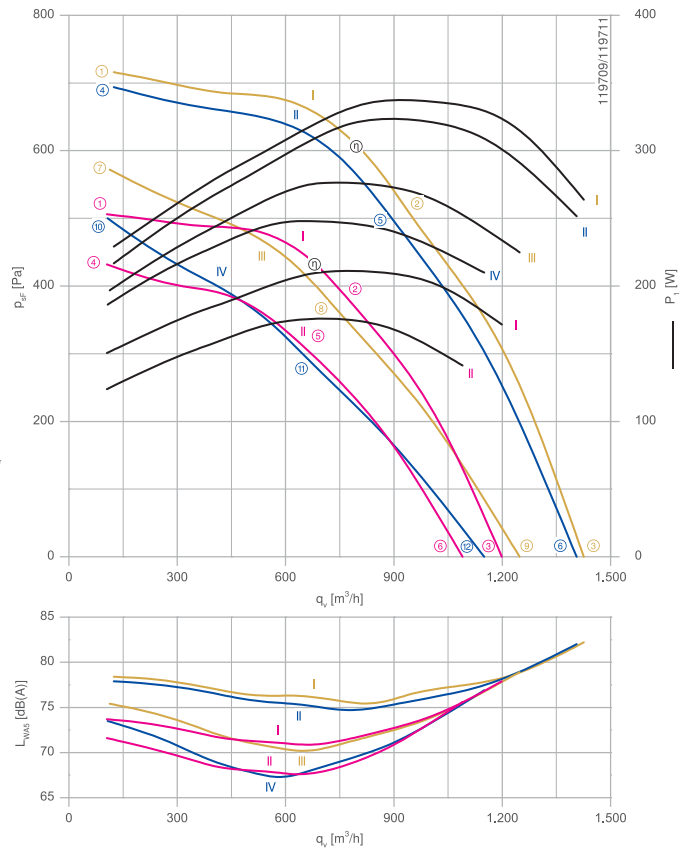

Measured with inlet ring, without guard grille according to ISO 5801

Inlet ring	00352266	RAL 7032	Page 303
		(pebble grey)	
Inlet ring	00278352	unpainted	
Connection diagram	1360-106XA		Page 327

Dimensions mm

Free-running motorized impeller RH in installation position H/Vu

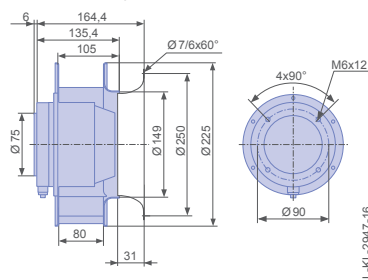

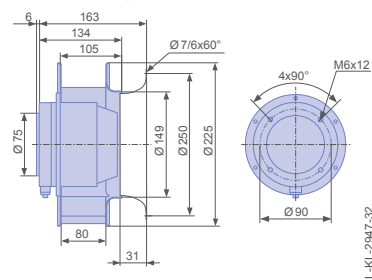

Free-running motorized impeller RH in installation position H/Vo



Type	Characteristic curve	Voltage	Frequency	Operating point	Current	Input power	Speed	Suction side sound power level
		U V	f Hz		I A	P _i W	n min ⁻¹	L _{WAS} dB(A)
RH22M-2DK.1E.1R	I	400	50	①	0.39	150	2890	74
		400*		②	0.44*	210*	2840*	71
		400		③	0.40	170	2880	78
	II	230		④	0.34	120	2680	72
		230		⑤	0.46	180	2500	68
		230		⑥	0.38	140	2620	76
	I	460	60	①	0.40	230	3450	78
		460*		②	0.50*	340*	3350*	76
		460		③	0.44	260	3430	82
	II	400		④	0.38	220	3400	78
		400*		⑤	0.52*	320*	3260*	75
		400		⑥	0.42	250	3360	82
III	265	⑦	0.46	200	3100	75		
	265	⑧	0.64	280	2760	71		
	265	⑨	0.52	220	2990	79		
IV	230	⑩	0.50	190	2900	74		
	230	⑪	0.66	250	2480	68		
	230	⑫	0.56	210	2760	77		

*rated data

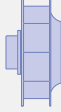
Fan ordering information

Design	RH*	RH*
Installation position	H/Vu	H/Vo
		
Type	RH22M-2DK.1E.1R	RH22M-2DK.1E.1R
Article no.	172134	175221
Weight kg	4.10	4.10
* inlet ring not included		

Information

ZArail

Cpro-ECblue

C-ECblue

C series

N series

M series

FE2owllet

www.motralec.com / service-commercial@motralec.com / 01.39.97.65.10  207

Fiche produit Motralec Ziehl Abegg M Series RH22M 2D - fiche technique | Motralec

■ **DEMANDE DE PRIX RAPIDE** : <https://www.motralec.com/demandeContact>

Besoin d'un prix ou d'un conseil technique ?

Ventilateur Ziehl Abegg M SERIES RH22M 2D



4,7/5 . +600 avis Google

- Devis rapide et conseil technique par nos spécialistes
- Plus de 200 000 références et 30 marques distribuées
- Vente, réparation, bobinage et SAV en atelier
- Livraison partout en France, accompagnement avant et après-vente

Voir la gamme Ziehl Abegg sur notre site :

www.motralec.com/.../ziehl-abegg

DEMANDER UN PRIX >