

Fiche produit Motralec Ziehl Abegg Fe2Owlet Ecblue FN100 - fiche technique | Motralec

■ DEMANDE DE PRIX RAPIDE : <https://www.motralec.com/demandeContact>

www.motralec.com / service-commercial@motralec.com / 01.39.97.65.10

FE2owlet-ECblue

for three phase alternating current, 380-480 V

FN100



Description

Motor technology: EC
 Rated voltage U_N : 3~ 380-480 V*
 Rated frequency f_N : 50/60 Hz*
 Input power P_{sys} : 2.40 kW*
 Rated current I_N : 3.80- 3.00 A*
 Rated speed n_N : 850 min⁻¹*
 Speed n at $p_{stat} = 0$ Pa: 850 min⁻¹*
 Motor input power P at $p_{stat} = 0$ Pa: 1650 W*
 Air flow q_v at $p_{stat} = 0$ Pa: 9.8 m³/s*
 Thermal class: THCL155*
 Min. permitted ambient temperature $t_{R(min)}$: -35 °C***
 Max. permitted ambient temperature $t_{R(max)}$: 45 °C
 Electrical connection: Integrated controller
 Number of blades: 5
 Degree of protection : IP54
 Motor protection: integrated active temperaturemanagement
 Blades: Aluminium, powder-coated, RAL 9006 (white aluminium)
 Rotor: Aluminium, 1 coat paint, RAL 5002 (ultramarine blue)
 Conformity: ErP 2015, CE, UL
ErP-data
 Efficiency η_{statA} : 51.4 %
 Efficiency: $N_{actual} = 55.5 / N_{target} = 40$ **
 * Rated data
 **ErP 2015
 *** Continuous operation with occasional starts (S1) according to DIN EN 60034-1:2011-02. Occasional starting between -35 °C and -25 °C is permissible. Continuous operation below -25 °C only with special bearings for refrigeration applications on request.

Characteristic curve

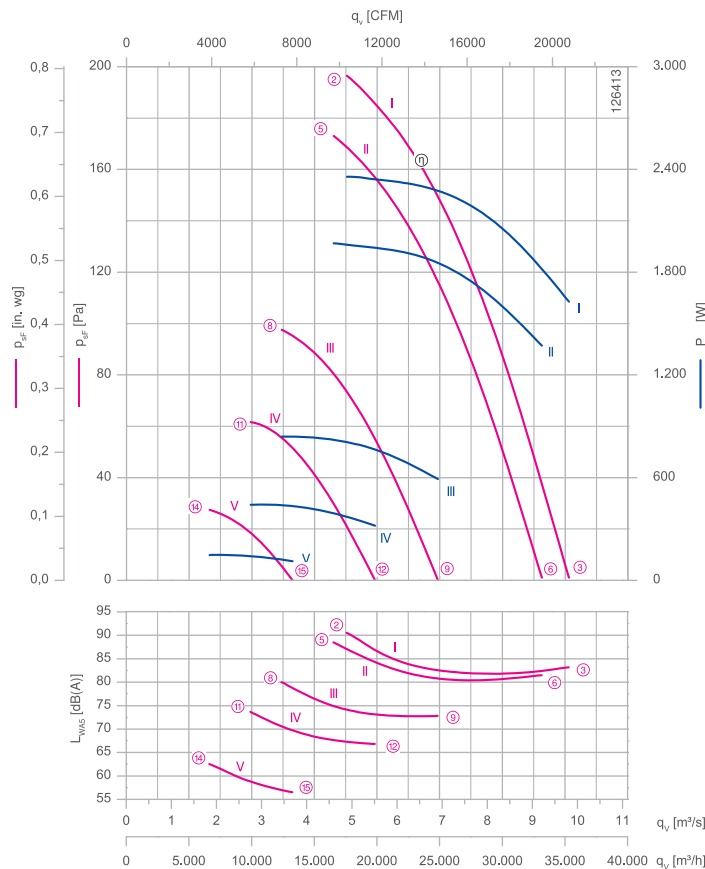

Measured with nozzle for transformer cooling and guard grille on suction side in installation type A according to ISO 5801.

Connection diagram Page 250
1360-403

System components Page 184

Dimensions mm

Airflow direction A

Design L - round full bell mouth, guard grille suction side

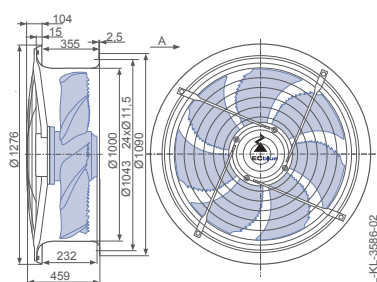

Design L - round full bell mouth, guard grille two-sided

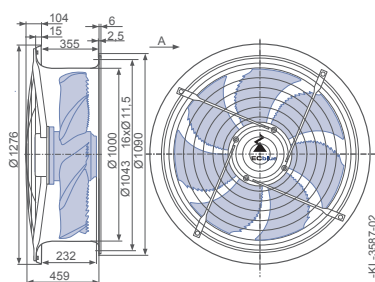

Type	Characteristic curve	Speed	Operating point	Current	Input power	Suction side sound power level
		n min ⁻¹		I A	P _{sys} W	L _{WA5} dB(A)
FN100-ZIL.GL.A5P1	I	850	②	3.70	2400	90
			③	2.50	1650	83
	II	800	⑤	3.10	2000	88
			⑥	2.20	1400	82
	III	600	⑧	1.40	860	80
			⑨	1.05	620	73
	IV	480	⑪	0.88	460	74
			⑫	0.70	330	67
	V	320	⑭	0.46	150	63
			⑮	0.37	120	57

Current values determined at 400V

Fan ordering information

Airflow direction A

Design L (guard grille suction side) L (guard grille two-sided)

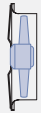

Type FN100-ZIL.GL.A5P1 FN100-ZIL.GL.A5P1
Article no. 175944/10C1 175944/10C3

Weight kg 73.70 78.40

Control technology

Control modules

Add-on modules

Operating terminal



Page 226



Page 238

Page 240

ziehl-abegg.com



49

Fiche produit Motralec Ziehl Abegg Fe2Owlet Ecblue FN100 - fiche technique | Motralec

■ DEMANDE DE PRIX RAPIDE : <https://www.motralec.com/demandeContact>

Besoin d'un prix ou d'un conseil technique ?

Ventilateur Ziehl Abegg FE2OWLET ECBLUE FN100



4,7/5 . +600 avis Google

- Devis rapide et conseil technique par nos spécialistes
- Plus de 200 000 références et 30 marques distribuées
- Vente, réparation, bobinage et SAV en atelier
- Livraison partout en France, accompagnement avant et après-vente

Voir la gamme Ziehl Abegg sur notre site :

www.motralec.com/.../ziehl-abegg

DEMANDER UN PRIX >