

C-ATEX plug fan – ZAmotbasicEx  
11/2010

Centrifugal fans main catalogue with IEC standard motor  
05/2022

# C-ATEX plug fan

ER10C

Motor ZAmotbasicEx IE3



## Description

Plug fan with high performance centrifugal impeller  
 Impeller made of bright sheet metal powder-coated resistance class 2 (L-TI-0585) RAL 9005 (jet black)  
 Inlet nozzle with measuring device for air flow measurement  
 Fitting position H (horizontal)  
 Rated voltage  $U_N$ : 3~ 400 V  
 Rated frequency  $f_N$ : 50 Hz  
 Motor protection: PTC resistor  
 Degree of protection: IP56  
 Thermal class: THCL155  
 Min. permitted medium temperature  $t_{R(min)}$ : -20 °C  
 Max. permitted medium temperature  $t_{R(max)}$  at  $n_{max}$ : 40 °C  
 Ex marking fan (mechanical): II 2G c IIB T4  
 Ex marking motor (electrical): II 2G Ex h IIB T4 Gb

## Nozzle coefficients

|                         |     |
|-------------------------|-----|
| Standard k              | 916 |
| With guard grille $k_g$ | 875 |

Characteristic curve

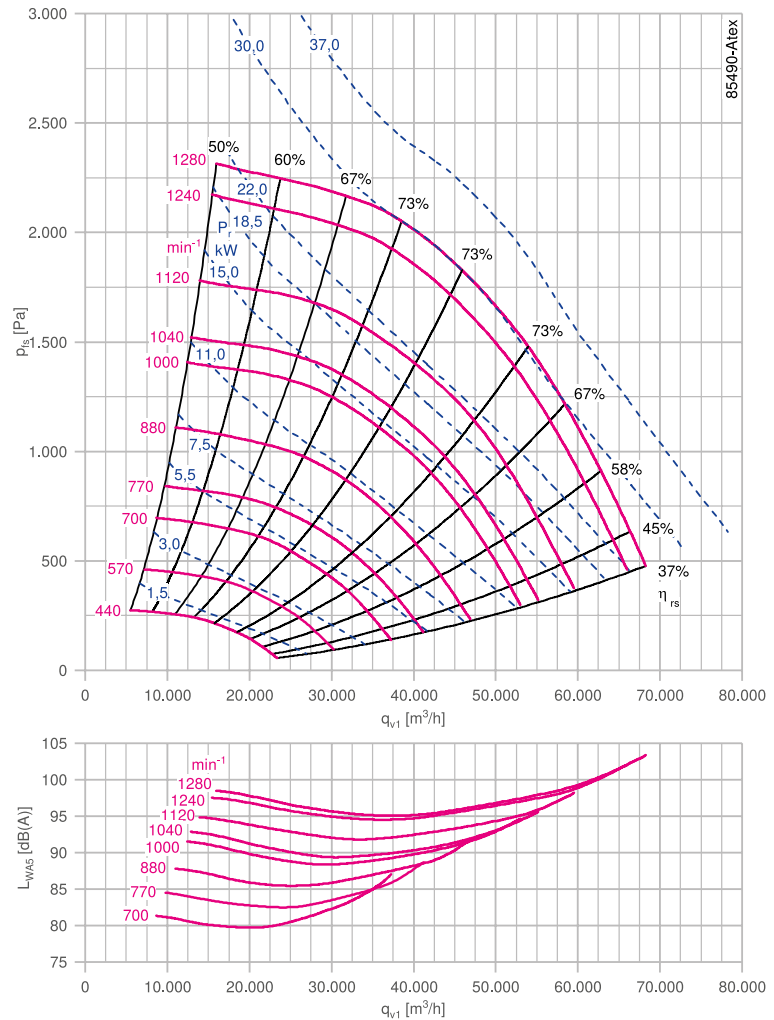

Dimensions mm

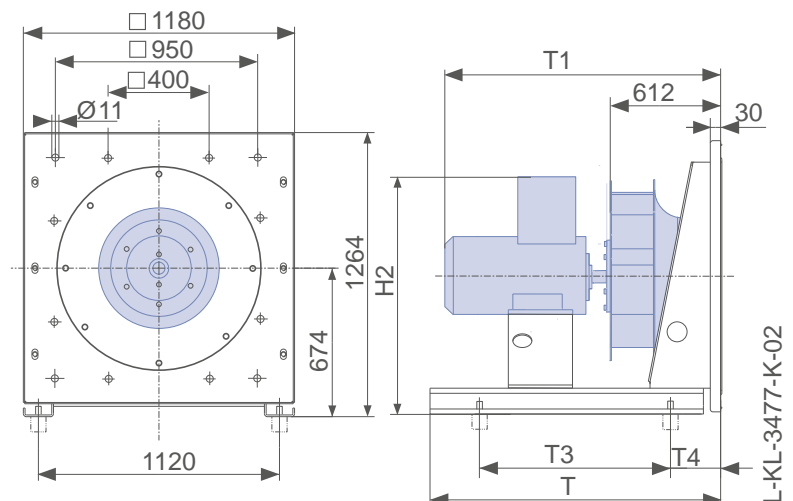

## C-ATEX-ZAmotbasicEx IE3

| Rated power<br>$P_N$<br>kW | Type                            | Article no.                 | Motor size | Motor efficiency<br>$\eta_{mot}$<br>% | Rated current<br>$I_N$<br>A | Rated speed<br>$n_N$<br>rpm | Maximum speed<br>$n_{max}$<br>rpm | Maximum frequency<br>$f_{max}$<br>Hz |
|----------------------------|---------------------------------|-----------------------------|------------|---------------------------------------|-----------------------------|-----------------------------|-----------------------------------|--------------------------------------|
| 5.5                        | <a href="#">ER10C-8DY.I7.1R</a> | <a href="#">130528/EX41</a> | 160M/L     | 87.3                                  | 12.50                       | 725                         | 700                               | 48                                   |
| 7.5                        | <a href="#">ER10C-8DY.K7.1R</a> | <a href="#">130529/EX41</a> | 160L/M     | 88.4                                  | 18.00                       | 731                         | 770                               | 53                                   |
| 11.0                       | <a href="#">ER10C-8DY.M7.1R</a> | <a href="#">130530/EX41</a> | 180L/M     | 89.7                                  | 23.30                       | 730                         | 880                               | 60                                   |
| 15.0                       | <a href="#">ER10C-6DY.M7.1R</a> | <a href="#">130531/EX41</a> | 180L/M     | 91.4                                  | 28.20                       | 978                         | 1000                              | 51                                   |
| 18.5                       | <a href="#">ER10C-6DY.N7.1R</a> | <a href="#">130532/EX41</a> | 200L/M     | 91.9                                  | 35.90                       | 980                         | 1040                              | 53                                   |
| 22.0                       | <a href="#">ER10C-6DY.N7.1R</a> | <a href="#">130533/EX41</a> | 200L/M     | 92.4                                  | 42.40                       | 980                         | 1120                              | 57                                   |
| 30.0                       | <a href="#">ER10C-6DY.R7.1R</a> | <a href="#">130534/EX41</a> | 225M/S     | 93.1                                  | 56.00                       | 982                         | 1240                              | 63                                   |
| 37.0                       | <a href="#">ER10C-6DY.S7.1R</a> | <a href="#">130535/EX41</a> | 250M/S     | 93.5                                  | 67.20                       | 985                         | 1280                              | 65                                   |

| $P_N$<br>kW | Type                            | Weight<br>kg | T<br>mm | T1<br>mm | T3<br>mm | T4<br>mm | H2<br>mm | Flexible connector | Guard grille | Vibration damper |          | Frequency inverters 3~ |
|-------------|---------------------------------|--------------|---------|----------|----------|----------|----------|--------------------|--------------|------------------|----------|------------------------|
|             |                                 |              |         |          |          |          |          |                    |              | Spring           | Rubber   |                        |
| 5.5         | <a href="#">ER10C-8DY.I7.1R</a> | 420.00       | 1160    | 1255     | 840      | 115      | 1024     | 00406435           | 00412711     | 02006450         | 02001674 | 308265                 |
| 7.5         | <a href="#">ER10C-8DY.K7.1R</a> | 455.00       | 1160    | 1255     | 998      | 115      | 1024     | 00406435           | 00412711     | 02006451         | 02001674 | 308267                 |
| 11.0        | <a href="#">ER10C-8DY.M7.1R</a> | 501.00       | 1320    | 1290     | 1103     | 115      | 1044     | 00406435           | 00412711     | 02006451         | 02000407 | 308323                 |
| 15.0        | <a href="#">ER10C-6DY.M7.1R</a> | 501.00       | 1320    | 1290     | 998      | 115      | 1044     | 00406435           | 00412711     | 02006451         | 02000407 | 308325                 |
| 18.5        | <a href="#">ER10C-6DY.N7.1R</a> | 546.00       | 1320    | 1359     | 945      | 115      | 1069     | 00406435           | 00412711     | 02006451         | 02000407 | 308327                 |
| 22.0        | <a href="#">ER10C-6DY.N7.1R</a> | 568.00       | 1320    | 1359     | 1155     | 115      | 1069     | 00406435           | 00412711     | 02006452         | 02000407 | 308329                 |
| 30.0        | <a href="#">ER10C-6DY.R7.1R</a> | 774.00       | 1320    | 1459     | 1155     | 115      | 1187     | 00406435           | 00412711     | 02006452         | 02019767 | 308331                 |
| 37.0        | <a href="#">ER10C-6DY.S7.1R</a> | 877.00       | 1320    | 1517     | 1155     | 115      | 1207     | 00406435           | 00412711     | 02006452         | 02019767 |                        |

Information

ZAbuefin

Cpro

C

C-ATEX

Impellers with hub

System components

Control technology

General notes