

motralec

4 rue Lavoisier . ZA Lavoisier . 95223 HERBLAY CEDEX

Tel. : 01.39.97.65.10 / Fax. : 01.39.97.68.48

Demande de prix / e-mail : service-commercial@motralec.com

www.motralec.com

BÖRGER®

Innovation

Simplicity

is Simply Better



**Bolted Stainless
Steel Tanks**

Segment Construction

30 – 4.000 m³



Börger Tanks from solid stainless steel are factory engineered to customer specifications. The custom designed liquid storage tanks can be utilized for a wide variety of fluids.

The tank segments are assembled in a vertical overlapped position and bolted with a double row.

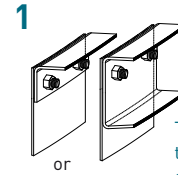
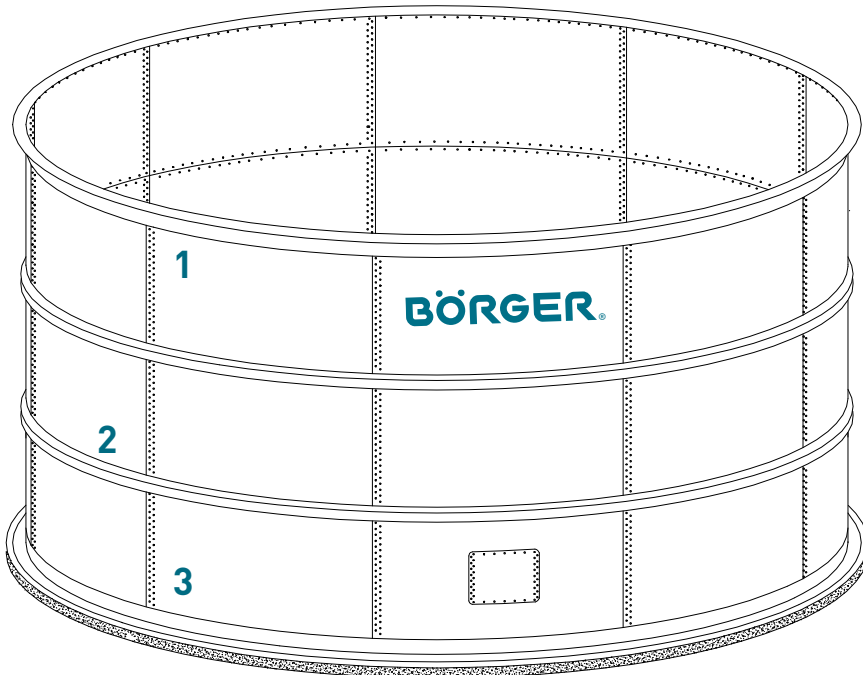

Top curb circumferential reinforcement ring ensures stiffness of the tank construction.

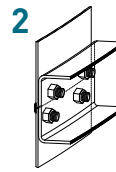

The horizontal contact edges of the segments are flat faced bolted via the reinforcement U-channels. This design enhances the stability of the tank wall and minimizes the weight.

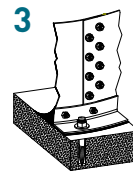

The floor connection design incorporates a simple and effective anchoring system that is durable and flexibly sealed.

The tank layout with capacities between 30 – 4,000 m³ (8,000 – 1,058,000 gal) is determined by height and diameter of the tank (see dimensional tank selection chart in back of brochure). Load and structural calculations are available. The modular ring segment construction of Börger Tanks allows for future capacity increase and / or for relocation of the tank. Flexibility and Simplicity – characteristics for Börger Tanks.



Various roof configurations are available. Stainless Steel Roof - Section Construction.

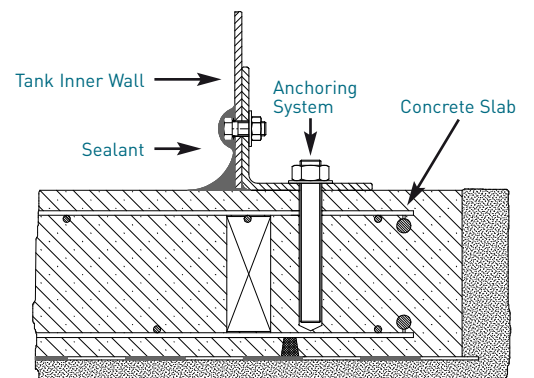

Features, Applications and Options / Accessories

Features:

- maintenance free
- gastight construction
- versatile use
- easy to transport
- rapid onsite assembly
- future capacity increase
- potential tank relocation
- many accessories
- many tank sizes



Applications:

- as storage tank for liquids
- as sludge storage tank
- as digester
- as aeration tank
- as fermenter
- as fire protection
- for wastewater treatment
- for liquid fertilizer
- for manure
- and many other uses

Options/Accessories

- factory designed segment construction, tank connections, tanks access, manway etc.
- ladders with safety cage, stairways, platforms
- various roof designs with a wide range of materials
- tank insulation

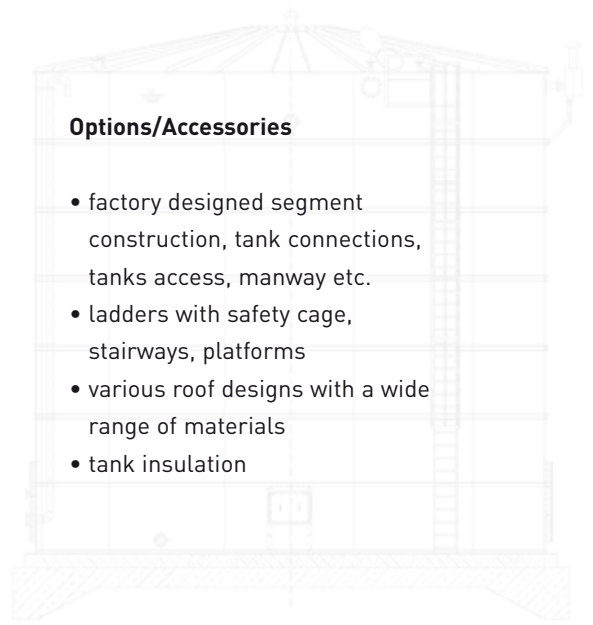

Tank Projects



Wastewater Equalization Tank
 Diameter: 10.19 m
 Height: 10.50 m



Sludge Storage Tank with Access Platform
 Diameter: 4.63 m
 Height: 10.50 m



Wastewater Treatment Plant Aeration Tank (Tank in Tank)
 Diameter: 20.20 m
 Height: 4.50 m



Biogas Plant Digester and Storage Tank
 Diameter: 18.53 m / 16.67 m
 Height: 6.00 m / 6.00 m



Agricultural Tank with Cover
 Diameter: 17.60 m
 Height: 6.00 m



Manure Storage Tank
 Diameter: 15.75 m
 Height: 6.00 m

motralec

4 rue Lavoisier . ZA Lavoisier . 95223 HERBLAY CEDEX
 Tel. : 01.39.97.65.10 / Fax. : 01.39.97.68.48
 Demande de prix / e-mail : service-commercial@motralec.com
www.motralec.com

Type	Cyl. Height (m)		1	2	3	4	5	6	7	8
	Ø (m)	Area (m²)	1,50	3,00	4,50	6,00	7,50	9,00	10,50	12,00
04	3,71	11		32	49	65	81	97	113	129
05	4,63	17		51	76	101	126	152	177	202
06	5,56	24	36	73	109	146	182	218	255	291
07	6,48	33	50	99	149	198	248	297	347	396
08	7,41	43	65	129	194	259	323	388	453	518
09	8,34	55	82	164	246	328	409	491	573	655
10	9,26	67	101	202	303	404	505	606	708	809
11	10,19	82	122	245	367	489	612	734	856	978
12	11,12	97	146	291	437	582	728	873	1019	1164
13	12,04	114	171	342	512	683	854	1025	1196	
14	12,97	132	198	396	594	792	991	1189	1387	
15	13,89	152	227	455	682	910	1137	1365		
16	14,82	173	259	518	776	1035	1294	1553		
17	15,75	195	292	584	876	1168	1461	1753		
18	16,67	218	328	655	983	1310	1638			
19	17,60	243	365	730	1095	1490	1825			
20	18,53	270	404	809	1213	1617	2022			
21	19,45	297	446	892	1337	1783				
22	20,38	326	489	978	1468	1957				
23	21,30	356	535	1069	1604	2139				
24	22,23	388	582	1164	1747	2329				
25	23,16	421	632	1264	1895	2527				
26	24,08	456	683	1367	2050	2734				
27	25,01	491	737	1474	2211	2948				
28	25,94	528	792	1585	2377	3170				
29	26,86	567	850	1700	2550	3400				
30	27,79	606	910	1819	2729	3638				
31	28,71	648	971	1943	2914					
32	29,64	690	1035	2070	3105					
33	30,57	734	1101	2202	3302					
34	31,49	779	1168	2337	3505					

in m³