

CELEBRATING

35 Years

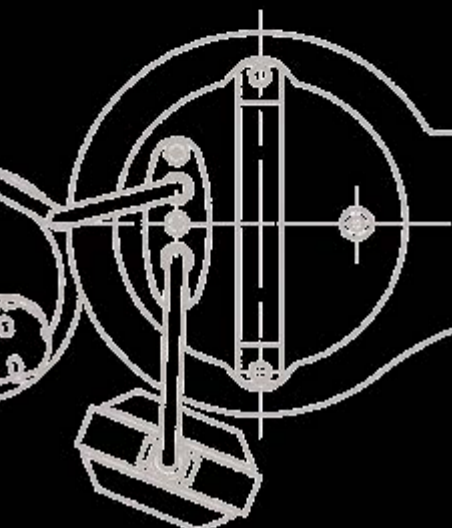

Catalog 2015

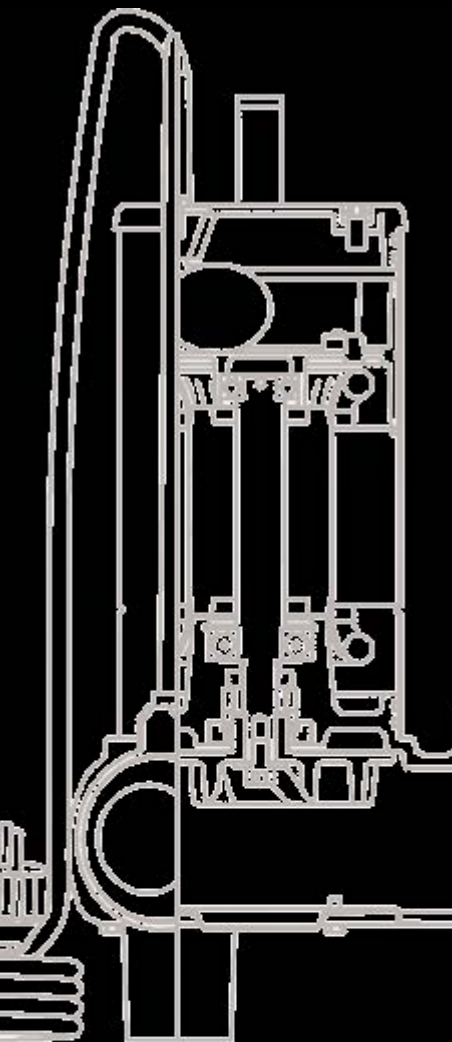

motralec

4 rue Lavoisier . ZA Lavoisier . 95223 HERBLAY CEDEX
Tel. : 01.39.97.65.10 / Fax. : 01.39.97.68.48
Demande de prix / e-mail : service-commercial@motralec.com
www.motralec.com



HISTORY :

Founded in 1979, the Company OLIJU, led by Julio Nogueira Rodrigues, started its activity in the manufacture of electric pumps. Based in Rio and Meão Esmoriz Portugal, OLIJU has continued to grow and expand its milling facilities. Today is the symbol of an efficient and innovative.

PRODUCTION :

A notable feature of OLIJU is its high production flexibility with the ability to respond quickly to your needs, in quantity or specificity. The daily production can be increased in case of urgent demand. All products are tested for functional electrical and hydraulic.

TECHNOLOGY :

The growth of the company and regular investments have enabled OLIJU implement innovative programs of research and development. Automated processes have been developed for the assembly of products, prototyping and testing. The products are constantly renewed according to the standards and with the aim of reducing the manufacturing cost.

HUMAN RESOURCES :

The real wealth of OLIJU is its staff. In a difficult economic and social context, emphasis is placed on training and quality of working conditions. Stimulate and encourage employees is to create innovation and develop the company's success. OLIJU is also waiting for the ISO 9000 (Quality Management).

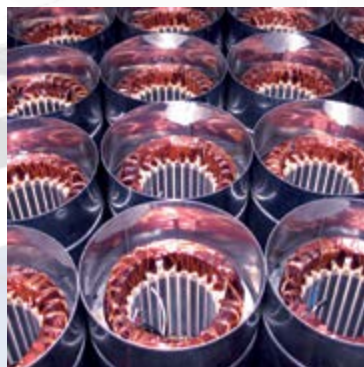

DRAINAGE	Submersible Pump for Drainage	Dreno	4
SEWAGE	Submersible Pump for sewage water	Vortex N	8
		Vortex NR	12
		Vortex F	14
		Vortex SV	18
		Grinder	20
		MC	22
		Guide Rail	23
WELLS	Well pump for clean water	Presentation of the range Aqualiju	24
		Aqualiju AJ	25
		Aqualiju A	26
		Aqualiju AC/AB	27
		Presentation of the range Aqualiju SA	28
		Aqualiju SA	29
		Presentation of the range AquaRain	30
BOREHOLE	Borehole pump 4"	AquaRain RJ	31
		Presentation of the range SFI	32
		Kit SFI	33
		SFI A	34
		SFI B	35
		SFI C	36
		SFI D	37
		SFI E	38
		SFI F	39
		Hydraulic only	40
Motors only and cables Franklin	41		
SURFACE PRESSURE	Surface pump multicellular	Presentation of the range CMH	42
		CMH 10 (+ version booster HP)	43
		CMH 20 (+ version booster HP)	44
		CMH 30	45
		CMH 40	46
		CMV 20	47
		CMV 30	48
	CMV 40	49	
	Booster and Booster sets	Presentation of the range DUO	50
		DUO CMH - DUO CMV	51
		TRI CMH - TRI CMV	52
	Surface pump self priming	JET	53
	Single-stage cast iron	BMI - BTI	54
Centrifugal pump for coupling	CF2/CFA2	56/57	
Electric motor aluminum	OF - OS	58	
	OT	59	
ACCESSORIES	Stainless steel tank - Borehole cover - Stainless steel cannon		60
	Cabinet and electrical cabinet		61

DRAINAGE

Dreno

Submersible Pump for Drainage

USE:

Water pumping weakly charged
Suspended solids \varnothing 5 mm max
Immersion depth of 10 m

FEATURES:

Engine oil bath, insulation class F
Double seals, lip seals and reinforced carbon ceramic mechanical seal
Power cable: 10 m neoprene
Motor casing in stainless steel, 304 stainless steel open impeller
Pump body in cast iron, 420 stainless steel shaft
continuous service



..... ■ **Clean water / muddy water**

Dreno

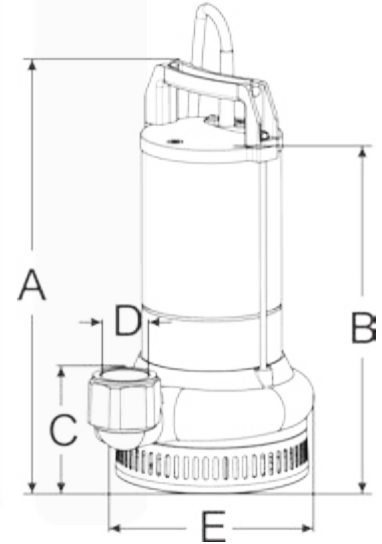

Type	Dimensions (mm)					Weight Kg
	A	B	C	\varnothing D	E	
R 30.15	239,5	239,5	91	1"	136	8,9
R 30.37	299,5	249,5				9,1
R 35.60	335	285	110	1 1/4"	160	11,0
R 40.75	355	305		1 1/2"		12,0
R 50.110	370	350	120	2"	175	16,0
R 35.75	350	295	110	1 1/4"	160	11,5
R 40.80	370	315		1 1/2"		12,5
R 50.150	380	340	120	2"	175	17,0

Submersible Pump for Drainage

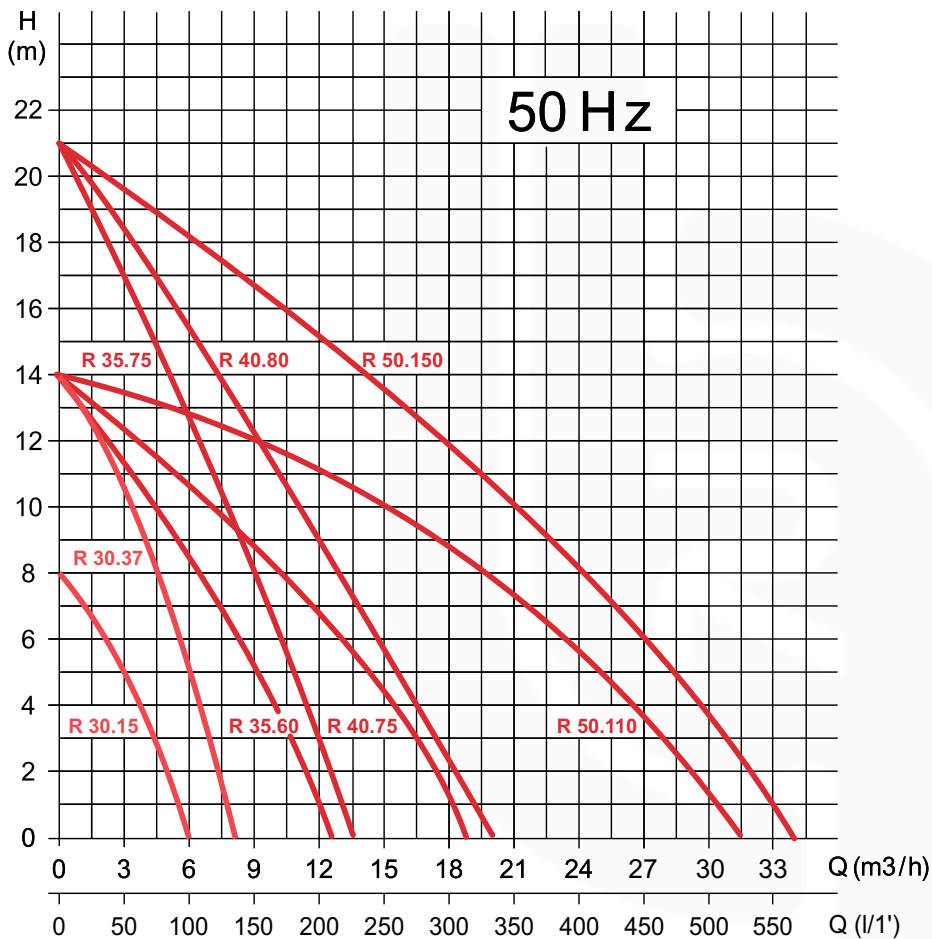

Type	power		I (A)		Connection DN	H (max) m	Debit (max) m³/h	Code		
	kW	CV	1x230	3x400				1x230v (1M)	1x230v (1A)	1x400v
R 30.15	0,15	0,2	2,9	1,1	1"	8	5	01011203	01011204	01011205
R 30.37	0,37	0,5	3,4	1,3		14	8	01011206	01011207	01011208
R 35.60	0,6	0,8	4,0	1,8	1 1/4"	14	12,5	01010797	01010796	01010798
R 40.75	0,75	1	5,0	2,6	1 1/2"		18,5	01010800	01010799	01010801
R 50.110	1,1	1,5	8,5	3,0	2"		31,5	01010803	01010802	01010804
R 35.75	0,75	1	5,4	2,6	1 1/4"	21	13	01010817	01010818	01010819
R 40.80	0,8	1,1	7,8	3,0	1 1/2"		20	01010790	01010789	01010791
R 50.150	1,5	2	8,8	4,0	2"		34	01010793	01010792	01010794

Power cable: 10 m neoprene - Type A: model with float

DRAINAGE

Dreno

Submersible
Pump for
Drainage

..... ■ Clean water / muddy water



The range **Dreno RF** is designed for pumping clean/muddy water solids, it is ideal for installation with guide rain.

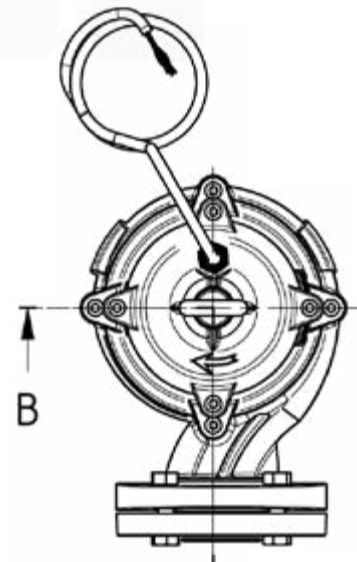
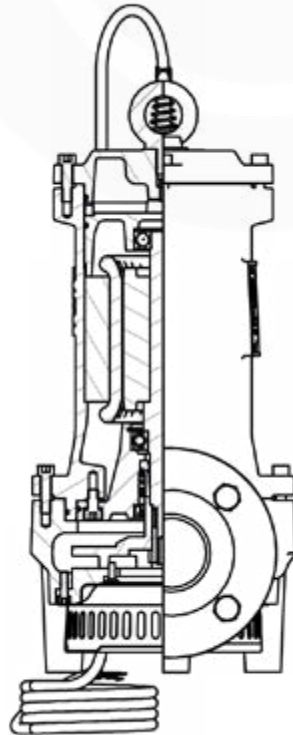

USE:

Water pumping weakly charged
Suspended solids \varnothing 5 mm max
Immersion depth of 10 m

FEATURES:

Engine oil bath, insulation class F
Double seals, lip seals and mechanical seal SIC-SIC
Power cable: 20 m neoprene
Motor, impeller and pump body in cast iron,
420 stainless steel shaft
continuous service



DRAINAGE

Dreno

**Submersible
Pump for
Drainage**

Horizontal outlet ■

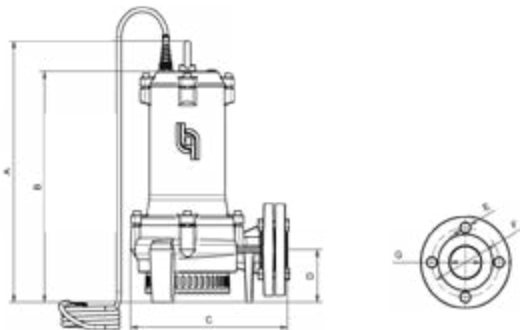
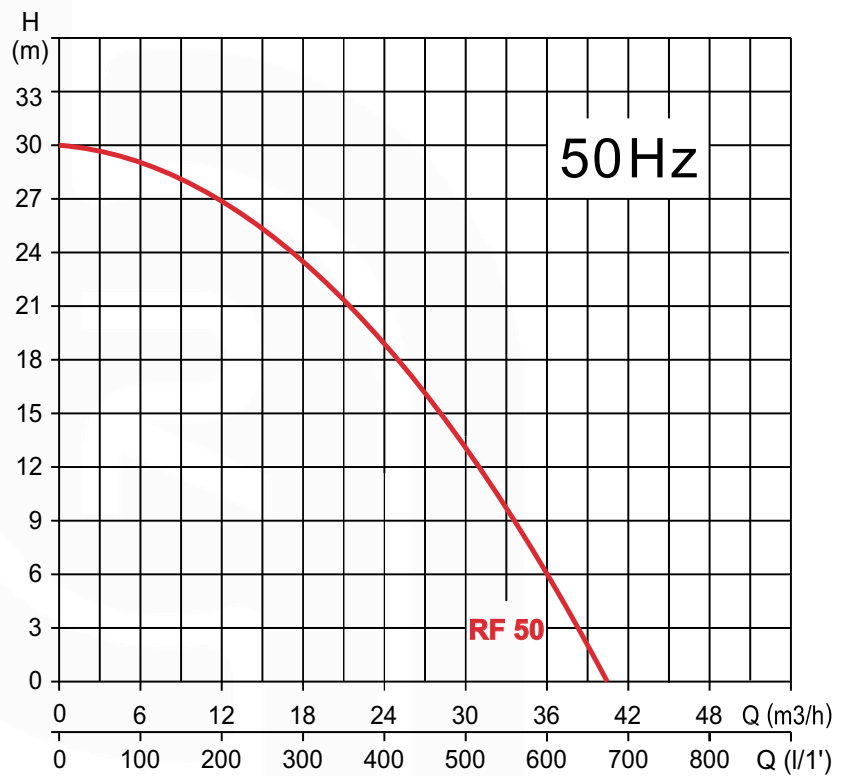
Dreno

Type	Dimensions (mm)							Weight Kg
	A	B	C	D	\varnothing E	\varnothing F	G	
RF 50.220	470	415	294	95	13	110	2"	35,5

Type	Power		Motor			Connection DN	H (max) m	Debit (max) m³/h	Code		
	kW	CV	1~ A	μ F	3~ A				1x230v (.1M)	1x230v (.1A)	3x400v (.3)
RF 50.220	2,2	3		50	5,3	2"	30	40	01011075	01011078	01011076

Power cable: 20 m neoprene

SEWAGE

Range Vortex N

Submersible
Pump for
Sewage Water

KEY ADVANTAGES OF A VORTEX PUMP:

Incolmatage : The vortex impeller creates a vortex that leads to most solids without contact with the turbine and the fibrous materials are repelled and can not hold on to the turbine.

Minimum wear + consistent performance: The Vortex pump wear is very low because most of the solids pumped passes through the volute without touching the turbine. The yield remains constant over a long period.

Low maintenance + no adjustment: The position of the wheel back in the volute eliminates the risk of blockage and sudden loss of performance. No adjustment is necessary and the cost of maintenance and operation are low and constant.

■ Vortex NJ : Vertical outlet

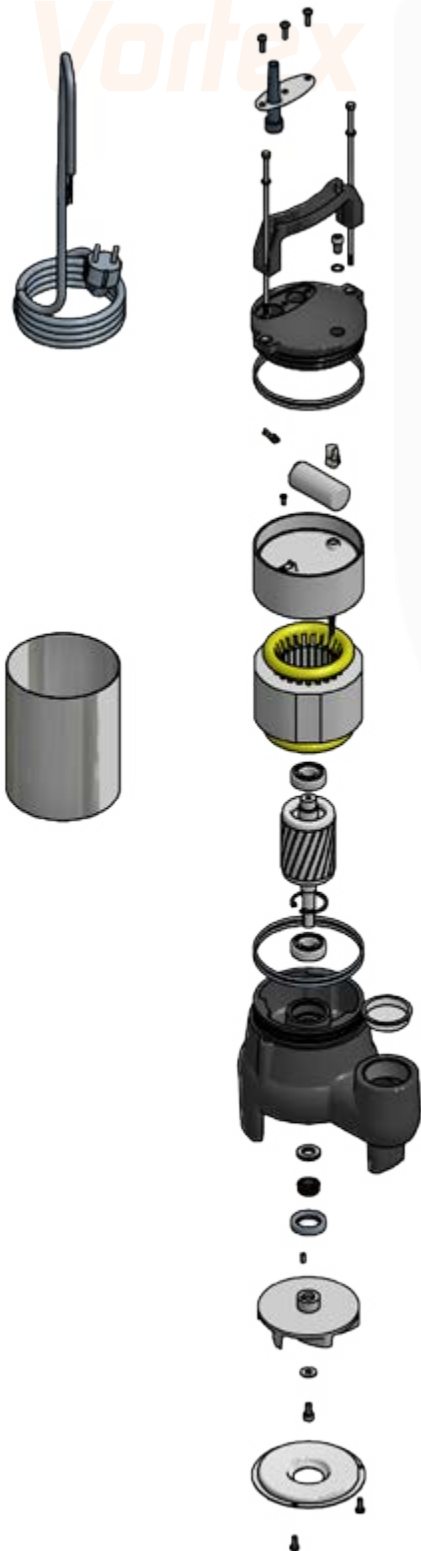

The range **Vortex NJ** is especially designed to meet the water loaded with suspended matter, all wastewater houses (excluding WC) From 30 mm passage. Very low electrical consumption. Adapted to the sludge recirculation for microstation

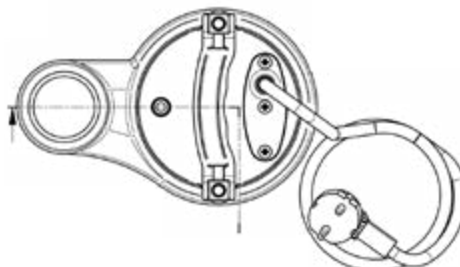
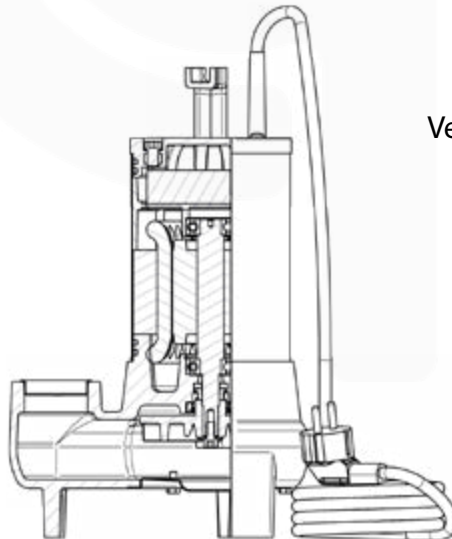

USE :

Laden water with suspended solids, sludge recirculation for microstation
 All wastewater from homes, except toilets from 30 mm to pass
 Immersion depth of 10 m

FEATURES :

- Motor casing in stainless steel
- Casing pump in cast
- Impeller in cast iron, stainless steel shaft
- Engine oil bath class F, 10 m cable, built-in capacitor (to phase)
- Double seals, lip seals and reinforced carbon ceramic mechanical seal
- Single-phase models with or without float float (types A)



SEWAGE
Vortex N

**Submersible
 Pump for
 Sewage Water**

Vertical outlet

Vortex

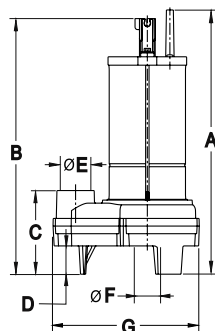
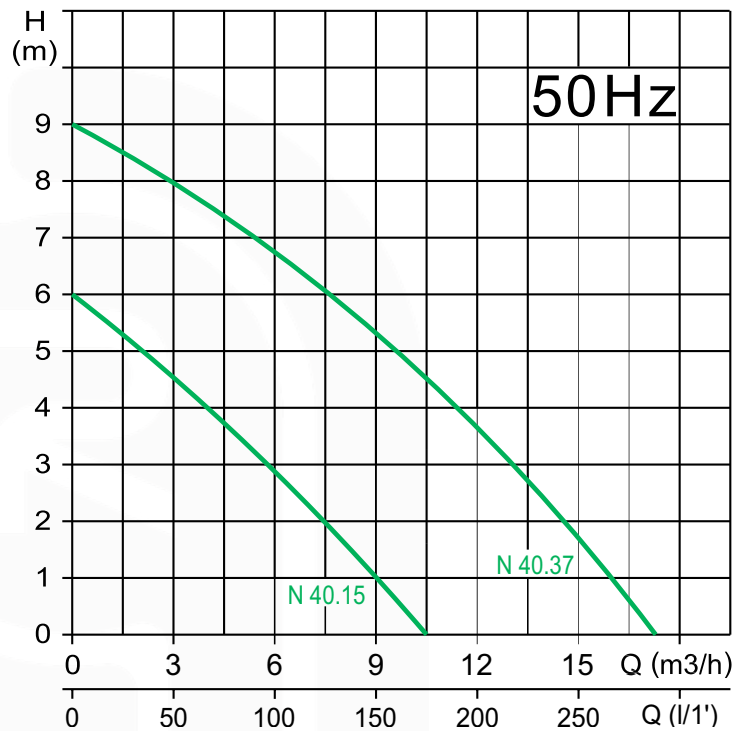

Type	Dimensions (mm)							Weight Kg
	A	B	C	D	ø E	ø F (passage)	G	
N 40.15	322	311	111	35	1"½	30	213	9,8
N 40.37	347	335						10

Type	Power		Motor			Passage ø mm	Connection DN	H (max) m	Debit (max) m³/h	Code		
	kW	CV	1~ A	μF	3~ A					1x230v (.1M)	1x230v (.1A)	3x400v (.3)
N 40.15	0,15	0,2	2	12	1	30	1"½	6	9,6	01011051	01011052	01011053
N 40.37	0,37	0,5	3,4	16	1,3			9	16,7	01011027	01011028	01011029

Built-in capacitor for single-phase models - Type A: model with float switch

SEWAGE

Range Vortex N

Submersible
Pump for
Sewage Water

KEY ADVANTAGES OF A VORTEX PUMP:

Incolmatage : The vortex impeller creates a vortex that leads to most solids without contact with the turbine and the fibrous materials are repelled and can not hold on to the turbine.

Minimum wear + consistent performance: The Vortex pump wear is very low because most of the solids pumped passes through the volute without touching the turbine. The yield remains constant over a long period.

Low maintenance + no adjustment: The position of the wheel back in the volute eliminates the risk of blockage and sudden loss of performance. No adjustment is necessary and the cost of maintenance and operation are low and constant.

Vortex N : Vertical outlet

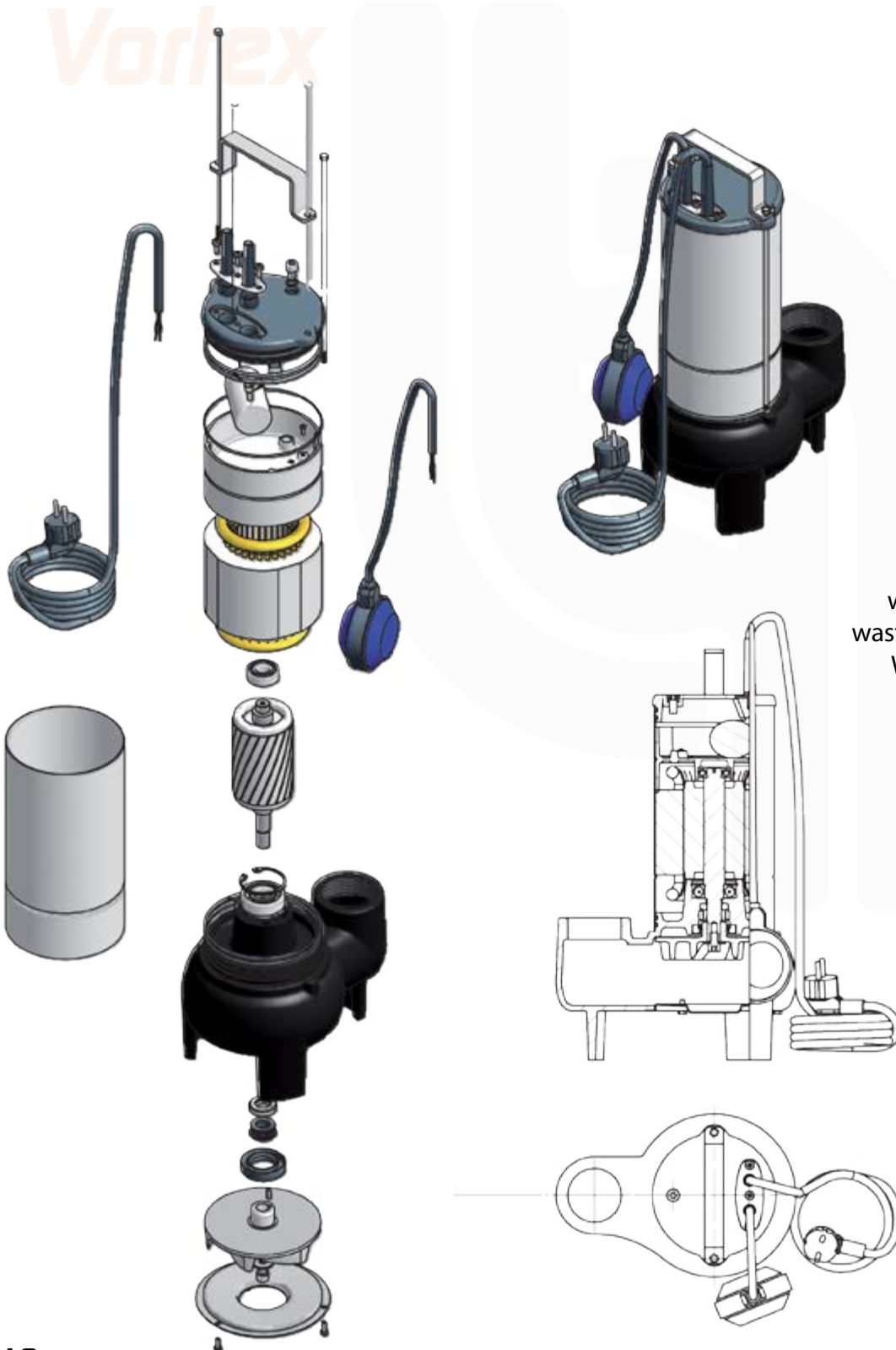

The range **Vortex N** is especially designed to meet the water loaded with suspended matter, all wastewater houses (including WC) from 50 mm passage.

USE :

Laden water with suspended solids
 All wastewater from homes, including toilets from 50 mm to pass
 Immersion depth of 10 m

FEATURES :

Motor casing in stainless steel
 Casing pump in cast iron
 Impeller in cast iron, stainless steel shaft
 Engine oil bath class F, 10 m cable, built-in capacitor (to phase)
 Double seals, lip seals and reinforced carbon ceramic mechanical seal
 Single-phase models with or without float float (types c / b)



SEWAGE
Vortex N

**Submersible
 Pump for
 Sewage Water**

Vertical outlet

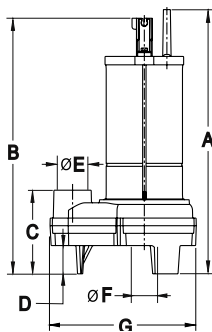
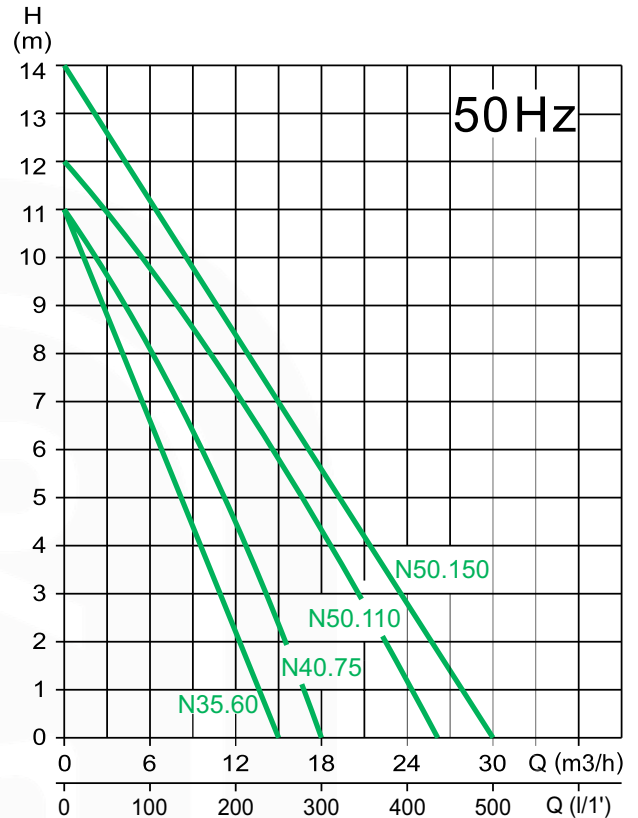

Type	Dimensions (mm)							Weight Kg
	A	B	C	D	ø E	ø F (passage)	G	
N 35.60	345	335	110	37	1"¼	33	215	10,5
N 40.75	365	355	120	42	1"½	35	230	11,5
N 50.110	425	410	137,5	53	2"	50	255	17,0
N 50.150	435	420	137,5					19,0

Type	Power		Motor			Passage ø mm	Connection DN	H (max) m	Debit (max) m³/h	Code		
	kW	CV	1~ A	μF	3~ A					1x230v (.1M)	1x230v (.1A)	3x400v (.3)
N 35.60	0,6	0,8	5,2	16	1,4	33	1"¼	11	15	01010671	01010668	01010674
N 40.75	0,75	1	6,4	20	2,6	35	1"½	11	18	01010680	01010677	01010683
N 50.110	1,1	1,5	9,0	35	3,0	50	2"	12	26	01010689	01010686	01010692
N 50.150	1,5	2	9,4	40	3,7			14	30	01010752	01010366	01010701

Built-in capacitor for single-phase models - Type A: model with float switch

SEWAGE

Range Vortex NR

Submersible
Pump for
Sewage Water

KEY ADVANTAGES OF A VORTEX PUMP:

Incolmatage : The vortex impeller creates a vortex that leads to most solids without contact with the turbine and the fibrous materials are repelled and can not hold on to the turbine.

Minimum wear + consistent performance: The Vortex pump wear is very low because most of the solids pumped passes through the volute without touching the turbine. The yield remains constant over a long period.

Low maintenance + no adjustment: The position of the wheel back in the volute eliminates the risk of blockage and sudden loss of performance. No adjustment is necessary and the cost of maintenance and operation are low and constant.

■ Vortex NR : Vertical outlet

Vortex

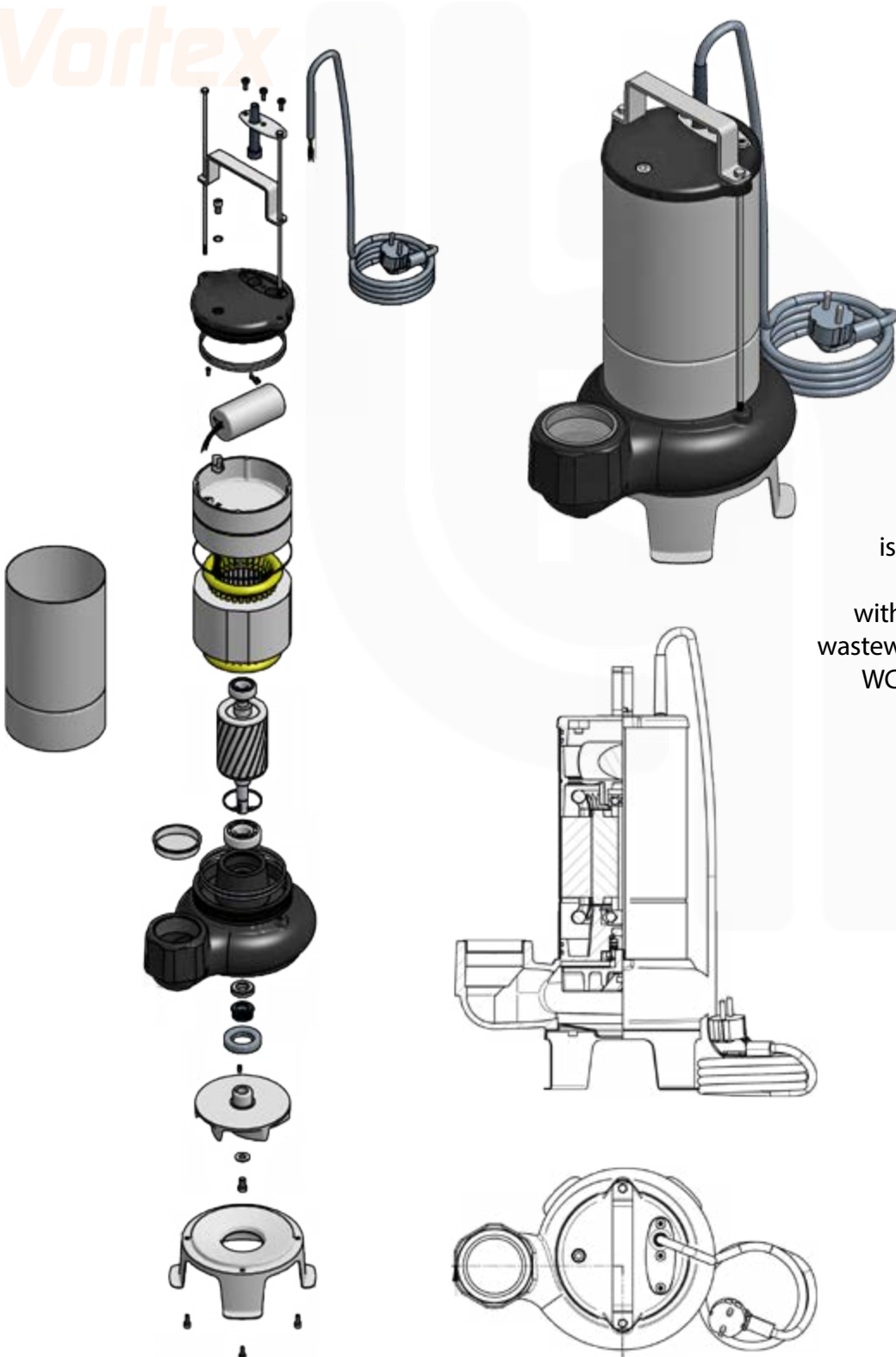

The range **Vortex NR** is especially designed to meet the water loaded with suspended matter, all wastewater houses (including WC) with 50 mm passage.

USE :

Laden water with suspended solids
 All wastewater from homes, including toilets from 50 mm to pass
 Immersion depth of 10 m

FEATURES :

Motor casing in stainless steel
 Pump head in cast. Casing and pump in cast and stainless steel
 Impeller in cast iron, stainless steel shaft
 Engine oil bath class F, 10 m cable, built-in capacitor (to phase)
 Double seals, lip seals and reinforced carbon ceramic mechanical seal
 Single-phase models with or without float float (types c / b)



SEWAGE
Vortex NR

**Submersible
 Pump for
 Sewage Water**

Vertical outlet

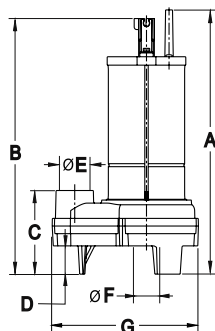
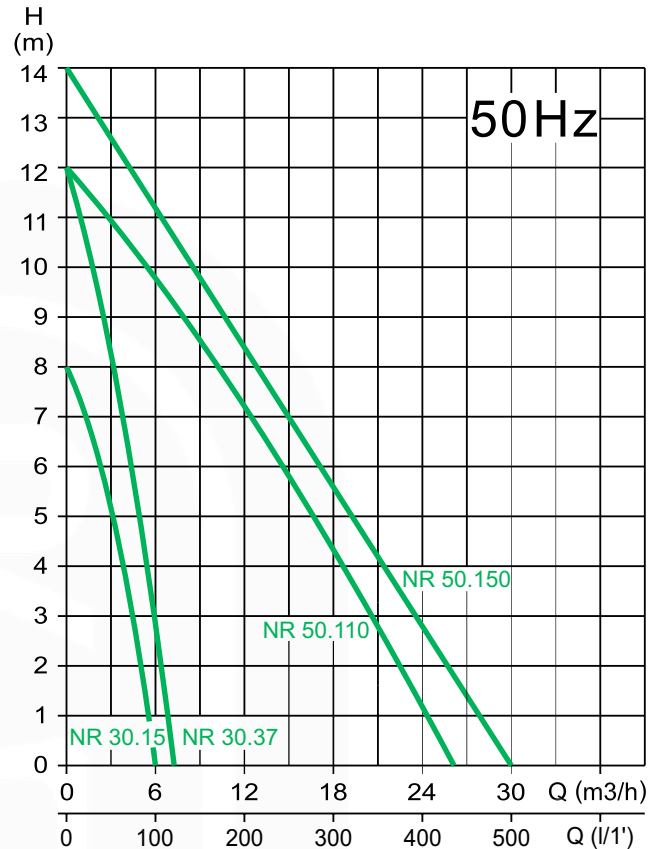

Type	Dimensions (mm)							Weight Kg
	A	B	C	D	ø E	ø F (passage)	G	
NR 30.15	302	291	92,5	35,5	1"	25	190	8,7
NR 30.37	312	301						8,9
NR 50.110	432	420	148	60	2"	50	252	18
NR 50.150	442	430						20

Type	Power		Motor			Passage ø mm	Connection DN	H (max) m	Debit (max) m³/h	Code		
	kW	CV	1~ A	μF	3~ A					1x230v (.1M)	1x230v (.1A)	3x400v (.3)
NR 30.15	0,15	0,2	2,9	12,5	1,1	25	1"	8	5	01011191	01011192	01011193
NR 30.37	0,37	0,5	3,2	16	1,3			12	7	01011194	01011195	01011196
NR 50.110	1,1	1,5	9,0	35	3,0	50	2"	12	26	01011019	01011020	01011021
NR 50.150	1,5	2	9,4	40	3,7			14	30	01011022	01011023	01011024

Built-in capacitor for single-phase models - Type A: model with float switch

SEWAGE

Range Vortex F

Submersible
Pump for
Sewage Water

KEY ADVANTAGES OF A VORTEX PUMP:

Incolmatage : The vortex impeller creates a vortex that leads to most solids without contact with the turbine and the fibrous materials are repelled and can not hold on to the turbine.

Minimum wear + consistent performance: The Vortex pump wear is very low because most of the solids pumped passes through the volute without touching the turbine. The yield remains constant over a long period.

Low maintenance + no adjustment: The position of the wheel back in the volute eliminates the risk of blockage and sudden loss of performance. No adjustment is necessary and the cost of maintenance and operation are low and constant.

Vortex F : Horizontal outlet

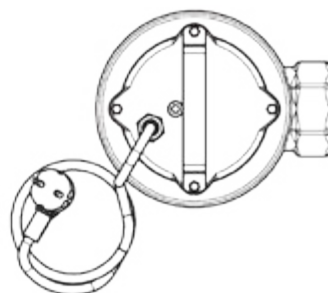
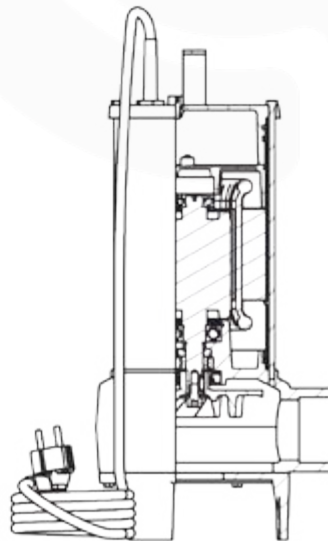
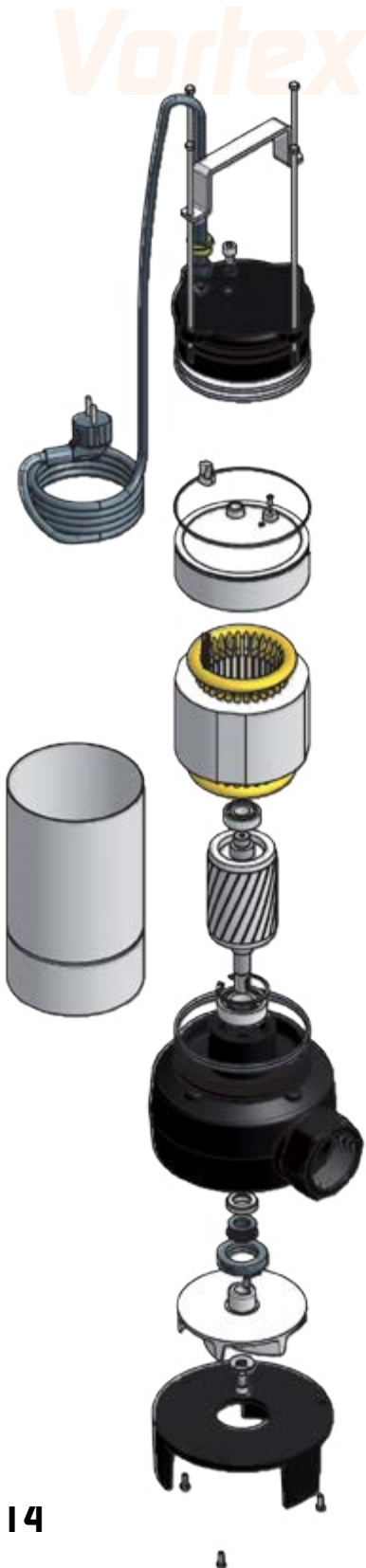

The range **Vortex F** is designed for pumping of sewage with suspended solids, it is ideal for installation with guide rain.

USE :

Water loaded with suspended matter
 All wastewater from homes, including toilets from 50 mm to pass
 Front outlet is ideal for installations with guide rail
 Immersion depth of 10 m

FEATURES :

Motor casing in stainless steel
 Volute pump in cast iron, stainless steel shaft
 Engine oil bath class F, 10 m cable, built-in capacitor (to phase)
 Double seals, lip seals and reinforced carbon ceramic mechanical seal
 Single-phase models with or without float float (type A)



SEWAGE
Vortex F

**Submersible
 Pump for
 Sewage Water**

Horizontal outlet

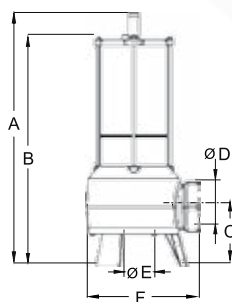
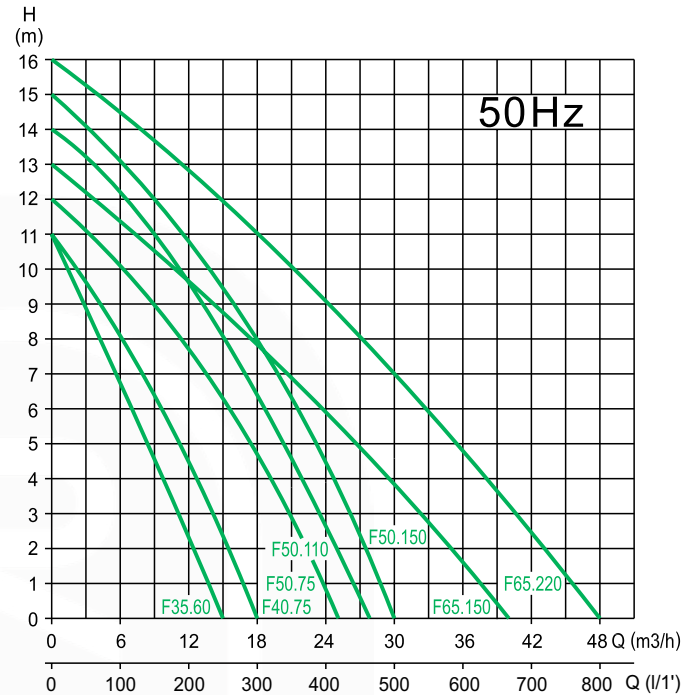

Type	Dimensions (mm)					F	Weight Kg
	A	B	C	ø D	ø E (passage)		
F 35.60	338	288	70	1"¼	33	174	11,5
F 40.75	368	318	85	1"½	38	177	13,5
F 50.75	413	363	98	2"	50	200	15,5
F 50.110	432	383				210	20,0
F 50.150	442	393	115	2" ½	65	217	20,5
F 65.150	483	435				217	22,0
F 65.220	493	445					25,0

Type	Power		Motor			Passage ø mm	Connection DN	H (max) m	Debit (max) m³/h	Code		
	kW	CV	1~ A	μF	3~ A					1x230v (.1M)	1x230v (.1A)	3x400v (.3)
F 35.60	0,6	0,8	5,2	16	1,4	33	1"¼	11	15	01010916	01010917	01010918
F 40.75	0,75	1	6,4	20	2,6	38	1"½	11	18	01010896	01010897	01010898
F 50.75			7,7	20	2,8					50	2"	01010899
F 50.110	1,1	1,5	8,9	35	3,0	50	2"	14	27,5			01010902
F 50.150	1,5	2	9,8	35	3,7			65	2" ½	15	30	01010905
F 65.150			11,3	40	4,8	65	2" ½			13	41	01010908
F 65.220	2,2	3	-	-	6,1					16	48	---

Power cable: 10 m neoprene - Type A: model with float switch

SEWAGE

Range Vortex SF

Submersible
Pump for
Sewage Water

KEY ADVANTAGES OF A VORTEX PUMP:

Incolmatage : The vortex impeller creates a vortex that leads to most solids without contact with the turbine and the fibrous materials are repelled and can not hold on to the turbine.

Minimum wear + consistent performance: The Vortex pump wear is very low because most of the solids pumped passes through the volute without touching the turbine. The yield remains constant over a long period.

Low maintenance + no adjustment: The position of the wheel back in the volute eliminates the risk of blockage and sudden loss of performance. No adjustment is necessary and the cost of maintenance and operation are low and constant.

..... ■ Vortex SF : Horizontal outlet

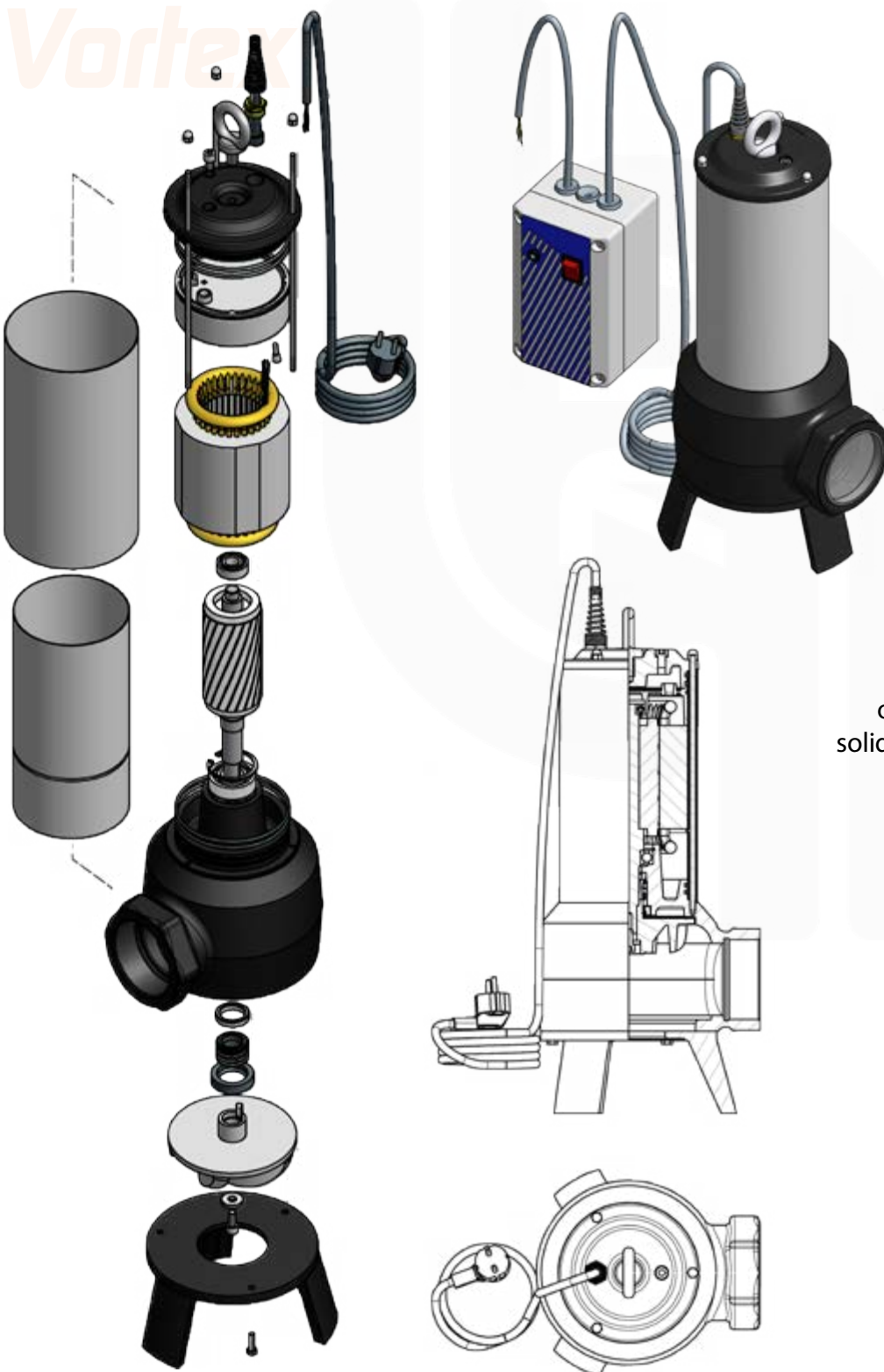

The range **Vortex SF** is designed for pumping of sewage with suspended solids, it is ideal for installation with guide rain.

USE :

Water loaded with suspended matter
 All wastewater from homes, including toilets from 80 mm to pass
 Front outlet is ideal for installations with guide rail
 Immersion depth of 10 m

FEATURES :

Protection box in monophasic version.
 Motor casing in stainless steel, volute pump head and impeller
 in cast iron, stainless steel shaft. Engine oil bath class F, 10 m cable,
 Double seals, lip seals and mechanical seal **SIC-SIC**
 Single-phase models with or without float float (type A)



SEWAGE
Vortex SF

**Submersible
 Pump for
 Sewage Water**

Horizontal outlet

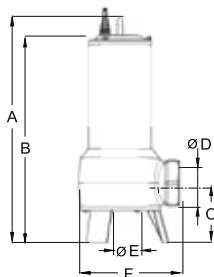
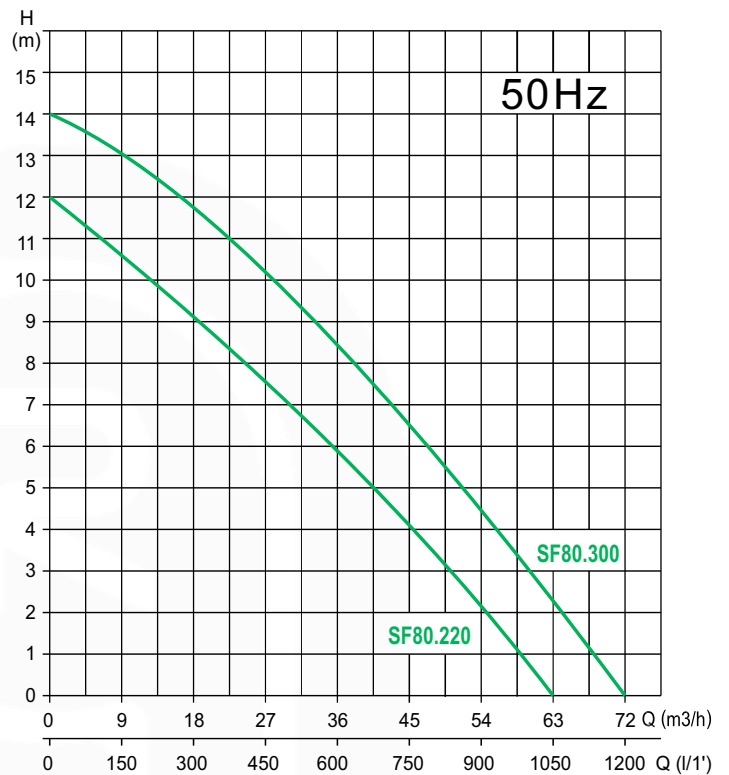

Type	Dimensions (mm)						Weight Kg
	A	B	C	ø D	ø E (passage)	F	
SF 80.150	520	485	145	3"	80	240	28
SF 80.220	535	500					30

Type	Power		Motor			Passage ø mm	Connectin DN	H (max) m	Debit (max) m³/h	Code	
	kW	CV	1~ A	3~ µF	3~ A					1x230v (.1M)	3x400v (.3)
SF 80.220	2,2	3	12,2	50	5	80	3	12	63	01010971	01010973
SF 80.300	3	4	-	-	8			14	72	---	01010974

Power cable: 10 m neoprene

SEWAGE

Range Vortex SV

Submersible
Pump for
Sewage Water

KEY ADVANTAGES OF A VORTEX PUMP:

Incolmatage : The vortex impeller creates a vortex that leads to most solids without contact with the turbine and the fibrous materials are repelled and can not hold on to the turbine.

Minimum wear + consistent performance: The Vortex pump wear is very low because most of the solids pumped passes through the volute without touching the turbine. The yield remains constant over a long period.

Low maintenance + no adjustment: The position of the wheel back in the volute eliminates the risk of blockage and sudden loss of performance. No adjustment is necessary and the cost of maintenance and operation are low and constant.

..... ■ Vortex SV : Horizontal outlet

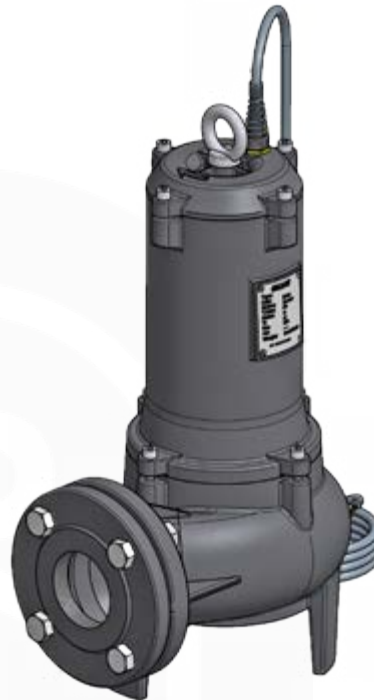

The range **Vortex SF** is designed for pumping of sewage with suspended solids, it is ideal for installation with guide rain.

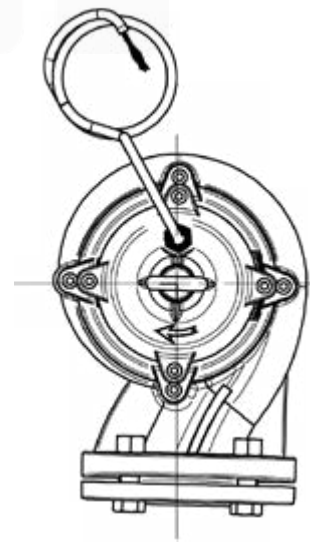
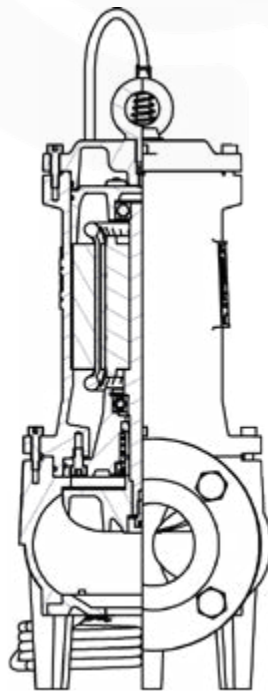

USE :

Water loaded with suspended matter
 All wastewater from homes, including toilets from 65 mm to pass
 Front outlet is ideal for installations with guide rail
 Immersion depth of 10 m

FEATURES :

Protection box in monophasic version.
 Motor casing and volute pump head and impeller in cast iron, stainless steel shaft. Engine oil bath class F, 10 m cable, Double seals, lip seals and mechanical seal **SIC-SIC**



SEWAGE
Vortex SV

**Submersible
 Pump for
 Sewage Water**

Horizontal outlet

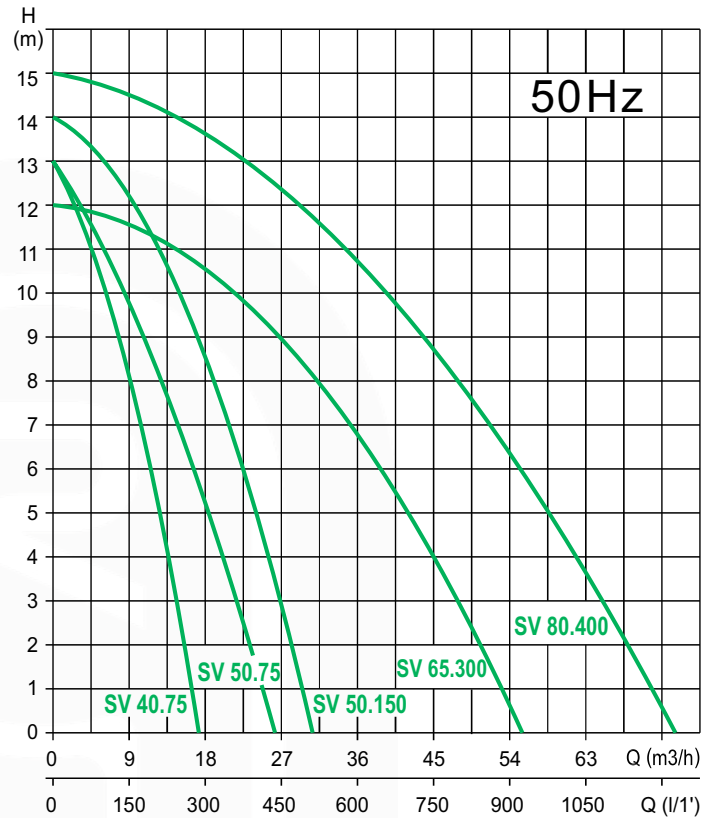
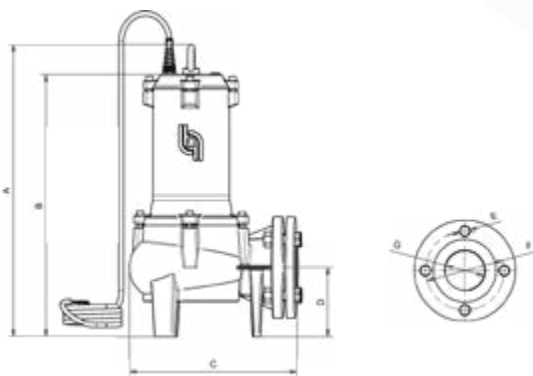

Type	Dimensions (mm)						G	Weight Kg
	A	B	C	D	ø E	ø F		
SV 40.75	443	387	203	84	11	102	1 1/2"	22
SV 50.75	466	410	208	98			2"	23
SV 50.150	492,5	438,5	252	102	13	115	2"	34
SV 65.300	536	481	310	127				2 1/2"
SV 80.400	598	544	309	150,5	18	145	3"	60

Type	Power		Motor			Dna	Dnc	H (max) m	Debit (max) m³/h	Code		
	kW	CV	1~ A	μF	3~ A					1x230v (.1M)	1x230v (.1A)	3x400v (.3)
SV 40.75	0,75	1	4,8	20	1,4	DN40	DN40	13	16	01011181	01011180	01011182
SV 50.75			7,2	20	2,8	DN50	DN50	13	26	01011184	01011183	01011185
SV 50.150	1,5	2	8,6	40	3					14	31	01011187
SV 65.300	3	4	-	-	4,8	DN65	DN65	12	54	---	---	01011066
SV 80.400	4	5,5	-	-	8,8	DN80	DN80	15	70	---	---	01011177

Power cable: 10 m neoprene - Type A: model with float switch

SEWAGE

Gamme Grinder

Submersible
Pump for Sewage
Water With Grinder

The pump OLIJU Grinder is a grinder pump system and is designed for applications of sewage with solids and fibers. The grinder system ensures that all the solids and fibers are broken in small pieces in order to pass in small tubes and passing the centrifugal pump without blocking the rotor.

The grinder system is easy to replace minimizing downtime the pump and making maintenance quick and easy.

Grinder

Grinder

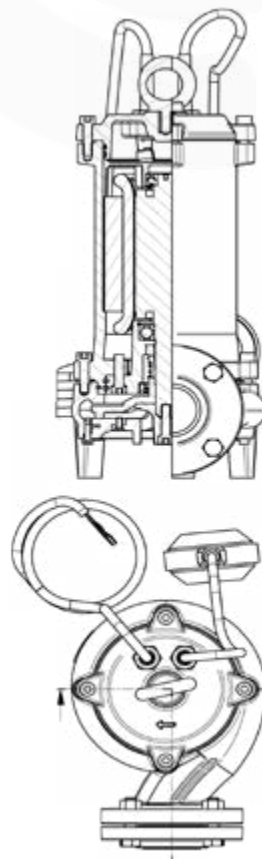

The range **Grinder** is designed for pumping sewage with solids and fibers, it is ideal for installation with guide raid.

USE :

Water loaded with solids and fibers
 All wastewater from homes, including toilets.
 Front outlet is ideal for installations with guide rail
 Immersion depth of 10 m

FEATURES :

Protection box in monophasic version
 Grinder system, impeller in cast iron,
 stainless steel shaft, motor body inox on GR and cas iron on SGR
 Engine oil bath class F
 Double seals, lip seals and reinforced carbon ceramic mechanical seal
 Single-phase models with or without float float (type A)



SEWAGE
Grinder

**Submersible
 Pump for Sewage
 Water With Grinder**

Grinder ■.....

Grinder

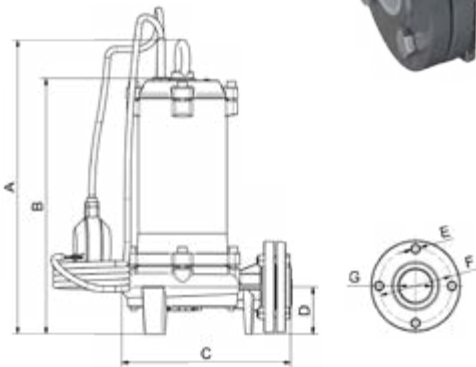
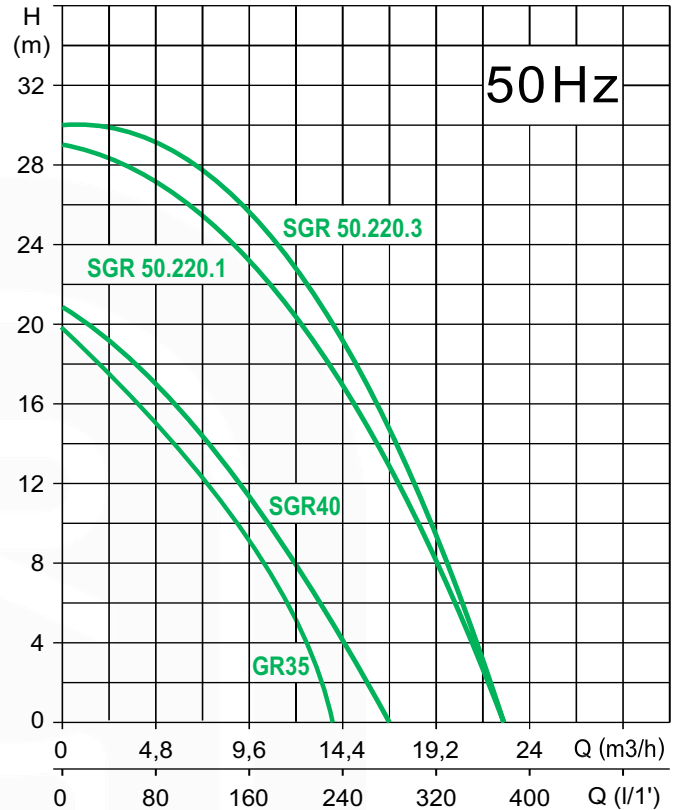

Type	Dimensions (mm)							Weight Kg
	A	B	C	D	øE	øF	G	
GR 35.150	416	366	200	76	10	86	1"1/4	18
GR 35.120	396	346						18
SGR 40.150	404	352	237	65	11	102	1"1/2	26,5
SGR 40.120								
SGR 50.220	470	415	294	95	13	110	2"	36

Type	Power		Motor			Connection DN	H (max) m	Debit (max) m³/h	Code		
	kW	CV	1~ A	3~ µF	3~ A				1x230v (.1M)	1x230v (.1A)	3x400v (.3)
GR 35.150	1,5	2	8,7	35	-	1 1/4	20	13,8	01010989	01010990	---
GR 35.120	1,2	1,6	-	-	2,8				---	--	01010991
SGR 40.150	1,5	2	7,2	35	-	1 1/2	21	16,5	01011031	01011032	--
SGR 40.120	1,2	1,6	-	-	2,1				--	--	01011033
SGR 50.220	2,2	3	10	40	4,6	2	30	32,2	01011074	--	01011061

Power cable: 10 m neoprene for GR and SGR 40, 20m neoprene for SGR 50 - Type A: model with float switch

SEWAGE MC

Submersible Pump for Sewage Water

USE:

Pumping of sewage and industrial water
The impeller single channel allows the passage of solids and reduces the risk of clogging
Particle diameter: 50 mm for MC 50 and 65 mm for the MC 65
Immersion depth of 10 m

FEATURES:

Casing and pump body in special cast iron, cast iron wheel single-channel
Motor shaft in stainless steel AISI420
Engine oil bath, insulation class F. 20 m power cable neoprene
Double seals, lip seals and reinforced carbon ceramic mechanical seal



Single-channel impeller

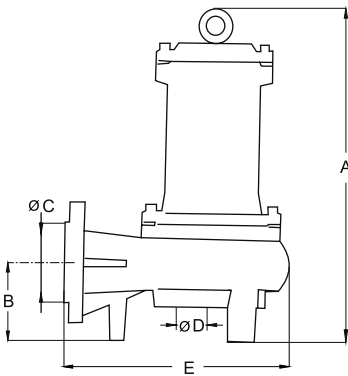
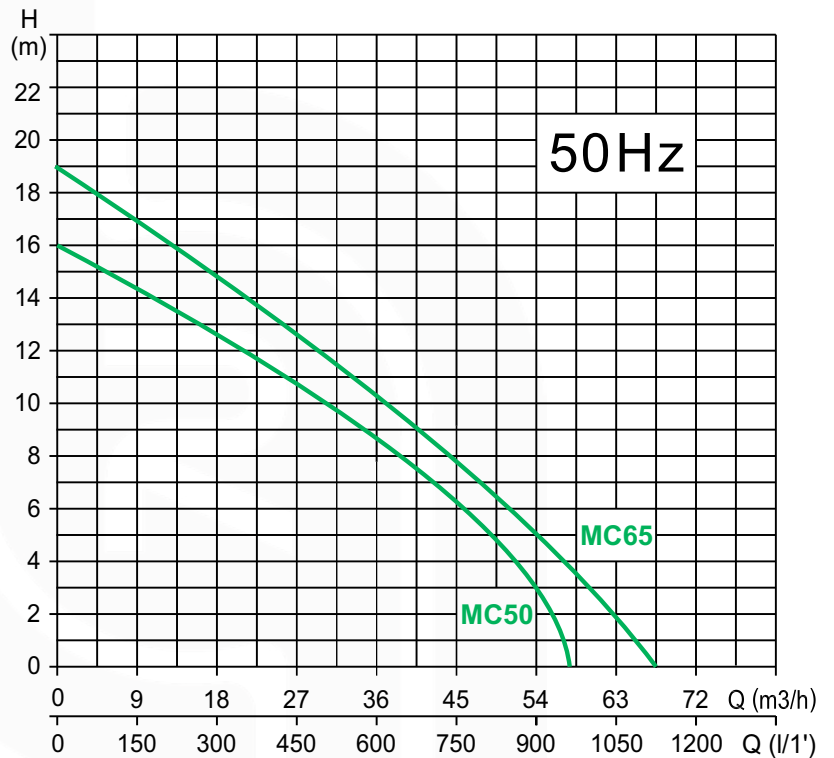

Type	Dimensions (mm)					Weight Kg
	A	B	øC	øD	E	
MC 50.220	511	116	DN 65	DN 50	340	45
MC 65.300				DN 65		46

Type	Power		Motor		Passage	H (max)	Debit (max)	Code
	kW	CV	A	μF	DN	m	m³/h	
MC 50.220	2,2	3,0	4,2	-	50	16	58	01330001
MC 65.300	3,0	4,0	4,8	-	65	19	67,5	01010992

USE :

The guide rail facilitate maintenance operations, allowing you to remove the pump without draining the tank

FEATURES :

Cast iron
rubber seals

**For pumps
horizontal
outlet**

Guide rail

Guide

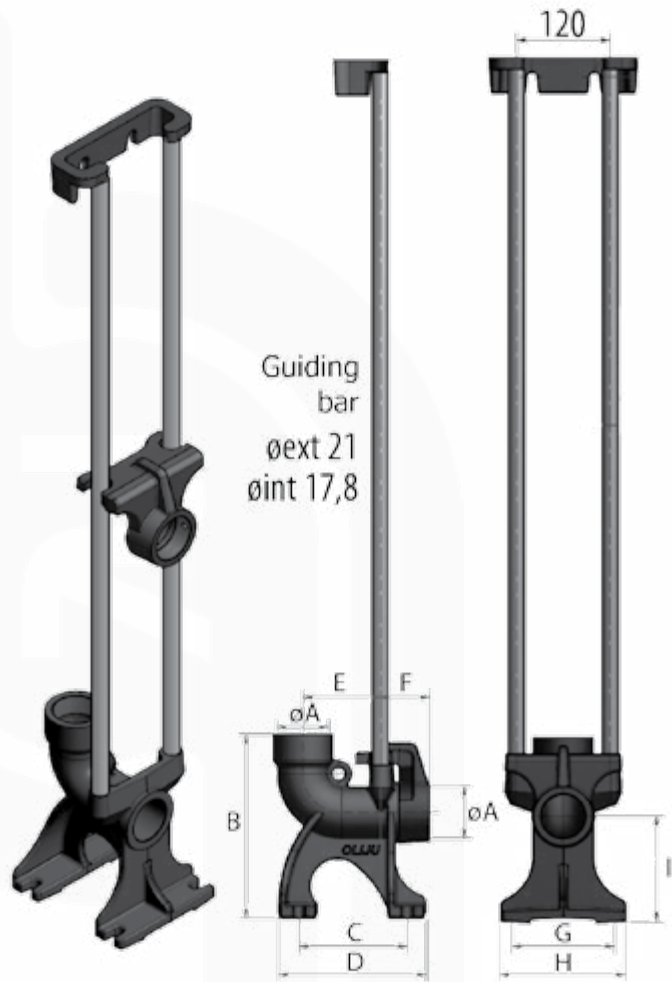

Type	Dimensions (mm)								
	ø A	B	C	D	E	F	G	H	I
Guide Rail 50	2"	235	140	190	100	63,5	130	160	135
Guide Rail 65	2" ½	285	166	220	119	68	150	180	165
Guide Rail 80	3"	298	174	229	119	68	180	210	175

Type	Code
Guide Rail 50 (without the guide bars) for sewage pumps passage ø 50	01950934
Guide Rail 65 (without the guide bars) for sewage pumps passage ø 65	01950935
Guide Rail 80 (without the guide bars) for sewage pumps passage ø 80	01950957

WELLS

Range Aqualiju

Well
Pumps
stainless steel

The range of well pumps multistage AQUALIJU benefits from the latest technological advances. Its vacuum system ensures the engine's cooling by channeling water in a jacket.

The combination of stainless steel for the turbines and glass fiber reinforced NORYL for broadcasters, provides excellent resistance to abrasion due to sand for maximum efficiency.

Aqualiju

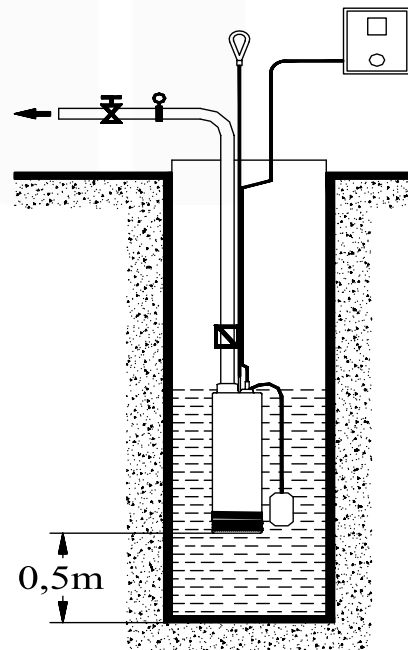
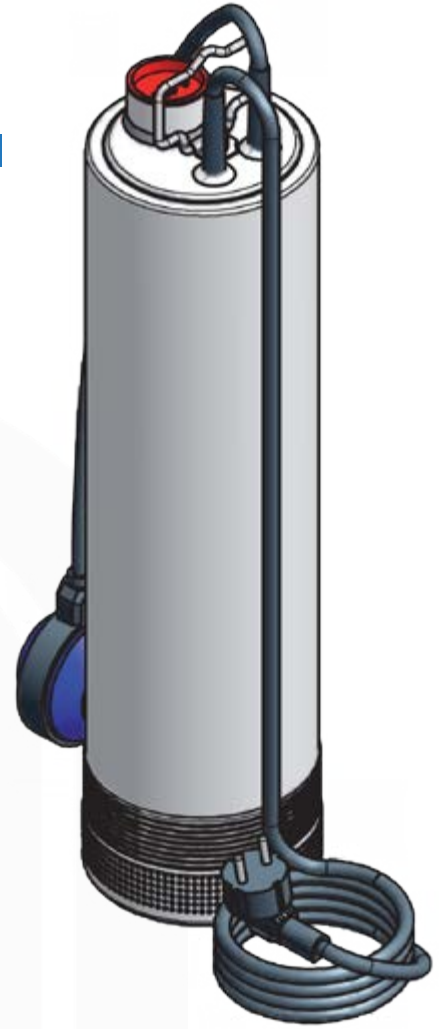
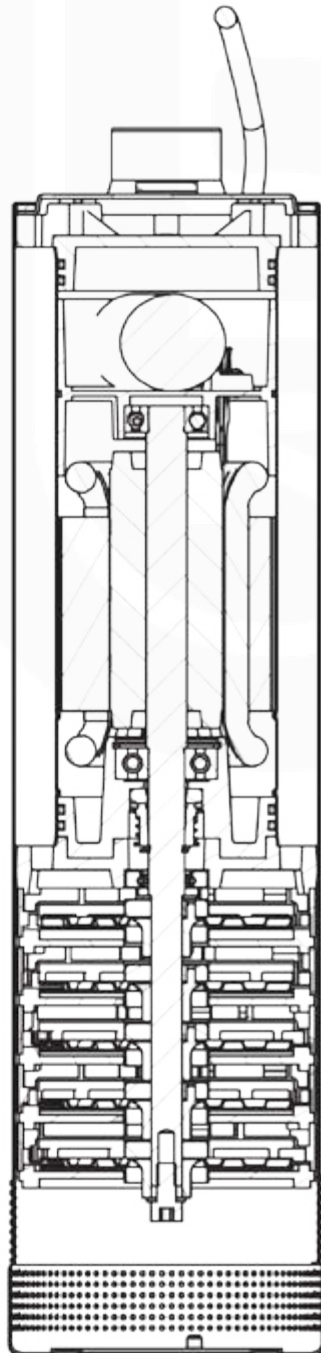
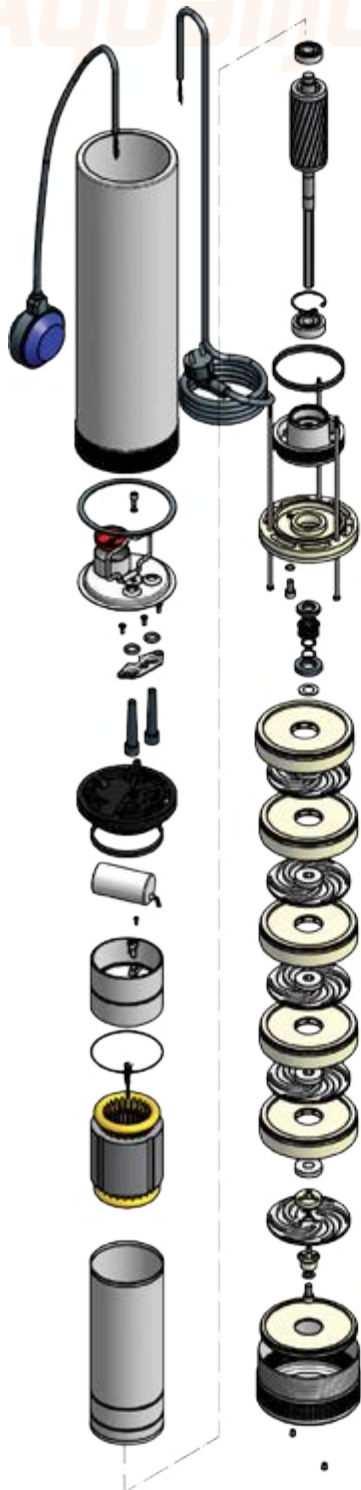

USE :

Domestic, agricultural, industrial, irrigation - Transfer and pressure
 Maximum fluid temperature: 35° C
 Sand content capacity: 60 g/m³
 Maximum number of start-up time: 30 / h

FEATURES :

Asynchronous single-phase 230 V, three phase 400 V - Class F
 Engine oil immersed food, non-toxic, non-polluting
 Stainless steel shaft 420B - Protection IP 58
 Strainer, motor casing, pump head stainless steel 304
 Double sealing lip seal reinforced and carbon ceramic mechanical seal
 Possibility of SIC / SIC on request



WELLS

Aqualiju AJ

**Well pump
 for clean water
 - Series Inox -**

4" 1/2

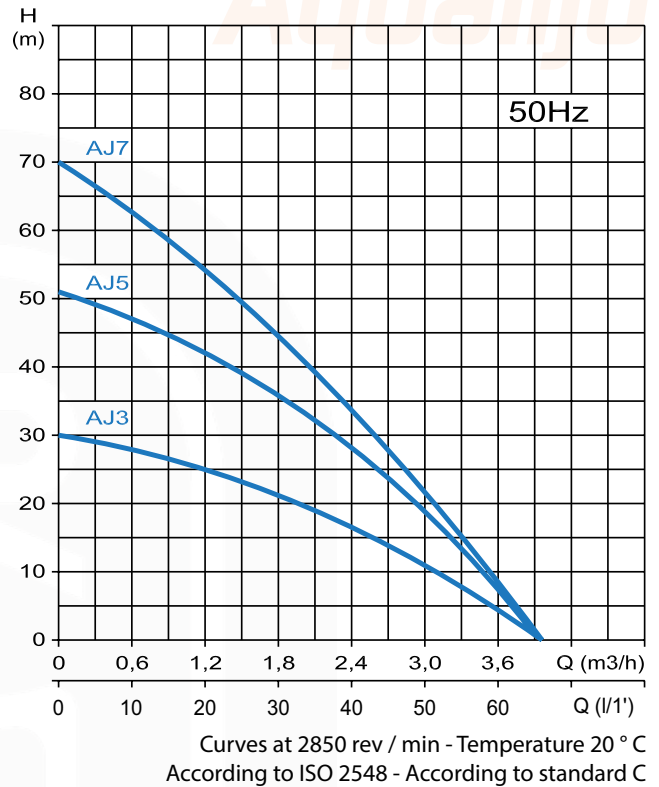
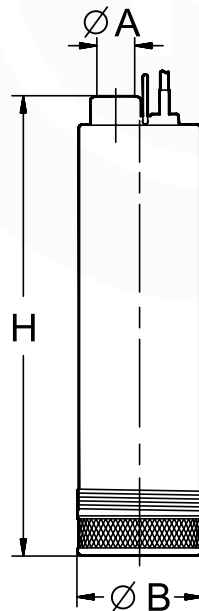

Type	Dimensions (mm)			Weight Kg
	øA	øB	H	
AJ 3.37	1"	117	360	8,5
AJ 5.60			420	10,5
AJ 7.90			470	12,0

Type	Power		Motor			Outlet DN	H (max) m	Debit (max) m ³ /h	Code		
	kW	CV	1~ A	μF	3~ A				1x230v (.1M)	1x230v (.1A)	3x400v (.3)
AJ 3.37	0,37	0,5	2,6	12	1,2	1"	30	3,9	01010461	01010455	01010609
AJ 5.60	0,6	0,8	4,1	16	1,4		50		01010462	01010409	01010611
AJ 7.90	0,9	1,2	5,8	20	2,1		70		01010483	01010456	01010469

Built-in capacitor for single-phase models- Type A: model with float switch

WELLS

Aqualiju A

Well pump for clean water - Series Inox -

USE:

Domestic, agricultural, industrial, irrigation - Transfer and pressure

Maximum fluid temperature: 35° C

Sand content capacity: 60 g/m³

Maximum number of start-up time: 30 / h

FEATURES :

Asynchronous single-phase 230 V, three phase 400 V - Class F

Engine oil immersed food, non-toxic, non-polluting

Stainless steel shaft 420B - Protection IP 58

Strainer, motor casing, pump head stainless steel 304

Double sealing lip seal reinforced and carbon ceramic mechanical seal

Possibility of SIC / SIC on request

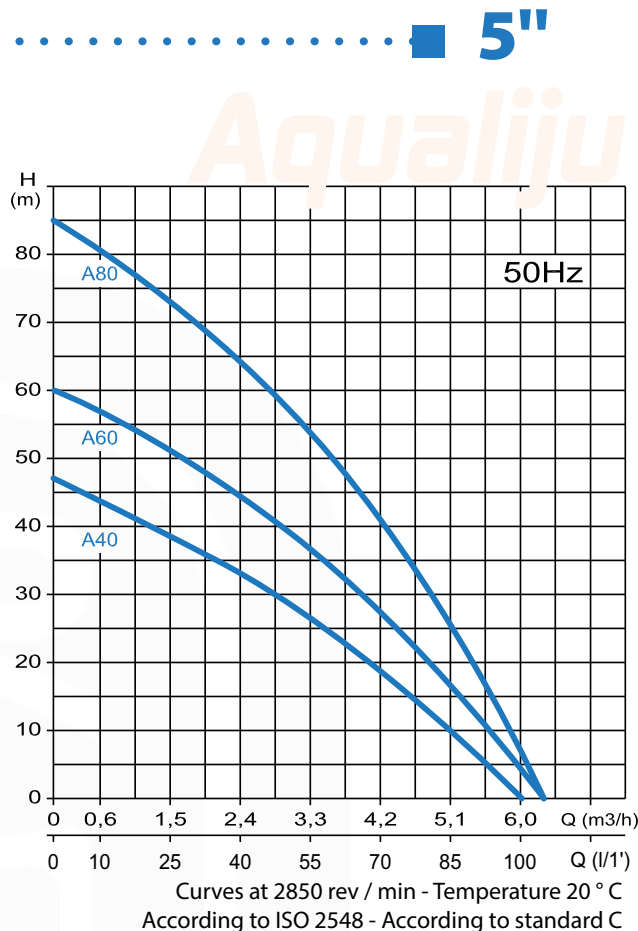
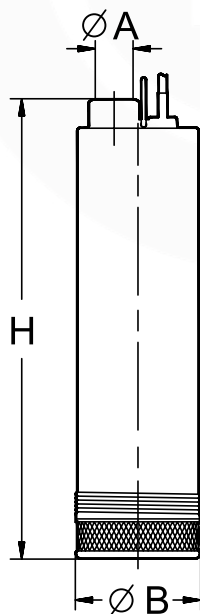

Type	Dimensions (mm)			Weight Kg
	øA	øB	H	
A 40.60	1" ¼	128	470	12,5
A 60.90			505	13,0
A 80.130			580	16,0

Type	Power		Motor			Outlet DN	H (max) m	Debit (max) m ³ /h	Code		
	kW	CV	1~ A	1~ μF	3~ A				1x230v (.1M)	1x230v (.1A)	3x400v (.3)
A 40.60	0,6	0,8	4,6	16	1,8	1" ¼	47	6,0	01010922	01010948	01010924
A 60.90	0,9	1,2	6,0	20	2,3		60		01010925	01010926	01010927
A 80.130	1,3	1,8	8,4	30	3,0		85		01010928	01010929	01010930

Built-in capacitor for single-phase models- Type A: model with float switch

USE :

Domestic, agricultural, industrial, irrigation - Transfer and pressure
 Maximum fluid temperature: 35° C
 Sand content capacity: 60 g/m³
 Maximum number of start-up time: 30 / h

FEATURES :

Asynchronous single-phase 230 V, three phase 400 V - Class F
 Engine oil immersed food, non-toxic, non-polluting
 Stainless steel shaft 420B - Protection IP 58
 Strainer, motor casing, pump head stainless steel 304
 Double sealing lip seal reinforced and carbon ceramic mechanical seal
 Possibility of SIC / SIC on request



WELLS
Aqualiju AC/AB

**Well pump
 for clean water
 - Series Inox -**

6" ■

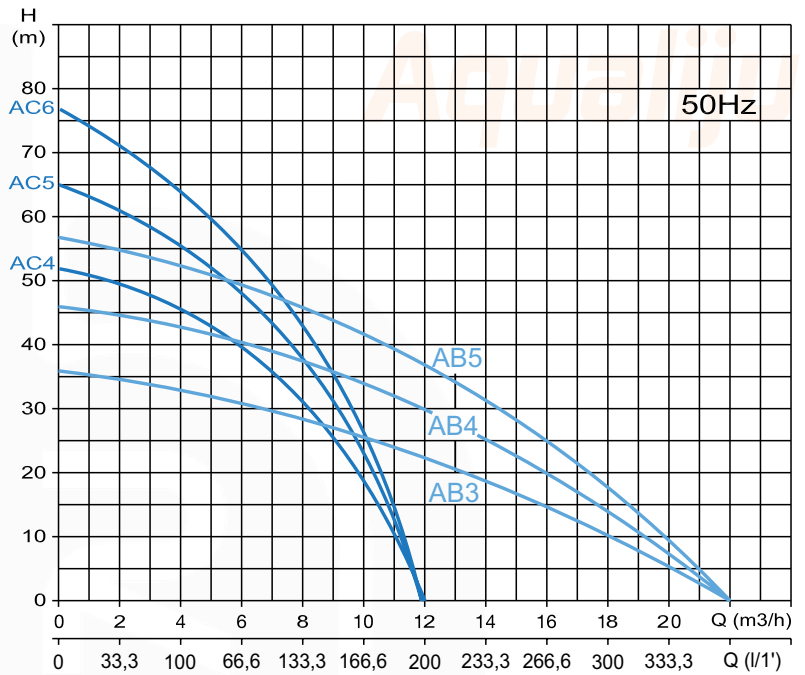
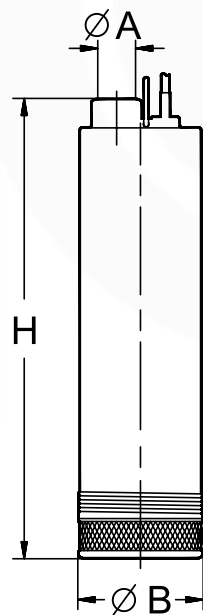

Curves at 2850 rev / min - Temperature 20 ° C
 According to ISO 2548 - According to standard C

Type	Dimensions (mm)			Weight Kg
	øA	øB	H	
AC 4.110	1" 1/2	150	450	21,0
AC 5.150			475	22,0
AC 6.220			515	23,5
AB 3.150	2"	150	486	22,0
AB 4.220			536	23,5
AB 5.300			570	25,0

Type	Power		Motor			Outlet DN	H (max) m	Debit (max) m³/h	Code		
	kW	CV	1~ A	μF	3~ A				1x230v (.1M)	1x230v (.1A)	3x400v (.3)
AC 4.110	1,1	1,5	10	40	3,9	1" 1/2	53	12	01010705	01010446	01010621
AC 5.150	1,5	2	12	50	4,6				01010578	01010447	01010575
AC 6.220	2,2	3	14	50	5,0				01010577	01010820	01010566
AB 3.150	1,5	2	11	50	3,6	2"	36	22	01011006	01011007	01011008
AB 4.220	2,2	3	12	50	4,2				01011009	--	01011010
AB 5.300	3,0	4	-	-	6				--	--	01011011

Built-in capacitor for single-phase models- Type A: model with float switch

CISTERN

Range Aqualiju

Pumps for
Cisterns
stainless steel

The range of well pumps multistage AQUALIJU benefits from the latest technological advances. Its vacuum system ensures the engine's cooling by channeling water in a jacket.

The combination of stainless steel for the turbines and glass fiber reinforced NORYL for broadcasters, provides excellent resistance to abrasion due to sand for maximum efficiency. The lower guide, in Noryl, of shaft and the rubber feet on the bottom of the pump reduce vibration making it suitable for direct installation at the bottom of tanks.

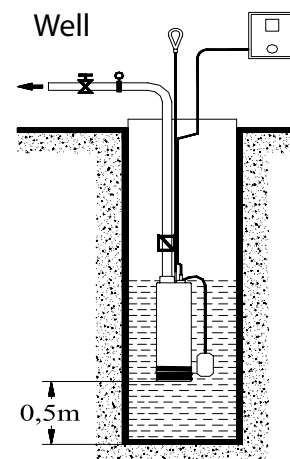
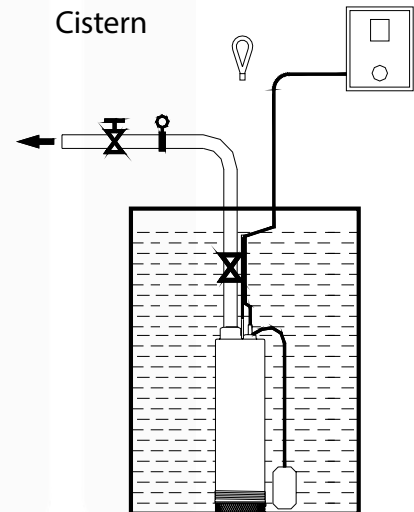
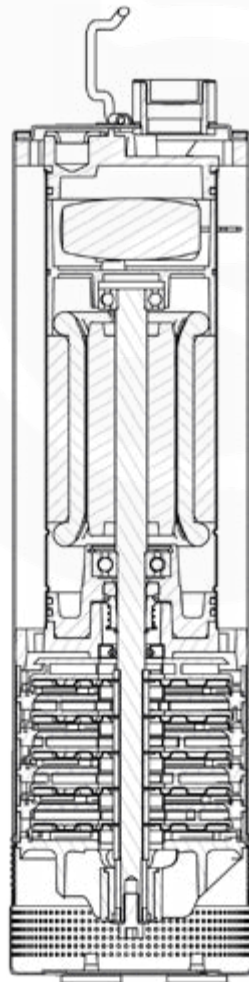

USE :

Domestic, agricultural, industrial, irrigation - Transfer and pressure
 Maximum fluid temperature: 35° C
 Sand content capacity: 60 g/m³
 Maximum number of start-up time: 30 / h

FEATURES :

Asynchronous single-phase 230 V, three phase 400 V - Class F
 Engine oil immersed food, non-toxic, non-polluting
 Stainless steel shaft 420B - Protection IP 58
 Strainer, motor casing, pump head stainless steel 304
 Double sealing lip seal reinforced and carbon ceramic mechanical seal
 Possibility of SIC / SIC on request



CISTERN

Aqualiju SA

**Pumps for
 Cisterns
 - Series Inox -**

5"

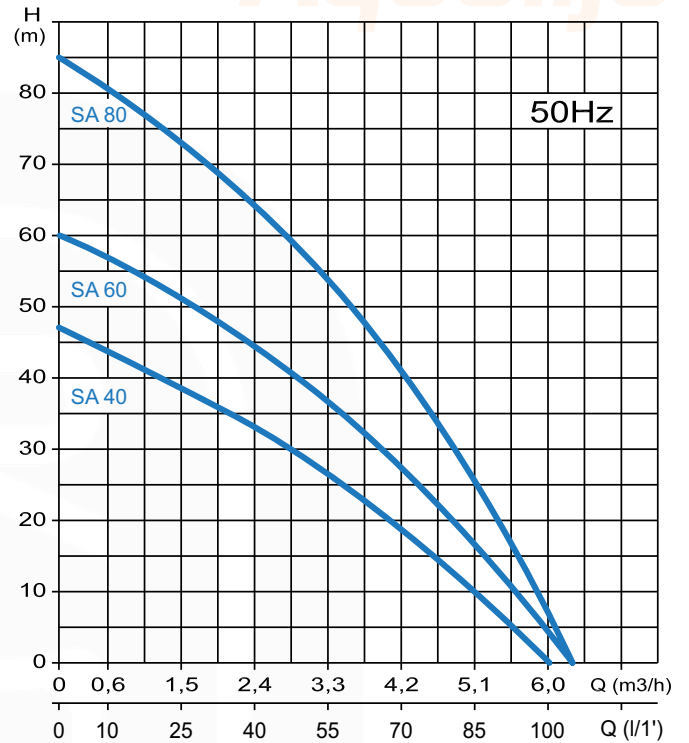
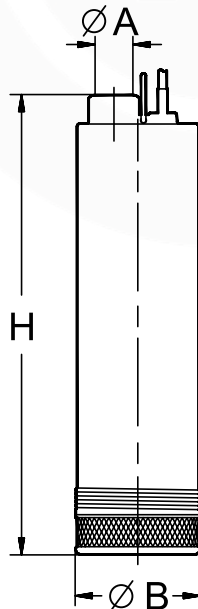

Type	Dimensions (mm)			Weight
	øA	øB	H	Kg
SA 40.60	1" ¼	128	470	12,5
SA 60.90			505	13,0
SA 80.130			580	16,0

Type	Power		Motor			Outlet DN	H (max) m	Debit (max) m³/h	Code		
	kW	CV	1~ A	1~ µF	3~ A				1x230v (.1M)	1x230v (.1A)	3x400v (.3)
SA 40.60	0,6	0,8	4,6	16	1,8	1" ¼	47	6,0	01011040	01011041	01011042
SA 60.90	0,9	1,2	6,0	20	2,3		60		01011043	01011044	01011045
SA 80.130	1,3	1,8	8,4	30	3,0		85		01011046	01011047	01011048

Built-in capacitor for single-phase models- Type A: model with float switch

CISTERN

Range AquaRain

Pumps for
Cisterns
stainless steel

The range of cistern pumps multistage AQUARAIN benefits from the latest technological advances. Its vacuum system ensures the engine's cooling by channeling water in a jacket.

The combination of stainless steel for the turbines and glass fiber reinforced NORYL for broadcasters, provides excellent resistance to abrasion due to sand for maximum efficiency. The lower guide, in Noryl, of shaft and the rubber feet on the bottom of the pump reduce vibration making it suitable for direct installation at the bottom of tanks.

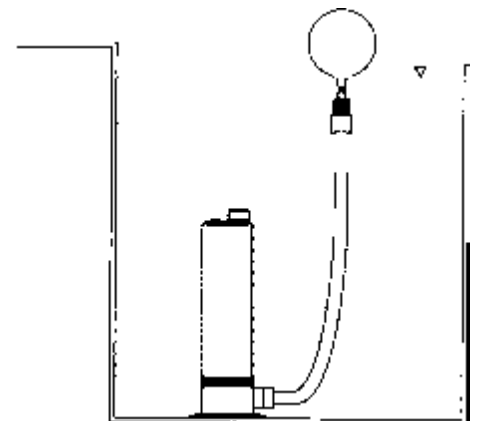
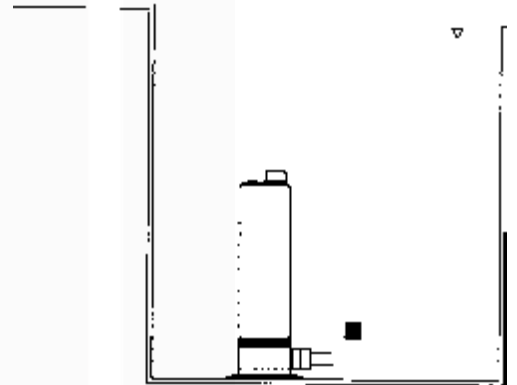
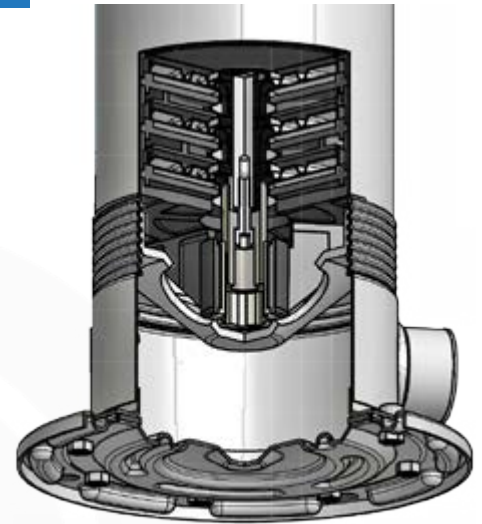
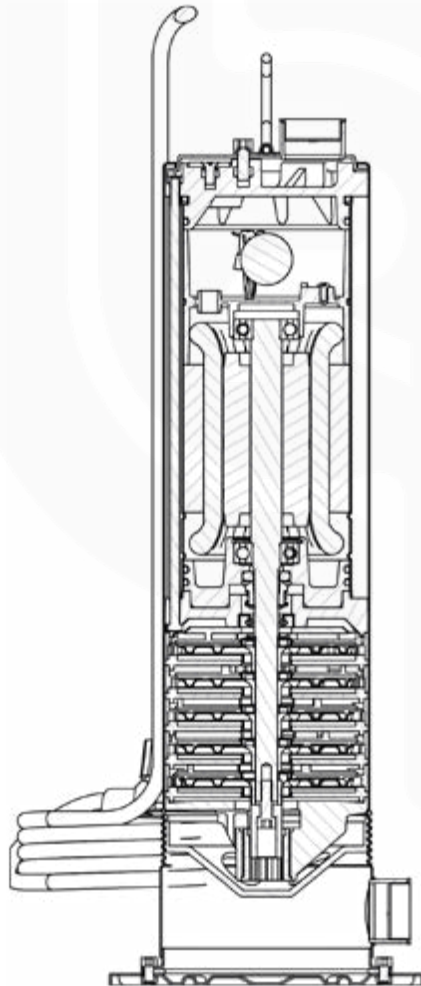

USE :

Domestic, agricultural, industrial, irrigation - Transfer and pressure

Maximum fluid temperature: 35° C

Sand content capacity: 60 g/m3

Maximum number of start-up time: 30 / h

FEATURES :

Asynchronous single-phase 230 V, three phase 400 V - Class F

Engine oil immersed food, non-toxic, non-polluting

Stainless steel shaft 420B - Protection IP 58

Strainer, motor casing, pump head stainless steel 304

Double sealing lip seal reinforced and carbon ceramic mechanical seal

Possibility of SIC / SIC on request

CISTERN

AquaRain RJ

**Pumps for
Cisterns
- Series Inox -**



4" 1/2

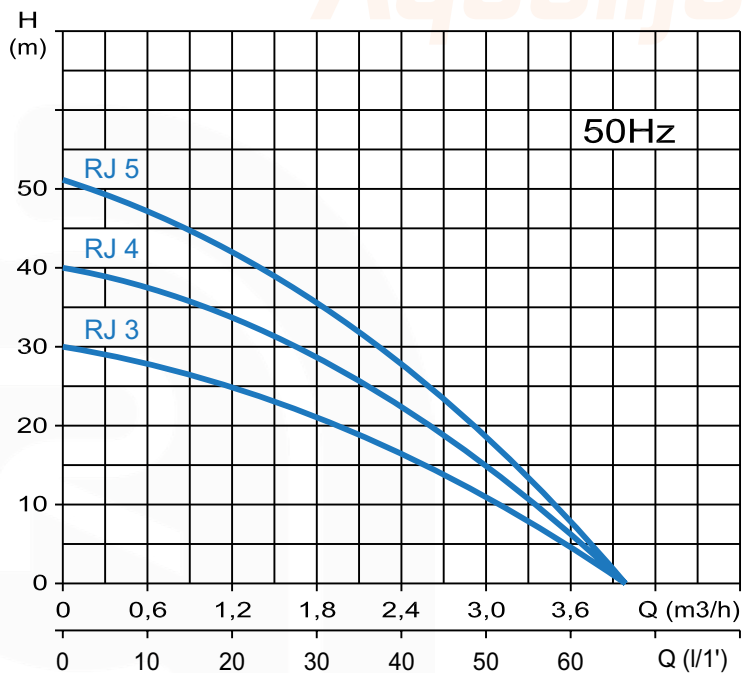

Type	Dimensions (mm)							Weight Kg
	A	B	øC	øD	øE	øF	øG	
RJ 3.37	413,5							8,3
RJ 4.60	449,5	40	1"	1"	170	152,5	8,5	9,6
RJ 5.60	469,5							9,8

Type	Power		Motor			Outlet DN	H (max) m	Debit (max) m³/h	Code	
	kW	CV	1~ A	μF	3~ A				1x230v (.1M)	3x400v (.3)
RJ 3.37	0,37	0,5	2,6	12	1,2	1"	30	3,9	01011170	01011171
RJ 4.60	0,6	0,8	3,3	14	1,4		40		01011172	01011173
RJ 5.60			4,1	16	1,4		50		01011174	01011175

Built-in capacitor for single-phase models- Type A: model with float switch

BOREHOLE

Range SFI

Pumps for borehole 4"

Borehole pumps SFI 4" are multistage centrifugal pumps with hydraulic turbine radial float.

Borehole pump for domestic and industrial use in continuous or intermittent. Automatic operation with reservoir, irrigation, fire system, fountain, etc ...

For any operating point outside the selected curves, do not hesitate to ask us. OLIJU has a full range from 1 to 13.5 m³ / h and 10 to 285 m.



The check valve is built into the pump head to protect the impellers and diffusers against the hydraulic hammer and the weight of the water column. Special profile limiting the losses.



Head and foot pump made of stainless steel for better corrosion resistance. NEMA motor coupling rigid generously sized for excellent mechanical strength.



Outer envelope, electric cable protection, strainer and coupling flange motor in stainless steel.



Turbines and broadcasters are polycarbonate reinforced with specific surface treatment and stainless steel insert. The hexagonal shaft and coupling are also stainless steel.



The engine water bath Franklin is in a resin impregnated coil (single phase double capacitor on request).



SFI

BOREHOLE Kit SFI

Kit pompe of borehole for borehole 4"

LE KIT COMPREND :

- Foot and pump head, stainless steel
- Pump + Franklin motor + brass primer
- Initiation of stainless steel cable on request (extra € 5 HT)
- Start Box for single phase pumps
- Tight connection
- 15 m of cord and electrical cable 4 x 1 mm²
- 30 m of cord and electrical cable 4 x 1,5 mm²
- 40 m of cord and electrical cable 4 x 2,5 mm²



Kit SFI

Type	Electrical characteristics				H (ml)	Hydraulic characteristics									
	Tension V	Power		Cable ml		Q (m ³ /h)									
		kW	CV			0	0,9	1,8	2,4	3	4,2	4,8	5,4	6	
K-SFIB 5.37.1	1 x 230	0,37	0,5	15	H (ml)	53	47	33	23	10	0	-	-	-	
K-SFIB 7.55.1	1 x 230	0,55	0,75	15		70	61	47	32	14	0	-	-	-	
K-SFIB 7.55.3	3 x 400	0,55	0,75	15		70	61	47	32	14	0	-	-	-	
K-SFIB 10.75.1	1 x 230	0,75	1	30		95	82	60	42	18	0	-	-	-	
K-SFIB 10.75.3	3 x 400	0,75	1	30		95	82	60	42	18	0	-	-	-	
K-SFIB 15.110.1	1 x 230	1,1	1,5	40		150	122	88	59	26	0	-	-	-	
K-SFIB 15.110.3	3 x 400	1,1	1,5	40		150	122	88	59	26	0	-	-	-	
K-SFIC 7.55.1	1 x 230	0,55	0,75	15	H (ml)	48	45	43	40	36	23	14	0	-	
K-SFIC 7.55.3	3 x 400	0,55	0,75	15		48	45	43	40	36	23	14	0	-	
K-SFIC 10.75.1	1 x 230	0,75	1	30		76	72	67	61	54	38	24	0	-	
K-SFIC 10.75.3	3 x 400	0,75	1	30		76	72	67	61	54	38	24	0	-	
K-SFIC 15.110.1	1 x 230	1,1	1,5	40		112	108	100	91	80	50	30	0	-	
K-SFIC 15.110.3	3 x 400	1,1	1,5	40		112	108	100	91	80	50	30	0	-	
K-SFID 7.55.1	1 x 230	0,55	0,75	15	H (ml)	37	36	34	32	30	25	21	17	12	
K-SFID 7.55.3	3 x 400	0,55	0,75	15		37	36	34	32	30	25	21	17	12	
K-SFID 10.75.1	1 x 230	0,75	1	15		53	52	50	48	44	35	30	24	17	
K-SFID 10.75.3	3 x 400	0,75	1	15		53	52	50	48	44	35	30	24	17	
K-SFID 15.110.1	1 x 230	1,1	1,5	30		80	76	73	70	67	55	48	40	30	
K-SFID 15.110.3	3 x 400	1,1	1,5	30		80	76	73	70	67	55	48	40	30	

BOREHOLE SFI A

Borehole pump 4" Inox Head

USE :

Borehole pump for domestic and industrial use in continuous or intermittent operation (automatic eith reservoir, irrigation, fire system, fountain, etc ...)

FEATURES :

Multistage radial turbine pump with hydraulic float
The component materials are resistant to abrasion and corrosion and are environmentally friendly (non toxic):
head and foot pump stainless steel, impeller and diffuser in polycarbonate reinforced with specific surface treatment, stainless steel insert, hexagonal shaft , coupling, valve, shirt and cable protection in 304
Engine water bath Franklin, and winding impregnated in a resin, brass primer



Nominal flow 1,5 m³/h



SFI

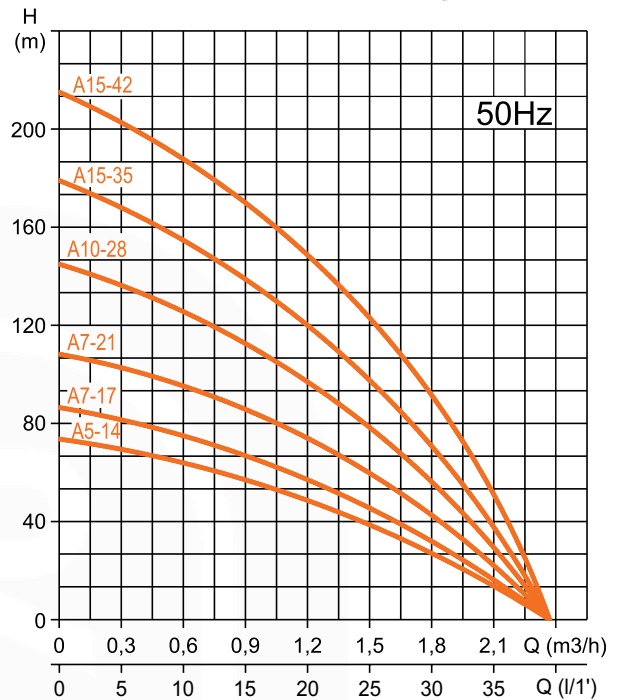
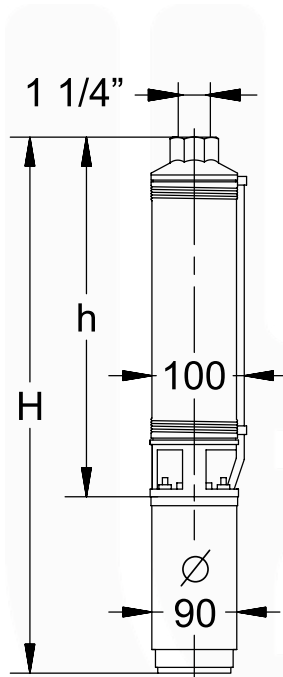

Selection curves: 2850 r / min, water at 20 ° C, according to ISO 2548 standard and C

Type	Dimensions (mm)			Weight Kg Pump	Weight Motor + Pump Kg	
	h	H · Mono	H · Tri		Mono	Tri
SFI A 5.37.	680	922	903	4,75	13,05	12,05
SFI A 6.55.	770	1041	1012	5,40	15,00	13,70
SFI A 7.55.	890	1160	1132	6,25	15,85	14,55
SFI A 10.75.	1097	1395	1368	7,10	17,90	16,70
SFI A 15.110.	1350	1677	1648	8,33	20,43	19,13
SFI A 20.110.	1610	1937	1908	10,30	22,40	21,10

Type	Power		Motor			Connection DN	H (max) m	Debit (max) m ³ /h	Code				
	kW	CV	A	1~ μF	3~ A				1x230v (.1)	3x400v (.3)			
SFI A 5.37	0,37	0,5	3,3	18	1,1	1" ¼	74	2,3	01010192	01010193			
SFI A 6.55													
SFI A 7.55	0,55	0,75	5,0	20	1,6						87	01010194	01010195
SFI A 10.75													
SFI A 15.110	0,75	1	6,5	40	2,2						109	01010196	01010197
SFI A 20.110													
SFI A 5.37	0,75	1	9,4	50	3,2	145	01010198	01010199					
SFI A 6.55													
SFI A 7.55	1,1	1,5	9,4	70	3,2	179	01010200	01010201					
SFI A 10.75													
SFI A 15.110	1,1	1,5	9,4	70	3,2	215	01010202	01010203					
SFI A 20.110													

Integrated capacitor for single-phase - Initiation of stainless steel cable on request

USE :

Borehole pump for domestic and industrial use in continuous or intermittent operation (automatic eith reservoir, irrigation, fire system, fountain, etc ...)

FEATURES :

Multistage radial turbine pump with hydraulic float
 The component materials are resistant to abrasion and corrosion and are environmentally friendly (non toxic):
 head and foot pump stainless steel, impeller and diffuser in polycarbonate reinforced with specific surface treatment,
 stainless steel insert, hexagonal shaft , coupling, valve, shirt and cable protection in 304
 Engine water bath Franklin, and winding impregnated in a resin, brass primer



BOREHOLE

SFI B

Borehole pump
4" Inox Head

Nominal flow 2,5 m³/h



SFI

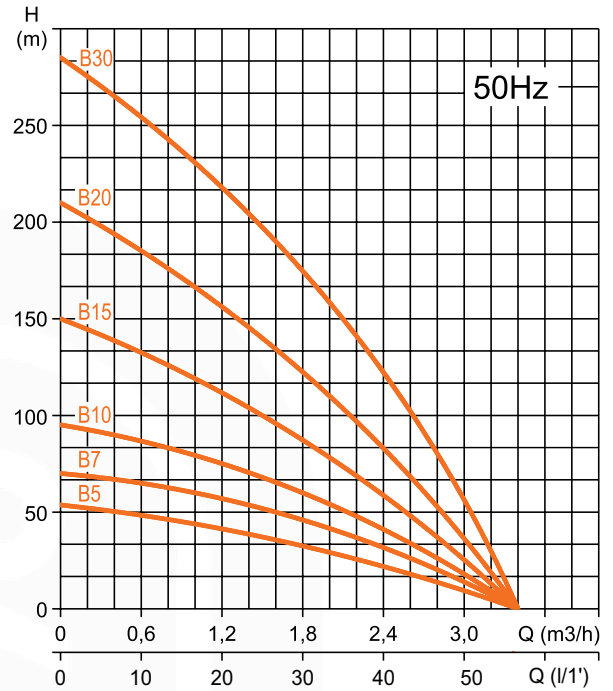
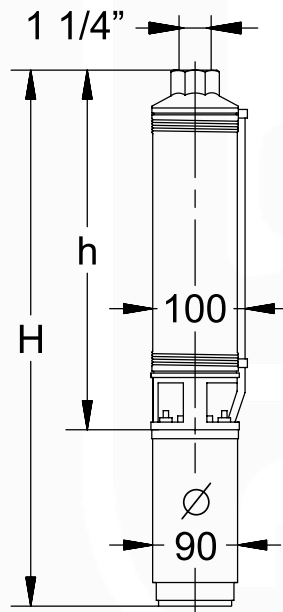

Selection curves: 2850 r / min, water at 20 ° C, according to ISO 2548 standard and C

Type	Dimensions (mm)			Weight Kg Pump	Weight Motor + Pump Kg	
	h	H • Mono	H • Tri		Mono	Tri
SFI B 5.37.	560	802	783	4,20	12,50	11,50
SFI B 7.55.	650	921	892	4,60	14,20	12,90
SFI B 10.75.	800	1098	1071	5,50	16,30	15,10
SFI B 15.110.	1035	1362	1333	6,80	18,90	17,60
SFI B 20.150.	1380	1736	1707	8,45	21,95	20,55
SFI B 30.220.	1850	2310	2206	12,20	30,20	25,70

Type	Power		Motor			Connection DN	H (max) m	Debit (max) m ³ /h	Code	
	kW	CV	A	1~ μF	3~ A				1x230v (.1)	3x400v (.3)
SFI B 5.37	0,37	0,5	3,3	16	1,1	1" 1/4	60	3,2	01010204	01010205
SFI B 7.55	0,55	0,75	5,0	20	1,6				01010206	01010207
SFI B 10.75	0,75	1	6,5	35	2,2				01010208	01010209
SFI B 15.110	1,1	1,5	9,4	40	3,2				01010210	01010211
SFI B 20.150	1,5	2	11,2	50	4,1				01010212	01010213
SFI B 30.220	2,2	3	15,1	70	5,8				01010214	01010215

Integrated capacitor for single-phase - Initiation of stainless steel cable on request

BOREHOLE SFI C

Borehole pump 4" Inox Head

USE :

Borehole pump for domestic and industrial use in continuous or intermittent operation (automatic eith reservoir, irrigation, fire system, fountain, etc ...)

FEATURES :

Multistage radial turbine pump with hydraulic float
The component materials are resistant to abrasion and corrosion and are environmentally friendly (non toxic):
head and foot pump stainless steel, impeller and diffuser in polycarbonate reinforced with specific surface treatment, stainless steel insert, hexagonal shaft , coupling, valve, shirt and cable protection in 304

Engine water bath Franklin, and winding impregnated in a resin, brass primer



Nominal flow 4 m³/h



SFI

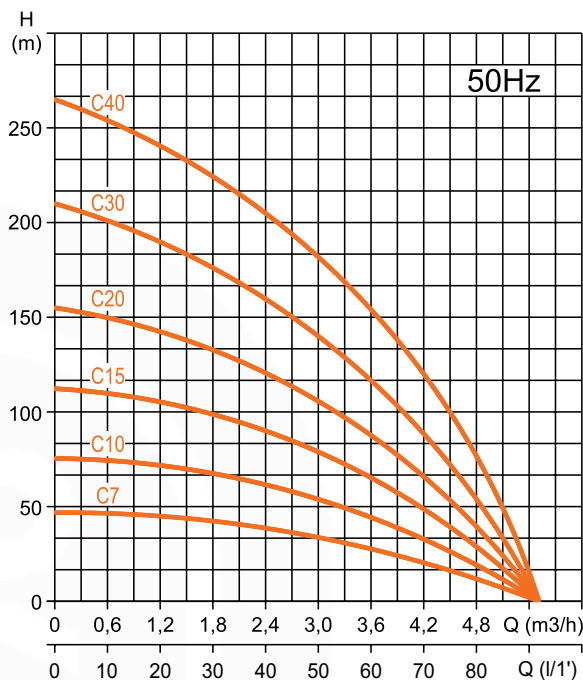
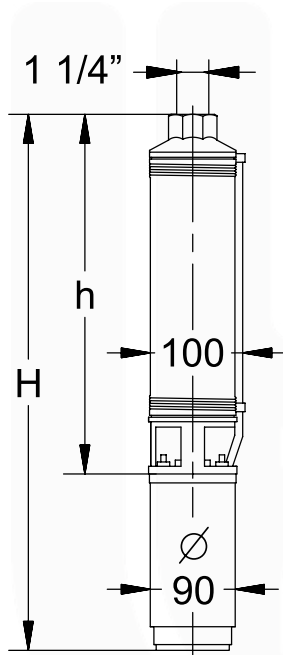

Selection curves: 2850 r / min, water at 20 ° C, according to ISO 2548 standard and C

Type	Dimensions (mm)			Poids Kg	Poids Moteur + Pompe Kg	
	h	H · Mono	H · Tri	Pump	Mono	Tri
SFI C 7.55.	495	766	737	3,90	13,50	12,20
SFI C 10.75.	650	948	920	4,68	15,48	14,28
SFI C 15.110.	830	1157	1128	5,60	17,70	16,40
SFI C 20.150.	1035	1390	1362	6,91	20,41	19,01
SFI C 30.220.	1350	1810	1706	8,52	26,52	22,02
SFI C 40.300.	1670	-	2093	10,72	-	26,72

Type	Power		Motor			Connection DN	H (max) m	Debit (max) m ³ /h	Code	
	kW	CV	1~ A	3~ μF	3~ A				1x230v (.1)	3x400v (.3)
SFI C 7.55	0,55	0,75	5,0	20	1,6	1" 1/4	48	5	01010216	01010217
SFI C 10.75	0,75	1	6,5	35	2,2				01010218	01010219
SFI C 15.110	1,1	1,5	9,4	40	3,2				01010220	01010221
SFI C 20.150	1,5	2	11,2	50	4,1				01010222	01010223
SFI C 30.220	2,2	3	15,1	70	5,8				01010224	01010225
SFI C 40.300	3	4	-	-	7,2				--	01010226

Integrated capacitor for single-phase - Initiation of stainless steel cable on request

USE :

Borehole pump for domestic and industrial use in continuous or intermittent operation (automatic eith reservoir, irrigation, fire system, fountain, etc ...)

FEATURES :

Multistage radial turbine pump with hydraulic float
 The component materials are resistant to abrasion and corrosion and are environmentally friendly (non toxic):
 head and foot pump stainless steel, impeller and diffuser in polycarbonate reinforced with specific surface treatment,
 stainless steel insert, hexagonal shaft , coupling, valve, shirt and cable protection in 304
 Engine water bath Franklin, and winding impregnated in a resin, brass primer



BOREHOLE

SFI D

**Borehole pump
 4" Inox Head**

Nominal flow 5 m³/h



SFI

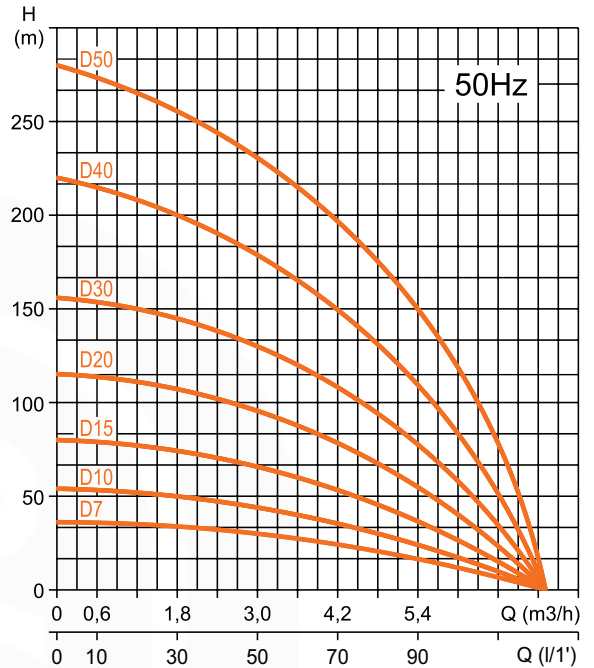
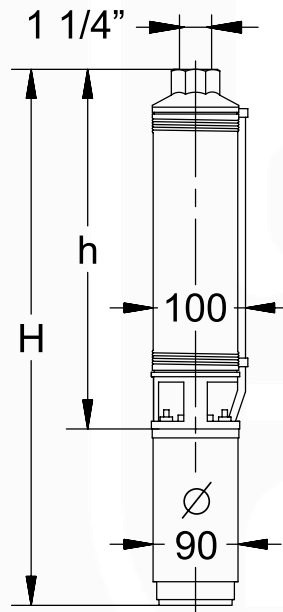

Selection curves: 2850 r / min, water at 20 ° C, according to ISO 2548 standard and C

Type	Dimensions (mm)			Weight Kg Pump	Weight Motor + Pump Kg	
	h	H • Mono	H • Tri		Mono	Tri
SFI D 7.55.	440	710	682	3,50	13,10	11,80
SFI D 10.75.	530	828	800	4,00	14,80	13,60
SFI D 15.110.	650	977	948	4,77	16,87	15,57
SFI D 20.150.	830	1186	1157	5,67	19,17	17,77
SFI D 30.220.	1035	1495	1390	7,03	25,03	20,53
SFI D 40.300.	1350	-	1773	8,68	-	24,68
SFI D 50.400.	1670	-	2260	10,93	-	34,43

Type	Power		Motor			Connection DN	H (max) m	Debit (max) m ³ /h	Code	
	kW	CV	1~ A	μF	3~ A				1x230v (.1)	3x400v (.3)
SFI D 7.55	0,55	0,75	5,0	-	1,6	1"¼	37	6,6	01010227	01010228
SFI D 10.75	0,75	1	6,5	-	2,2		53		01010229	01010230
SFI D 15.110	1,1	1,5	9,4	-	3,2		80		01010231	01010232
SFI D 20.150	1,5	2	11,2	-	4,1		116		01010233	01010234
SFI D 30.220	2,2	3	15,1	-	5,8		157		01010235	01010236
SFI D 40.300	3	4	-	-	7,2		220		--	01010237
SFI D 50.400	4	5,5	-	-	9,5		280		--	01010238

Integrated capacitor for single-phase - Initiation of stainless steel cable on request

BOREHOLE SFI E

Borehole pump 4" Inox Head

USE :

Borehole pump for domestic and industrial use in continuous or intermittent operation (automatic eith reservoir, irrigation, fire system, fountain, etc ...)

FEATURES :

Multistage radial turbine pump with hydraulic float
The component materials are resistant to abrasion and corrosion and are environmentally friendly (non toxic):
head and foot pump stainless steel, impeller and diffuser in polycarbonate reinforced with specific surface treatment,
stainless steel insert, hexagonal shaft , coupling, valve, shirt and cable protection in 304
Engine water bath Franklin, and winding impregnated in a resin, brass primer

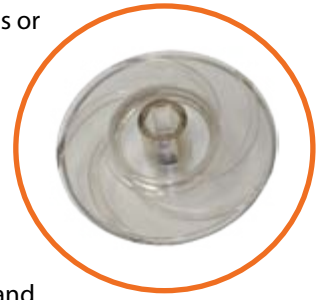

Nominal flow 9 m³/h



SFI

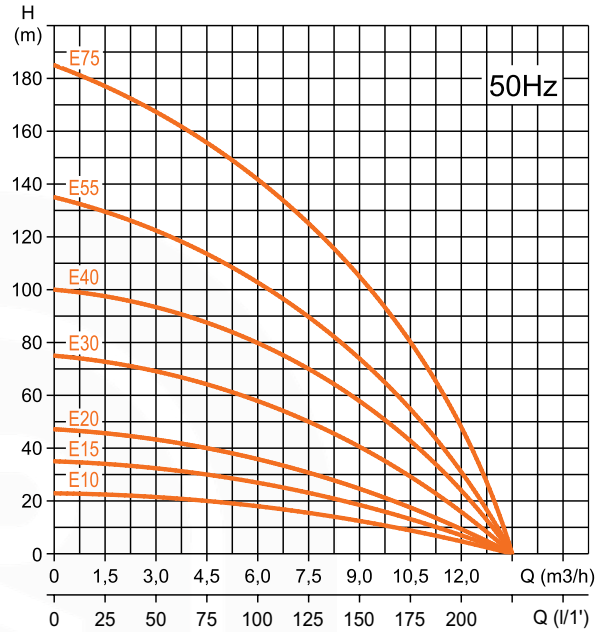
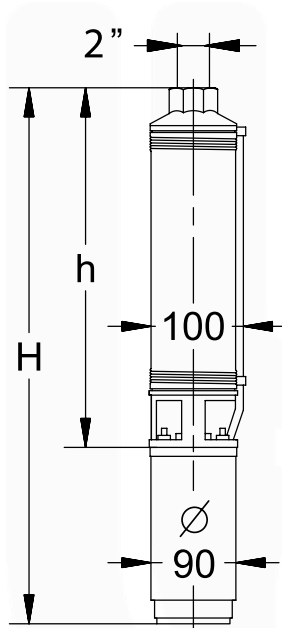

Selection curves: 2850 r / min, water at 20 ° C, according to ISO 2548 standard and C

Type	Dimensions (mm)			Weight Kg Pump	Weight Motor + Pump Kg	
	h	H • Mono	H • Tri		Mono	Tri
SFI E 10.75.	320	610	590	2,4	13,0	12,0
SFI E 15.110.	395	715	690	3,0	15,0	14,0
SFI E 20.150.	456	815	790	3,4	17,0	15,2
SFI E 30.220.	645	1145	1000	4,3	23,0	17,0
SFI E 40.300.	785	-	1290	5,0	-	23,5
SFI E 55.400.	1045	-	1635	6,4	-	30,0
SFI E 75.550.	1365	-	2040	8,5	-	36,0

Type	Power		Motor			Connection DN	H (max) m	Debit (max) m ³ /h	Code	
	kW	CV	1~ A	3~ μF	3~ A				1x230v (.1)	3x400v (.3)
SFI E 10.75	0,75	1	6,5	35	2,2	2"	23	13	01010337	01010338
SFI E 15.110	1,1	1,5	9,4	40	3,2		35		01010339	01010340
SFI E 20.150	1,5	2	11,2	50	4,1		47		01010341	01010342
SFI E 30.220	2,2	3	15,1	70	5,8		75		01010343	01010344
SFI E 40.300	3	4	-	-	7,2		100		--	01010345
SFI E 55.400	4	5,5	-	-	9,5		135		--	01010346
SFI E 75.550	5,5	7,5	-	-	13,5		185		--	01010347

Integrated capacitor for single-phase - Initiation of stainless steel cable on request

USE :

Borehole pump for domestic and industrial use in continuous or intermittent operation (automatic eith reservoir, irrigation, fire system, fountain, etc ...)

FEATURES :

Multistage radial turbine pump with hydraulic float
 The component materials are resistant to abrasion and corrosion and are environmentally friendly (non toxic):
 head and foot pump stainless steel, impeller and diffuser in polycarbonate reinforced with specific surface treatment,
 stainless steel insert, hexagonal shaft , coupling, valve, shirt and cable protection in 304
 Engine water bath Franklin, and winding impregnated in a resin, brass primer



**BOREHOLE
SFI F**

**Borehole pump
4" Inox Head**

Nominal flow 10 m³/h



SFI

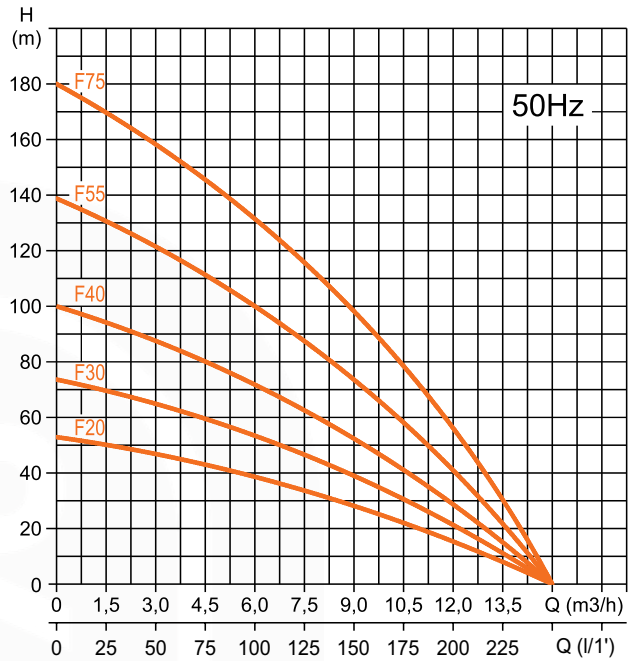
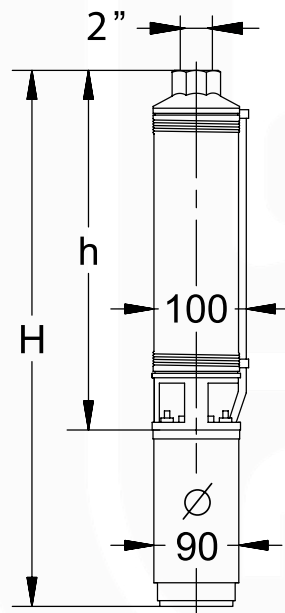

Selection curves: 2850 r / min, water at 20 ° C, according to ISO 2548 standard and C

Type	Dimensions (mm)			Weight Kg Pump	Weight Motor + Pump Kg	
	h	H • Mono	H • Tri		Mono	Tri
SFI F 20.150.	535	890	870	3,6	17,0	15,5
SFI F 30.220.	695	1200	1050	4,5	23,0	17,5
SFI F 40.300.	900	-	1400	5,5	-	24,0
SFI F 55.400.	1205	-	1780	7,1	-	30,5
SFI F 75.550.	1625	-	2300	8,5	-	36,5

Type	Power		Motor			Connection DN	H (max) m	Debit (max) m ³ /h	Code	
	kW	CV	1~ A	μF	3~ A				1x230v (.1)	3x400v (.3)
SFI F 20.150	1,5	2	11,2	50	4,1	2"	53	14,7	01010348	01010349
SFI F 30.220	2,2	3	15,1	70	5,8		74		01010350	01010351
SFI F 40.300	3	4	-	-	7,2		100		--	01010352
SFI F 55.400	4	5,5	-	-	9,5		139		--	01010353
SFI F 75.550	5,5	7,5	-	-	13,5		180		--	01010354

Integrated capacitor for single-phase - Initiation of stainless steel cable on request

BOREHOLE
Hydraulic
only
 For borehole
 pump
 4"



■ Feet and head inox

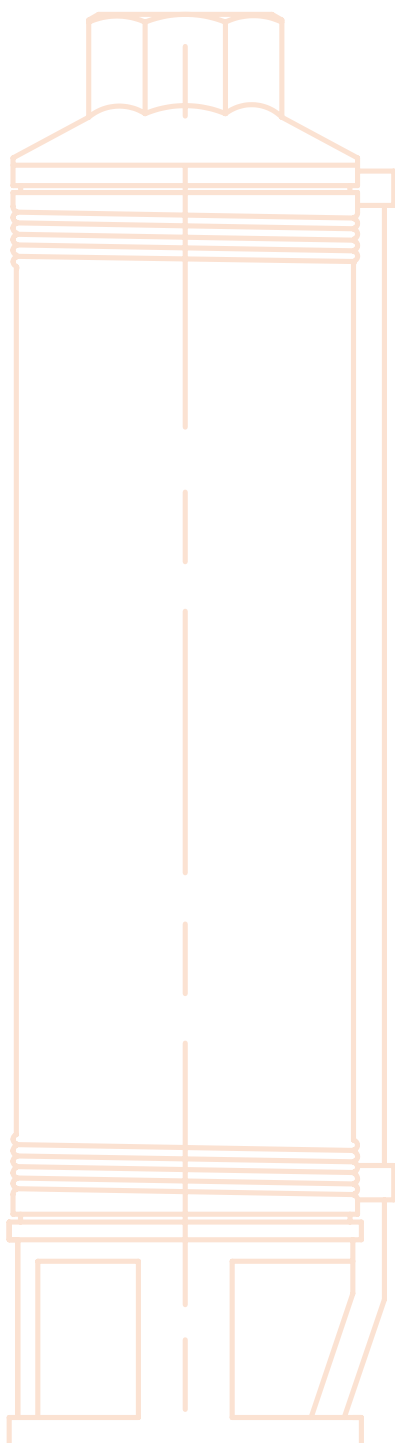

Type	Connection DN	Code	
HFI B 5.37	1" ¼	01150021	
HFI B 7.55		01150022	
HFI B 10.75		01150023	
HFI B 15.110.		01150024	
HFI B 20.150		01150025	
HFI B 30.220		01150026	

HFI C 7.55	1" ¼	01150027	
HFI C 10.75		01150028	
HFI C 15.110		01150029	
HFI C 20.150		01150030	
HFI C 30.220		01150031	
HFI C 40.300		01150032	

HFI D 7.55	1" ¼	01150033	
HFI D 10.75		01150034	
HFI D 15.110		01150035	
HFI D 20.150		01150036	
HFI D 30.220		01150037	
HFI D 40.300		01150038	
HFI D 50.400		01150020	

HFI E 10.75	2	01150051	
HFI E 15.110		01150052	
HFI E 20.150		01150053	
HFI E 30.220		01150054	
HFI E 40.300		01150055	
HFI E 55.400		01150056	
HFI E 75.550		01150057	

HFI F 20.150	2	01150058	
HFI F 30.220		01150059	
HFI F 40.300		01150060	
HFI F 55.400		01150061	
HFI F 75.550		01150062	

FEATURES :

Rotation counterclockwise, shaft up
 Class B insulation, IP 68
 Maximum ambient temperature 30 ° C rated
 Cooling rate mini 8 cm / s
 Starting a maximum of 20 per hour
 Vertical or horizontal position
 Voltage -10% / +6% UN

CABLE :

Beginning of cable, brass included
 Supplement for beginning of cable Inox (extra € 5 HT)

BOREHOLE

**Motor
Franklin****For borehole
pump****4 "****50 Hz**

Tension V	Power		Serie	Code
	kW	CV		
1 x 230	0,37	0,5	4"	01030036
	0,55	0,75		01030038
	0,75	1		01030040
	1,1	1,5		01030042
	1,5	2		01030044
	2,2	3		01030046
3 x 400	0,37	0,5	4"	01030058
	0,55	0,75		01030060
	0,75	1		01030062
	1,1	1,5		01030064
	1,5	2		01030066
	2,2	3		01030069
3 x 400	2,2	3	4" 6500N	01030073
	3	4		01030076
	4	5,5		01030078
	5,5	7,5		01030080
	7,5	10		01030083

Beginnig of cable Franklin

Material	Section mm ²	Length m	Code
BRASS	4 X 1,5	1,5	01030026
	4 X 1,5	2,5	01030027
INOX	4 X 1,5	1,5	01030028
	4 X 1,5	2,5	01030029

SURFACE
PRESSURE

CMH-CMV

Surface
pump
multicellular

Our range of centrifugal multistage pumps, horizontal CMH and vertical CMV are particularly quiet and high performance.

Designed for clear water, a temperature of 35°C max, they are intended for home use (pressure, irrigation, watering), or for industrial uses (pressure, autoclave, washing).

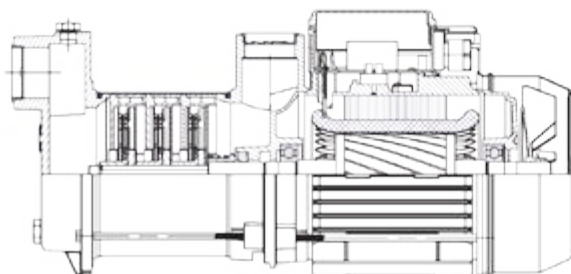

CMH

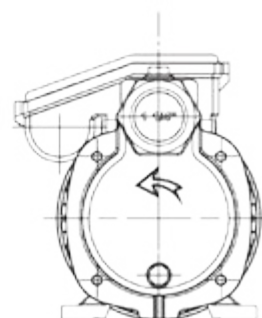

CONSTRUCTION :

Suction and discharge body in cast iron
 Exterior shell, shaft and impeller in stainless steel,
 diffuser in Noryl
 Sealing by mechanical seal carbon ceramic
 Possibility of SIC / SIC on request

MOTEUR :

Protection IP44, insulation class F
 Capacitor incorporated in single phase
 Maximum water temperature 35° C
 Curves at 2850 r / min continuously with water
 density 1 Kg/dm3



SURFACE
 PRESSURE

CMH 10

**Pump
 multicellular
 horizontal**

DN 1"

CMH

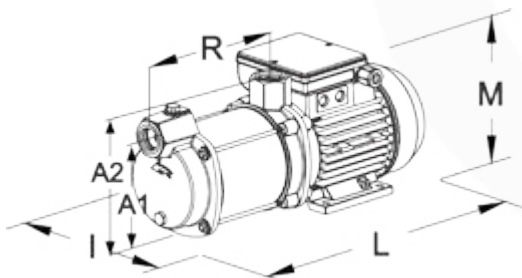
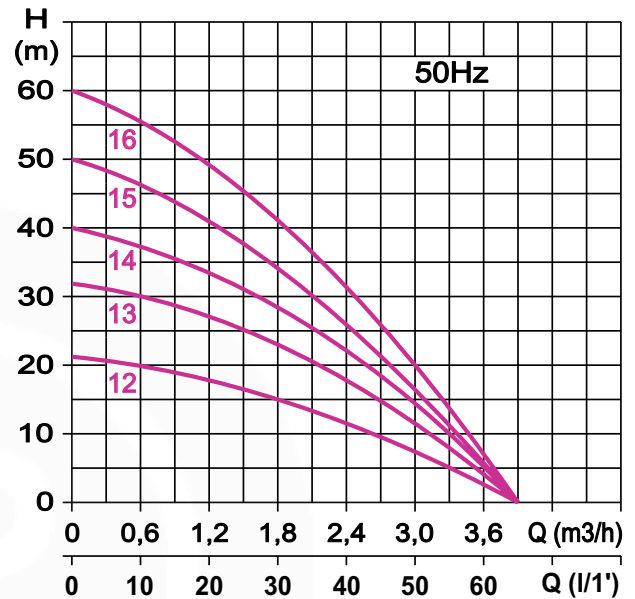

Type	Dimensions (mm)						Weight Kg
	A1	A2	R	I	L	M	
CMH 12.37.	108	147	128,5	155	320	165	8,2
CMH 13.37.			154		338		8,3
CMH 14.60.			179		355		8,5
CMH 15.60.			204		373		9,0
CMH 16.90.			229		400		9,2

Type	Power		Motor			Connection DN	H (max) m	Debit (max) m³/h	Code	
	kW	CV	1~ A	μF	3~ A				1x230v (.1)	3x400v (.3)
CMH 12.37	0,37	0,5	2,2	10	1,1	1"	21	3,9	01010255	01010256
CMH 13.37			2,6	12	1,2		32		01010257	01010258
CMH 14.60	0,6	0,8	3,45	14	1,4		40		01010259	01010260
CMH 15.60			3,9	18	1,6		50		01010261	01010262
CMH 16.90			4,9	20	1,9		60		01010395	01010396

Version BOOSTER with :

- One pump CMH 10
- One horizontal tank 24 l
- One switch
- One flexible tube 1"
- One manometer
- One 5-way connector
- Electric cable



HP CMH 10

Type	Code	
	1x230v (.1)	3x400v (.3)
HP CMH 13.37	01950766	01950767
HP CMH 14.60	01950378	01950768
HP CMH 15.60	01950379	01950769

SURFACE
PRESSURE
CMH 20

**Pump
multicellular
horizontal**

CONSTRUCTION :

Suction and discharge body in cast iron
Exterior shell, shaft and impeller in stainless steel,
diffuser in Noryl
Sealing by mechanical seal carbon ceramic
Possibility of SIC / SIC on request

MOTOR :

Protection IP44, insulation class F
Capacitor incorporated in single phase
Maximum water temperature 35° C
Curves at 2850 r / min continuously with water
density 1 Kg/dm³



DN 1"

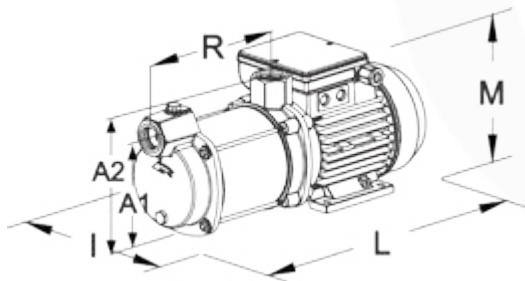
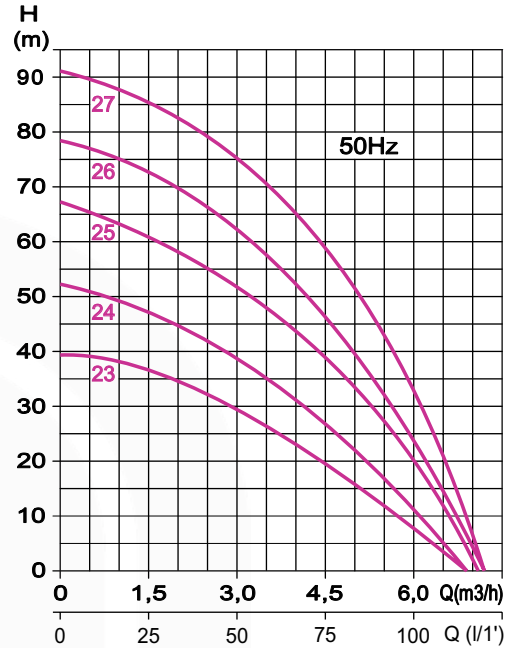

Type	Dimensions (mm)						Weight Kg
	A1	A2	R	I	L	M	
CMH 23.75.			176		400		13,0
CMH 24.80.			205		424		13,5
CMH 25.120.	137	171	234	170	448	193	14,0
CMH 26.120.			263		472		14,5
CMH 27.150.			292		496		16,0

Type	Power		Motor			Connection DN	H (max) m	Debit (max) m³/h	Code	
	kW	CV	1~ A	μF	3~ A				1x230v (.1)	3x400v (.3)
CMH 23.75	0,75	1	4,2	16	1,8	1"	38	6,9	01010263	01010264
CMH 24.80	0,8	1,1	5,4	16	2,3		52		01010265	01010266
CMH 25.120	1,2	1,6	7,2	20	2,8		67	7,2	01010267	01010268
CMH 26.120			7,8	25	3,5		78		01010416	01010417
CMH 27.150	1,5	2	8,6	25	3,8		91		01010540	01010539

Existe en SURPRESSEUR avec :

- One pump **CMH 20**
- One horizontal tank 24 l
- One switch
- One flexible tube 1"
- One manometer
- One 5-way connector
- Electric cable



HP CMH 20

Type	Code	
	1x230v (.1)	3x400v (.3)
HP CMH 23.75	01950770	01950771
HP CMH 24.80	01950380	01950772
HP CMH 25.120	01950377	01950773

CONSTRUCTION :

Suction and discharge body in cast iron
 Exterior shell, shaft and impeller in stainless steel,
 diffuser in Noryl
 Sealing by mechanical seal carbon ceramic
 Possibility of SIC / SIC on request

MOTOR :

Protection IP44, insulation class F
 Capacitor incorporated in single phase
 Maximum water temperature 35° C



SURFACE
 PRESSURE

CMH 30

**Pump
 multicellular
 horizontal**

DN 1"1/4

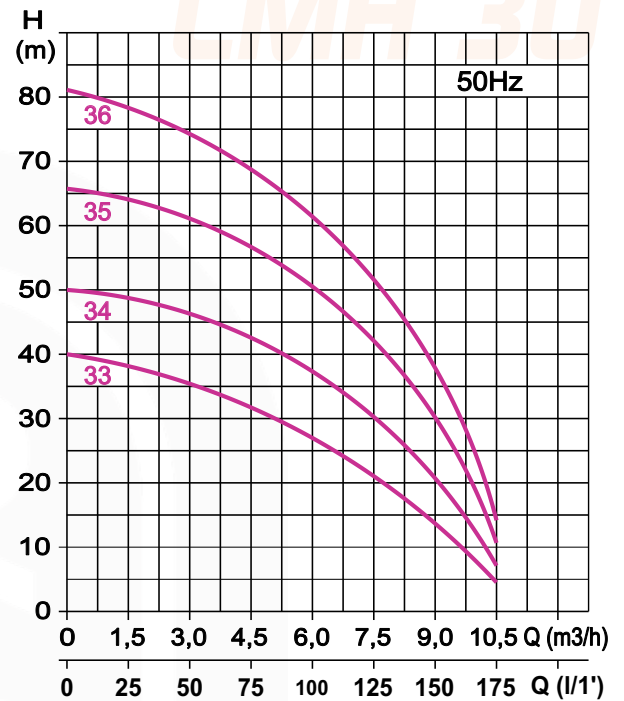

Curves at 2850 r / min continuous
 with water density 1 Kg/dm³

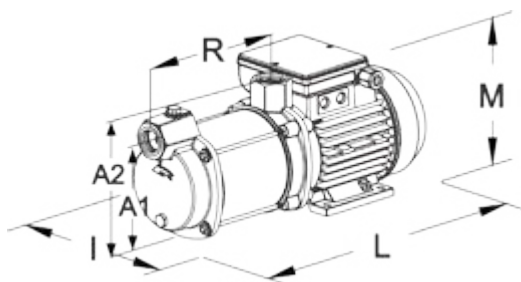

Type	Dimensions (mm)						Weight Kg
	A1	A2	R	I	L	M	
CMH 33.90.	160	190	202	188	447	215	17,0
CMH 34.110.			236		475		17,5
CMH 35.150.			269		503		19,0
CMH 36.120.			303		531		20,0

Type	Power		Motor			Connection DN	H (max) m	Debit (max) m³/h	Code		
	kW	CV	1~ A	3~ µF	3~ A				1x230v (.1)	3x400v (.3)	
CMH 33.90	0,9	1,2	7	25	3,3	1"1/4	10,5	01010269	01010270		
CMH 34.110	1,1	1,5	9	35	3,5					01010271	01010272
CMH 35.150	1,5	2	11,8	40	4,2					01010273	01010274
CMH 36.120	2,2	3	12,4	50	5					01010418	01010275

SURFACE
PRESSURE
CMH 40

**Pump
multicellular
horizontal**

CONSTRUCTION :

Suction and discharge body in cast iron
Exterior shell, shaft and impeller in stainless steel,
diffuser in Noryl
Sealing by mechanical seal carbon ceramic
Possibility of SIC / SIC on request

MOTOR :

Protection IP44, insulation class F
Capacitor incorporated in single phase
Maximum water temperature 35° C



■ **DN 1 1/2"**

CMH 40

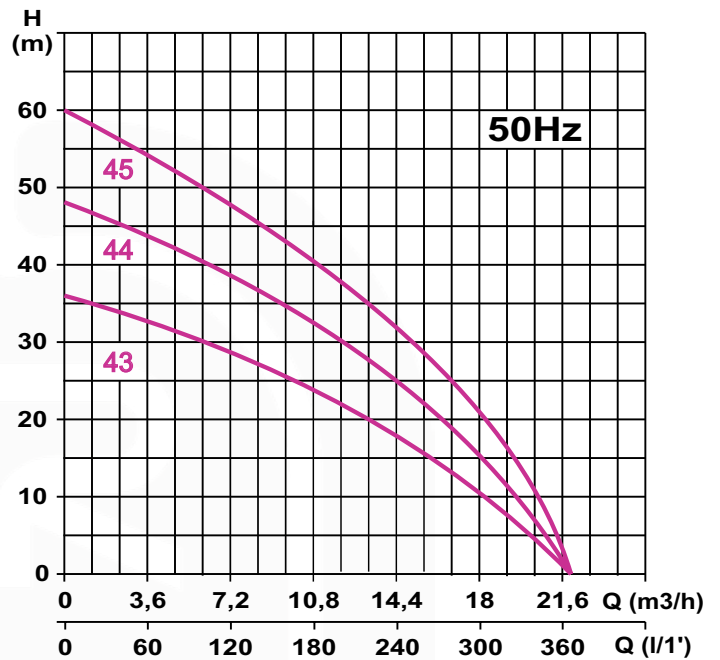

Curves at 2850 r / min continuous
with water density 1 Kg/dm³

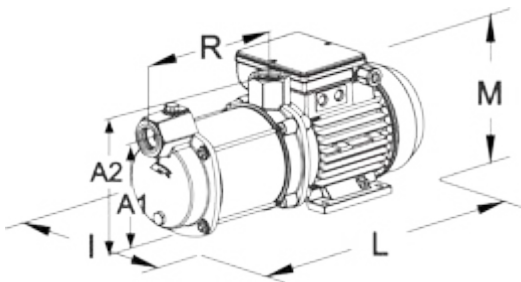

Type	Dimensions (mm)						Weight Kg
	A1	A2	R	I	L	M	
CMH 43.220.			250		500		20
CMH 44.220.	160	200	290	170	540	200	22
CMH 45.300.3			325		610		26

Type	Puissance		Moteur			Raccordement DN	H (max) m	Débit (max) m³/h	Code	
	kW	CV	1~ A	1~ µF	3~ A				1x230v (.1)	3x400v (.3)
CMH 43.220	2,2	3	11	40	3,6	1" 1/2	36	22	01011000	01010993
CMH 44.220			12	40	4,2		46		01011001	01010994
CMH 45.300	3	4	--	--	6		57		--	01010995

CONSTRUCTION :

Suction and discharge body in cast iron
 Exterior shell, shaft and impeller in stainless steel,
 diffuser in Noryl
 Sealing by mechanical seal carbon ceramic
 Possibility of SIC / SIC on request

MOTOR :

Protection IP44, insulation class F
 Capacitor incorporated in single phase
 Maximum water temperature 35° C



SURFACE
 PRESSURE

CMV 20

**Pump
 multicellular
 vertical**

DN 1"

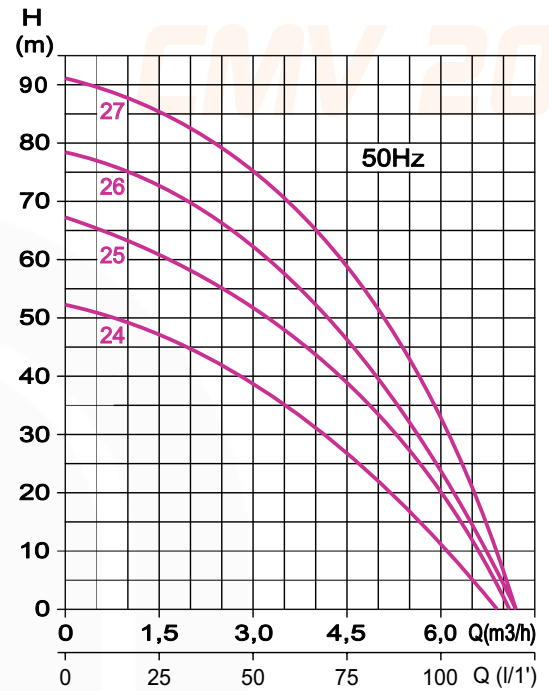
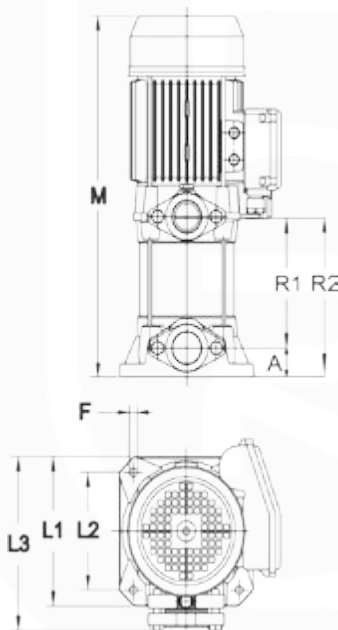

Curves at 2850 r / min continuous
 with water density 1 Kg/dm³

Type	Dimensions (mm)								Weight Kg
	A	R1	R2	L1	L2	L3	M	ø F	
CMV 24.80.	21,5	156	177	160	125	177	380	9,5	14,5
CMV 25.120.		170	192				400		15
CMV 26.120.		190	212				420		15,5
CMV 27.150.		210	232				440		17

Type	Power		Motor			Connection DN	H (max) m	Debit (max) m³/h	Code		
	kW	CV	1~ A	μF	3~ A				1x230v (.1)	3x400v (.3)	
CMV 24.80	1,2	1,6	5,4	16	2,3	1"	7,2	01010278	01010279		
CMV 25.120			7,2	20	2,8					01010280	01010281
CMV 26.120			7,8	25	3,5					01010646	01010647
CMV 27.150			8,6	25	3,8					01010864	01010763

SURFACE
PRESSURE

CMV 30

**Pump
multicellular
vertical**

CONSTRUCTION :

Suction and discharge body in cast iron
Exterior shell, shaft and impeller in stainless steel,
diffuser in Noryl
Sealing by mechanical seal carbon ceramic
Possibility of SIC / SIC on request



MOTOR :

Protection IP44, insulation class F
Capacitor incorporated in single phase
Maximum water temperature 35° C

..... ■ **Aspiration 1"½ - Discharge 1"¼**

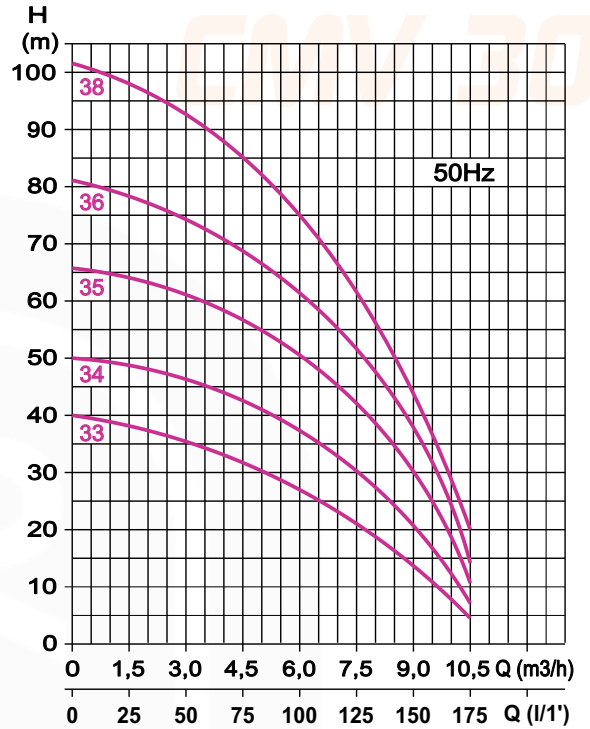
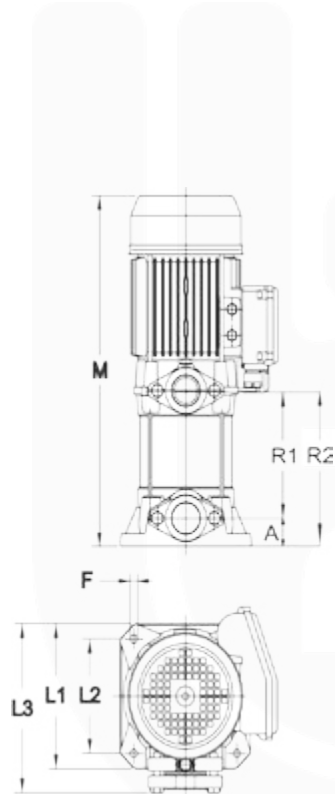

Curves at 2850 r / min continuous
with water density 1 Kg/dm³

Type	Dimensions (mm)								Weight Kg
	A	R1	R2	ø L1	ø L2	L3	M	ø F	
CMV 33.90.	37	164	201	184	133	212	447	9	21,0
CMV 34.110.		188,5	226				470		22,0
CMV 35.150.		213,5	250,5				495		24,0
CMV 36.220.		238	275				520		24,5
CMV 38.300.3		286	323				607		28,0

Type	Power		Motor			Connection		H (max) m	Debit (max) m³/h	Code	
	kW	CV	1~ A	μF	3~ A	DNA	DNC			1x230v (.1)	3x400v (.3)
CMV 33.90	0,9	1,2	6,2	25	3,7	1"½	1"¼	10,5	10,5	01010282	01010283
CMV 34.110	1,1	1,5	8,9	35	3,9					01010284	01010285
CMV 35.150	1,5	2	11,2	40	4,6					01010286	01010287
CMV 36.220	2,2	3	12	50	5					01010648	01010288
CMV 38.300	3	4	-	-	6					--	01010565

CONSTRUCTION :

Suction and discharge body in cast iron
 Exterior shell, shaft and impeller in stainless steel,
 diffuser in Noryl
 Sealing by mechanical seal carbon ceramic
 Possibility of SIC / SIC on request

MOTOR :

Protection IP44, insulation class F
 Capacitor incorporated in single phase
 Maximum water temperature 35° C



SURFACE
 PRESSURE

CMV 40

**Pump
 multicellular
 vertical**

Aspiration 1"½ - Discharge 1"¼

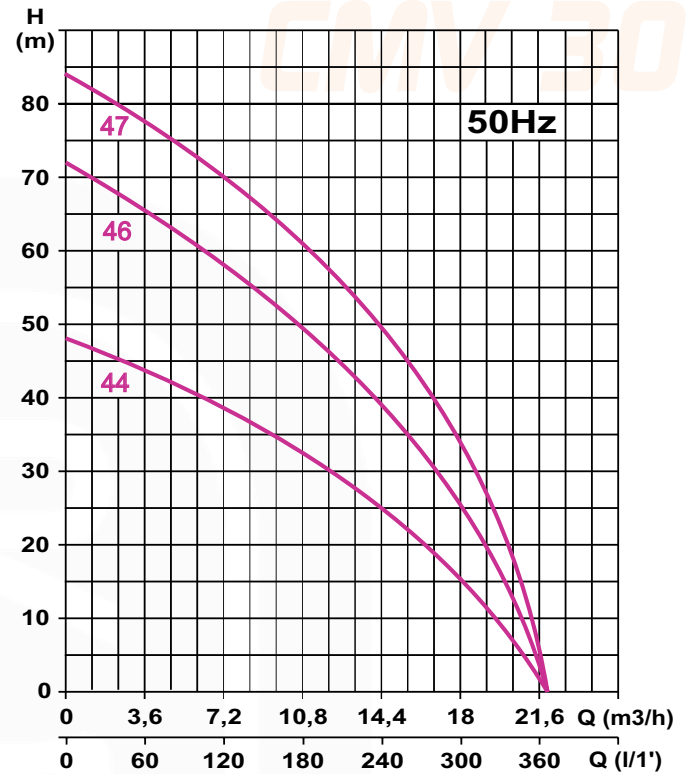
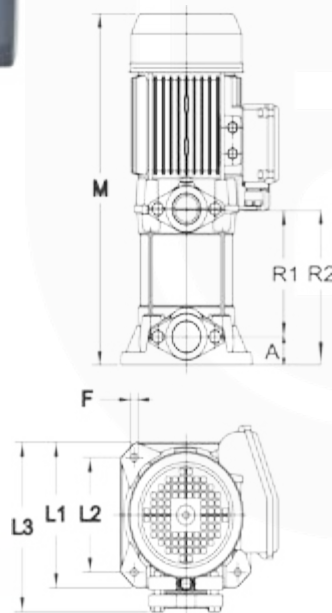

Curves at 2850 r / min continuous
 with water density 1 Kg/dm³

Type	Dimensions (mm)							ø F	Weight Kg
	A	R1	R2	L1	L2	L3	M		
CMV 44.220.3	37	248	285	184	133	212	596	9	33
CMV 46.300.3		325	362				719		37
CMV 47.400.3		365	402				800		45

Type	Power		Motor		Connection		H (max) m	Debit (max) m³/h	Code 3x400v (.3)
	kW	CV	A	µF	DNA	DNC			
CMV 44.220	2,2	3	4,5	--	1"½	1"¼	48	22	01010868
CMV 46.300	3	4	7,6	--			72		01010869
CMV 47.400	4	5,5	11	--			84		01010870

SURFACE
PRESSURE

Range DUO

Pressure
group

The booster sets DUO CMV and DUO CMH consist of two identical pumps CMH or CMV in parallel on a common chassis with a control panel and motor protection. The enslavement of the pumps is provided by a pressure switch. Each set DUO is assembled, tested and preset at the factory. The booster must be used with a pressure tank.

Each booster contains, in addition to the two pumps and chassis:

- collector stainless steel discharge (suction as supplement)
- valves and brass valves
- Stainless steel pressure gauge in glycerine bath
- a pressure pump
- Galvanized steel frame and bracket
- an electrical control and protection

■ 10 bars

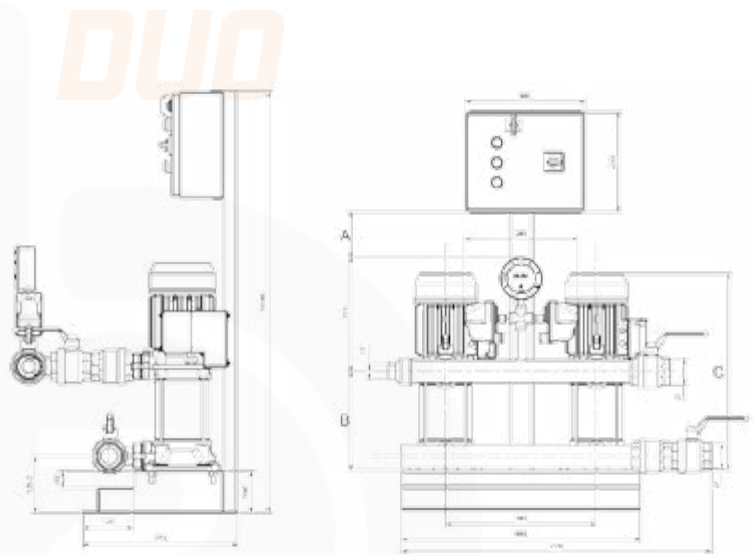

Type	Dimensions (mm)			Weight Kg
	A	B	C	
DUO CMV 25.120.	215	219	495	81
DUO CMV 27.150.	165	258	545	86
DUO CMV 33.90.	254	210	456	81
DUO CMV 34.110.	226	238	484	83
DUO CMV 35.150.3	198	266	512	87
DUO CMV 36.220.3	170	294	540	88
DUO CMV 38.300.3	80	345	630	95

DUO CMV 20

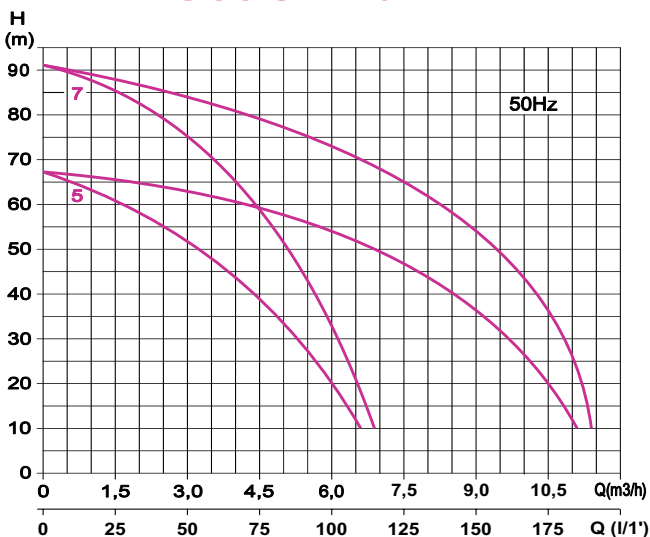

DUO CMH 30 and DUO CMV 30

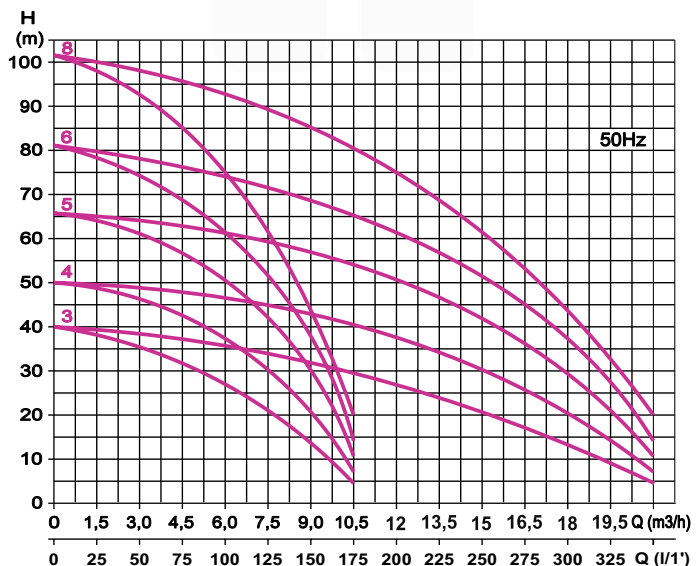

APPLICATIONS :

Aduction water, irrigation, water treatment, industrial

Maximum operating pressure: 10 bar - Maximum temperature of liquid: 35° C

CONSTRUCTION

PUMP : Pump body and pusher in cast iron, stainless steel exterior shell and impeller, shaft AISI 420. Noryl diffuser with glass fiber

Mechanical seal (graphite-aluminum), SIC / SIC DIN 24960 on request

MOTOR : Asynchronous single-phase 230 V 50 Hz or three phase 400 V 50 Hz
Protection IP44, Class F - Capacitor permanently on in single phase

CHASSIS : Frame, boom-box and chassis galvanized steel

Suction and discharge manifolds AISI 420

SURFACE
PRESSURE

DUO CMH
DUO CMV

Pressure
group

Horizontal or vertical pumps

DUO



Group with 2 horizontal multistage pumps type CMH

Type	Power		Motor			Connection DN	H (max) m	Debit (max) m³/h	Code	
	kW	CV	1~ A	μF	3~ A				1x230v (.1)	3x400v (.3)
DUO CMH 34.110	2 x 1,1	2 x 1,5	18	35	7	1"¼	49	21	01950856	01950857
DUO CMH 35.150	2 x 1,5	2 x 2,0	23,6	40	8,4		65		01950858	01950859
DUO CMH 36.220	2 x 2,2	2 x 3,0	-	-	10		79,5		---	01950860



Group with two vertical multistage pumps type CMV

Type	Power		Motor			Connection DN	H (max) m	Debit (max) m³/h	Code	
	kW	CV	1~ A	μF	3~ A				1x230v (.1)	3x400v (.3)
DUO CMV 25.120	2 x 1,2	2 x 1,6	13	20	4,6	1"¼	63	11,4	01950861	01950862
DUO CMV 27.150	2 x 1,5	2 x 2,0	16,4	25	6,7		82		01950863	01950864

Type	Power		Motor			Connection DN	H (max) m	Debit (max) m³/h	Code	
	kW	CV	1~ A	μF	3~ A				1x230v (.1)	3x400v (.3)
DUO CMV 33.90	2 x 1,1	2 x 1,5	12,4	25	7,4	1"¼	39	21	01950865	01950866
DUO CMV 34.110	2 x 1,1	2 x 1,5	17,8	35	7,8		49		01950919	01950920
DUO CMV 35.150	2 x 1,5	2 x 2,5	-	-	9,2		65		---	01950867
DUO CMV 36.220	2 x 2,2	2 x 3,0	-	-	10,0		80		---	01950918
DUO CMV 38.300	2 x 3,0	2 x 4,0	-	-	12,0		108		---	01950868

SURFACE
PRESSURE

Gammes

TRI

**Pressure
group**

The booster sets TRI CMV and TRI CMH consist of two identical pumps CMH or CMV in parallel on a common chassis with a control panel and motor protection. The enslavement of the pumps is provided by a pressure switch. Each set TRI is assembled, tested and preset at the factory. The booster must be used with a pressure tank.

Each booster contains, in addition to the two pumps and chassis:

- collector stainless steel discharge (suction as supplement)
- valves and brass valves
- Stainless steel pressure gauge in glycerine bath
- a pressure pump
- Galvanized steel frame and bracket
- an electrical control and protection

■ 10 bars

APPLICATIONS :

Aduction water, irrigation, water treatment, industrial

Maximum operating pressure: 10 bar - Maximum temperature of liquid: 35° C

CONSTRUCTION

PUMP : Pump body and pusher in cast iron, stainless steel exterior shell and impeller, shaft AISI 420. Noryl diffuser with glass fiber

Mechanical seal (graphite-aluminum), SIC / SIC DIN 24960 on request

MOTOR : Asynchronous single-phase 230 V 50 Hz or three phase 400 V 50 Hz
Protection IP44, Class F - Capacitor permanently on in single phase

CHASSIS : Frame, boom-box and chassis galvanized steel
Suction and discharge manifolds AISI 304

The configuration of the TRI CMH or TRI CMV will be calculated on an individual basis as required by the installation.



CONSTRUCTION :

Pump body in cast iron (Jet 100)
 Pump body in stainless steel (Jet 1000)
 Impeller in stainless steel
 Shaft in stainless steel; mechanical seal.

MOTOR :

Protection IP44, insulation class F
 Capacitor permanently on the single-phase motors.
 Water temperature: max 35° C.



SURFACE
PRESSURE

JET

**Pump
self
priming**

DN 1"

These pumps are used for the treatment of clean water not containing abrasive particles and liquids that are not chemically aggressive to pump components. Reliable, economical and easy to use, they are suitable for domestic applications and for the automatic distribution of water from surge tanks, for watering gardens and for boosting insufficient water pressure.

Self priming pump power. Suction lift up to 9 Mt These pumps must be installed in a covered area, protected against the elements.

JET 100 - CAST

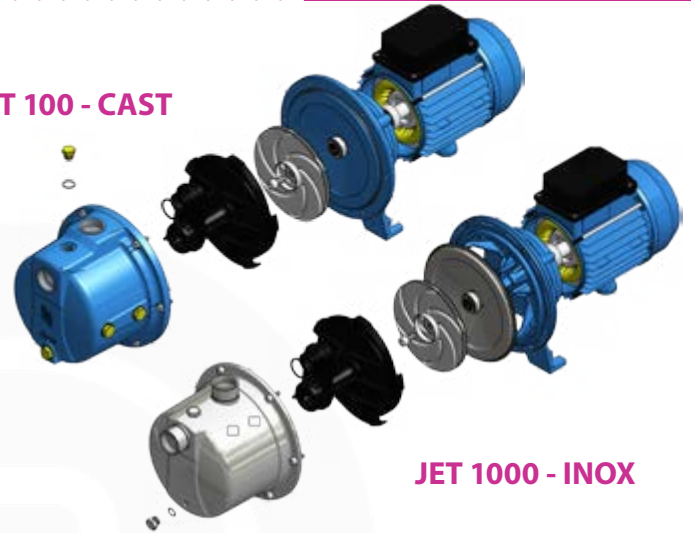

JET 1000 - INOX

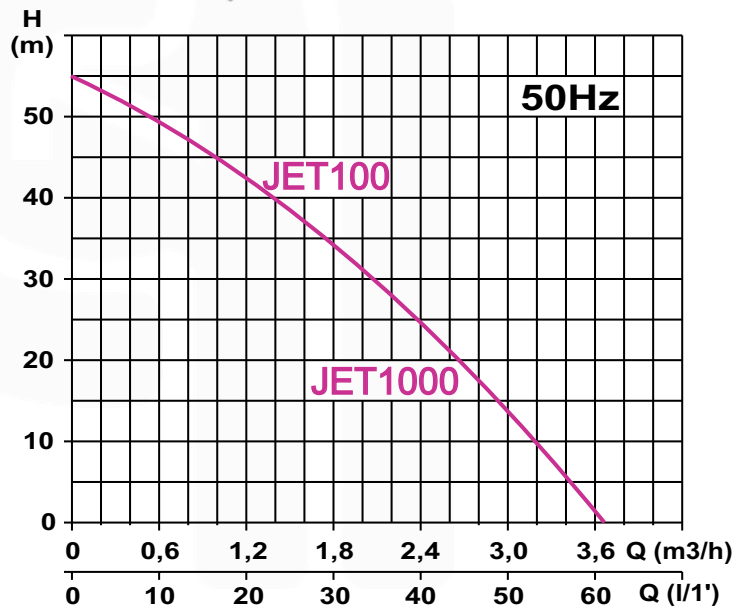

Type	Dimensions (mm)			Weight Kg
	I	L	M	
JET 100.80.	200	415	233	15
JET 1000.80.		400		12

Type	Power		Motor			Connection DN	H (max) m	Debit (max) m³/h	Code	
	kW	CV	1~ A	μF	3~ A				1x230v (.1)	3x400v (.3)
JET 100.80	0,8	1,1	4,60	20	1,9	1"	55	3,6	01010996	01010998
JET 1000.80	0,8	1,1	4,60	20	1,9	1"	55	3,6	01010997	01010999

SURFACE
SURPRESSION

MB

**Pompe
single-stage
cast iron**

APPLICATION :

Single-stage cast iron pump for clean water, non-abrasive and non-aggressive

For all applications in irrigation and transfer

With robust design the MB ranges are ideal for agricultural facilities

Built-in capacitor, single phase



■ **50 Hz**



BMI / BTI

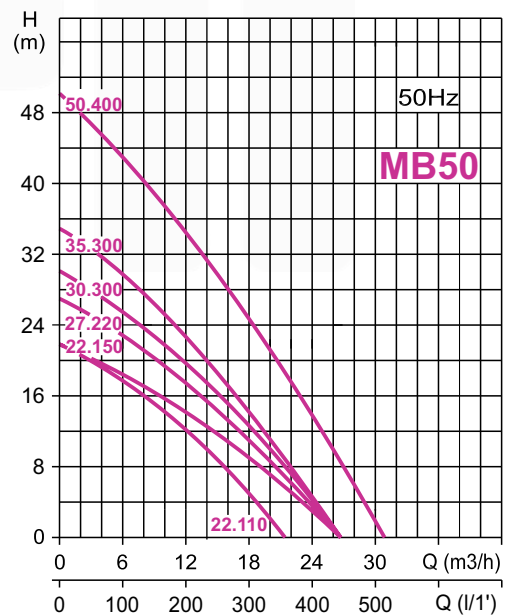
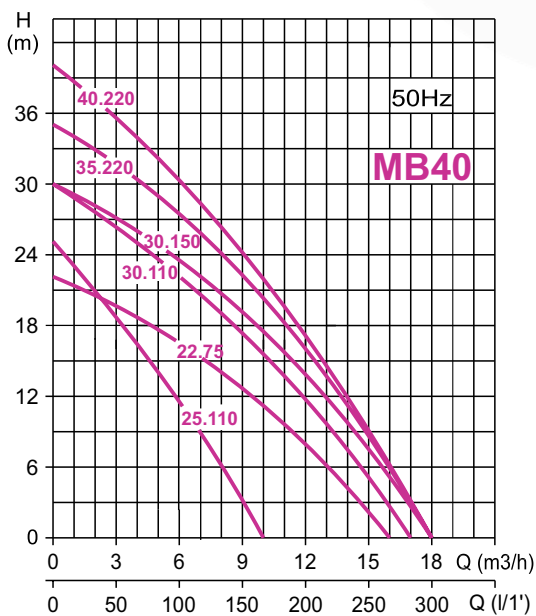
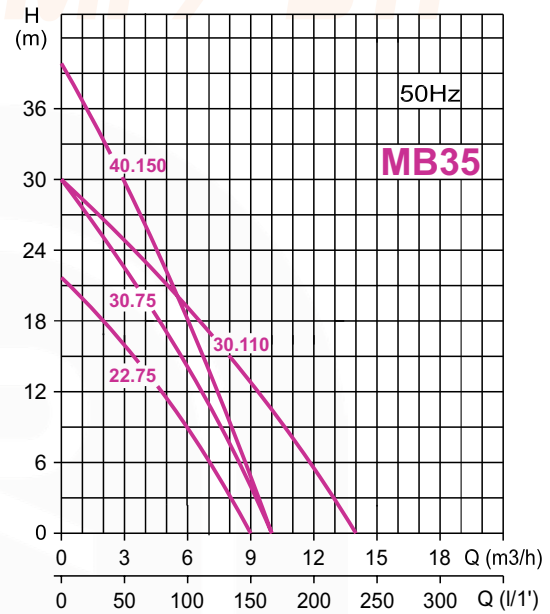

**Pompe
single-stage
cast iron**

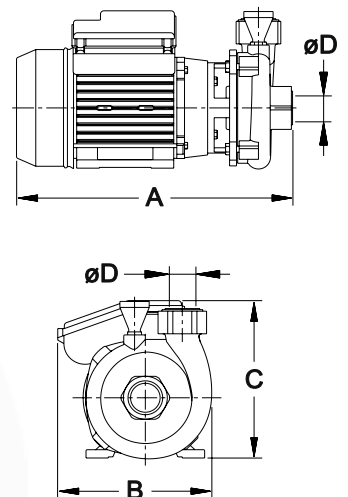
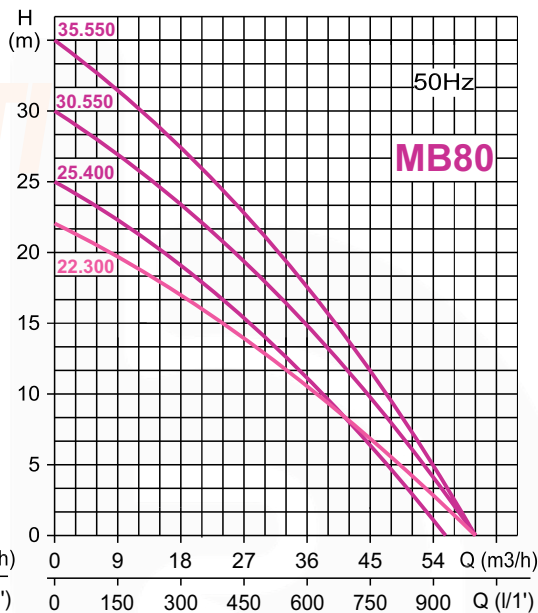

Type	Power		Motor			Dimensions (mm)				Weight Kg	H (max) m	Debit (max) m³/h	Code	
	kW	CV	1~ A	μF	3~ A	A	B	C	ø D				1x230v (.1)	3x400v (.3)
MB35 22.75	0,55	0,75	5,6	25	1,7	350	200	214	1"1/4	19	22	9	01010063	01010075
MB35 30.75	0,75	1	5,6	25	1,7	370	200	230		19	30	10	01010065	01010077
MB35 30.110	1,1	1,5	7,3	30	2,6	354	209	239		22	30	14	01010365	01010083
MB35 40.150	1,5	2	-	-	3,3	440	280	250		27	40	10	---	01010089
MB40 22.75	0,75	1	5,6	25	1,7	380	200	230	1"1/2	15	22	16	01010061	01011063
MB40 25.110	1,1	1,5	7,3	30	2,6	357	210	238		22	25	10	01010517	01010082
MB40 30.110	1,1	1,5	7,3	30	2,6	380	200	230		22	30	17	01010070	01011003
MB40 30.150	1,5	2	-	-	3,3	390	200	250		23	30	18	---	01010088
MB40 35.220	2,2	3	-	-	4,7	401	224	263		30	35	18	---	01010093
MB40 40.220	2,2	3	-	-	5,2	460	270	250	30	40	18	---	01010094	
MB50 22.110	1,1	1,5	7,3	30	2,6	369	222	225	2"		22	21	01010067	01010556
MB50 22.150	1,5	2	-	-	3,3	400	260	230		28	22	26	---	01010086
MB50 27.220	2,2	3	-	-	4,7	400	250	250		28	27	26	---	01010092
MB50 30.300	3	4	-	-	6,3	445	246	243		40	30	26	---	01010099
MB50 35.300	3	4	-	-	6,3	449	215	260		40	35	26	---	01010100
MB50 50.400	4	5,5	-	-	8,2	510	280	310		42	50	30	---	01010103
MB65 22.220	2,2	3	-	-	4,7	426	237	257	2"1/2	33	22	32	---	01010091
MB65 22.300	3	4	-	-	6,3	467	237	258		37	22	40	---	01010096
MB65 27.300	3	4	-	-	6,3	472	253	277		40	27	40	---	01010097
MB65 30.400	4	5,5	-	-	8,2	498	253	277		42	30	40	---	01010102
MB65 35.550	5,5	7,5	-	-	11	576	278	308			35	40	---	01010105
MB80 22.300	3	4	-	-	6,3	495	251	262	3"	41	22	60	---	01010098
MB80 25.400	4	5,5	-	-	8,2	423	275	290		44	25	56	---	01010101
MB80 30.550	5,5	7,5	-	-	11	523	275	290			30	60	---	01010104
MB80 35.550	5,5	7,5	-	-	11	597	288	305			35	60	---	01010106

SURFACE
SURPRESSIO

CF2

**Pump
for coupling**

CONSTRUCTION :

Galvanized steel cardan;
Mechanical seal (SIC/SIC DIN24960);
Pump body in **cast iron**;
Turbine brass;
Shaft in stainless steel (AISI 416);
Grid protection in Stainless Steel.



Aspiration 2" - Discharge 1"½

Centrifugal Pump of double turbine and for engagement, ideal for applications requiring the use of motor fuel. Ideal for domestic, agriculture, industrial uses.

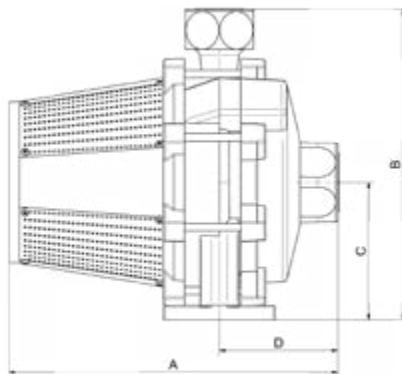
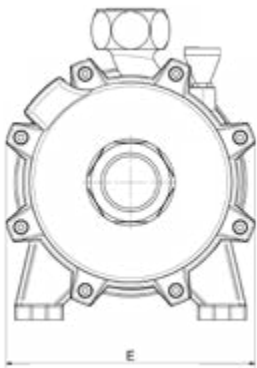
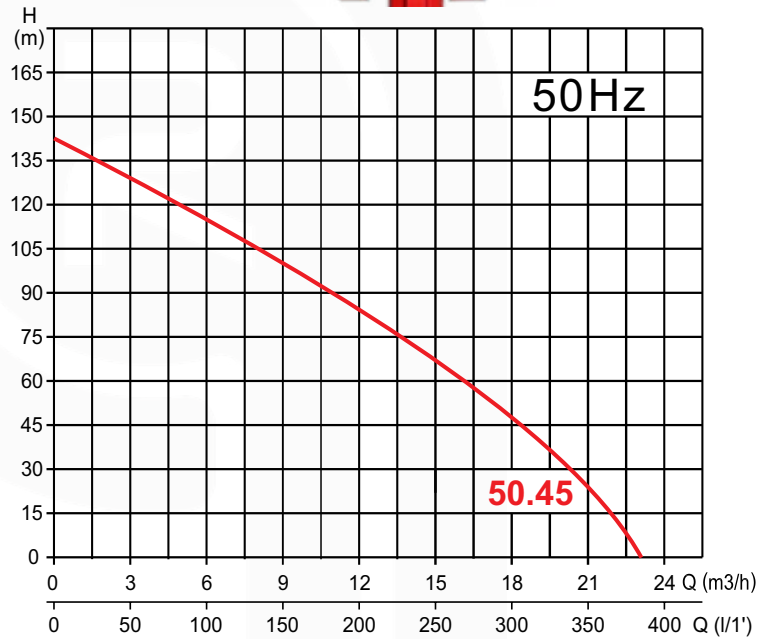
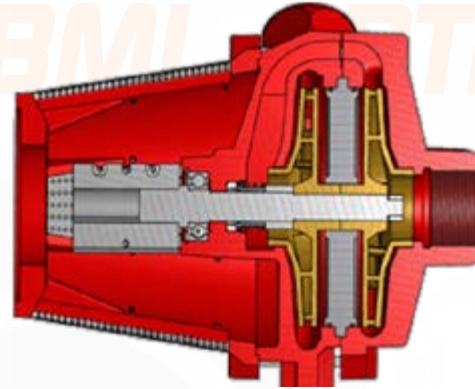

Type	Dimensions (mm)					Weight Kg
	A	B	C	D	E	
CF2 50.45	343	328	145	123	260	37

Type	Motor	Connection		H (max) m	Debit (max) m³/h	Code	
		DNA	DNC				
CF2 50.45	Diesel 12cv	2"	1"½	142	24	01010988	

Motor not included

CONSTRUCTION :

- Galvanized steel cardan;
- Mechanical seal (SIC/SIC DIN24960);
- Pump body in **aluminum, painted or as option nickel plated;**
- Turbine brass;
- Shaft in stainless steel (AISI 416);
- Grid protection in Stainless Steel.



SURFACE
SURPRESSIO
CF2

**Pump
for coupling**

Aspiration 3" - Discharge 2" ■

CF2

Centrifugal Pump of double turbine and for engagement, ideal for applications requiring the use of motor fuel. Ideal for domestic, agriculture, industrial uses.

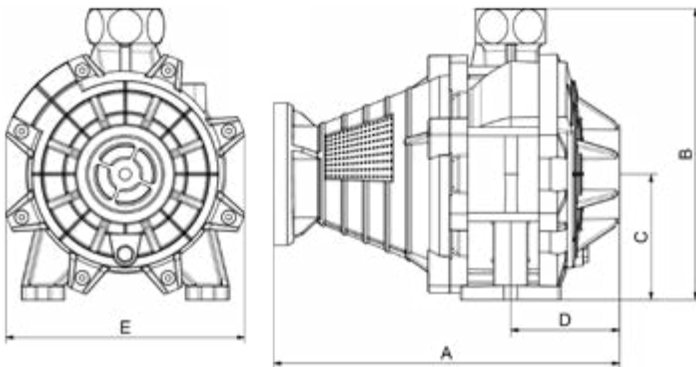
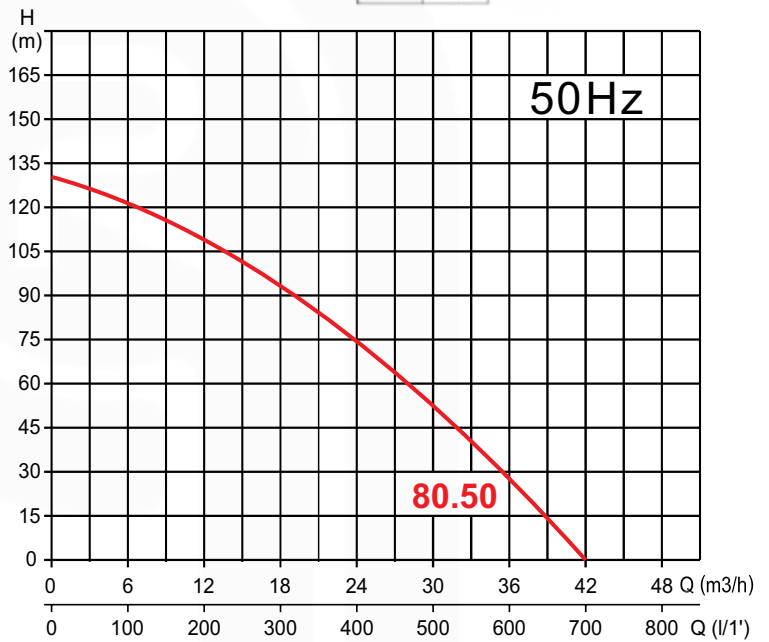
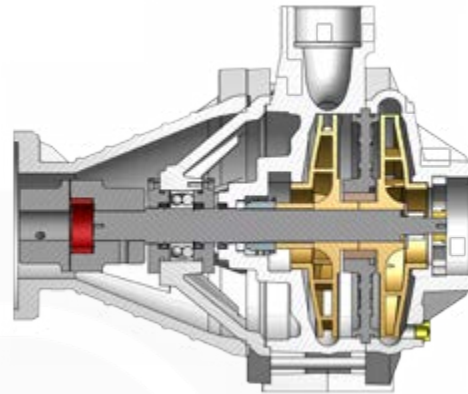

Type	Dimensions (mm)					Weight Kg
	A	B	C	D	E	
CF2 80.50	402	338	146	127	278	

Type	Motor	Connection		H (max) m	Debit (max) m³/h	Code	
		DNA	DNC			Paint	Nickel plated
CF2 80.50	Gasoline 18cv	3"	2"	130	42	0101159	0101176

Motor not included

ELECTRIC
MOTOR

OF / OS

**Motor
single-fase
in aluminum
1450 RPM**

OF : Motors with cable

OS : Motor without cable



OF / OS

With 1 capacitor

Type	Motor					B3 Code	B14 Code	B5 Code
	Fam.	kW	CV	RPM	A			
OF 71.37.1 - 4	71	0,37	0,5	1450	3,3	01080001	01080000	01080004
OF 80.60.1 - 4	80 BA	0,55	0,75		4,5	01080013	01080124	01080125
OF 80.75.1 - 4	80 BA	0,75	1,0		5,3	01080018	01080016	01080021
OF 90.110.1 - 4	90S	1,10	1,5		7,5	01080121	01080128	01080129
OF 90.150.1 - 4	90L	1,50	2,0		10,0	01080122	01080130	01080131
OS 71.37.1 - 4	71	0,37	0,5	1450	3,3	01080060	01080059	01080061
OS 80.60.1 - 4	80 BA	0,55	0,75		4,5	01080066	01080126	01080127
OS 80.75.1 - 4	80 BA	0,75	1,0		5,3	01080068	01080067	01080070
OS 90.110.1 - 4	90S	1,10	1,50		7,5	01080132	01080133	01080134
OS 90.150.1 - 4	90L	1,50	2,0		10,0	01080135	01080136	01080137

With 2 capacitor

Type	Motor					B3 Code	B14 Code	B5 Code
	Fam.	kW	CV	RPM	A			
OFL 90.110.1 - 4	90S	1,10	1,5	1450	7,5	01080044	01080043	01080045
OFL 90.150.1 - 4	90L	1,50	2,0		5,3	01080048	01080047	01080050
OFL 90.180.1 - 4	90L	1,80	2,5		11	01080052	01080051	01080054
OSL 90.110.1 - 4	90S	1,10	1,5	1450	5,3	01080081	01080080	01080082
OSL 90.150.1 - 4	90L	1,50	2,0		7,5	01080084	01080083	01080085
OSL 90.180.1 - 4	90L	1,80	2,5		10,0	01080087	01080086	01080088

OT : Motor without cable



ELECTRIC
MOTOR

OT
Motor
three-phase
in aluminum
1450/2850 RPM

OT

Type	Motor					B3	B14	B5
	Fam.	kW	CV	RPM	A	Code	Code	Code
OT 71.37.3 - 4	71	0,37	0,5	1450	1,1	01080101	01080100	01080103
OT 90.150.3 - 2	90	1,5	2,0	2850	3,3	01080105	01080104	01080106
OT 90.220.3 - 2	90	2,2	3,0		4,7	01080108	01080107	01080109
OT 100.300.3 - 2	100	3,0	4,0		6,3	01080092	01080091	01080093
OT 112.400.3 - 2	112	4,0	5,5		8,2	01080095	01080094	01080096
OT 132.550.3 - 2	132	5,5	7,5		11	01080098	01080097	01080099

**Inox Tank
Borehole cover
Inox cannon**

The accessory list below is not exhaustive.
For more information on spare parts, accessories available for each type of material,
do not hesitate to consult your local supplier.

Accessories



Stainless steel tank

Maximum operating pressure: 10 bar
Precharge Factory 1.5 bars

Type	Capacity	Code
Réservoir	24 litres	01040029



Borehole cover

4" galvanized steel
Available with the following connections:

Type	Conection	Code
Borehole cover 4"	1"	01250108S1
Borehole cover 4"	1" ¼	01250108S2
Borehole cover 4"	1" ½	01250108S3
Borehole cover 4"	2"	01250108S4



Cannon

AISI 304 stainless steel cannon
1" ¼

Type		Code
Cannon	1" ¼	01250116

APPLICATION :

The control panel allows the command and control of two lift pumps.
It provides switching pumps on every boot, walking cascade pumps in case of very high level backup and recovery in the second pump in case of starting the first.

Order 3 + 1 float float alarm

Remote alarm panel on general

SPECIFICATIONS :

IP 65 IK09 polyester shell - door with lock

Dimensions: H 615 x W 415 x D 230 mm

Control panel**IP54 - 2 pompes****EQUIPMENT ON THE DOOR:**

- 1 main switch on / off
- 1 power LED
- 2 lights on, two default lights
- 1 lack of light phase (three phase)
- 1 warning light
- 1 switch pump manu-0-self
- 1 alarm test switch manu-0-self

EQUIPMENT ON CHASSIS:

- 1 switch quad phase
- 2 engine-magnetic circuit breakers
- 2 engine switches
- 2 modules swap
- 1 management module pumps
- 2 auxiliary contacts
- 1 380/24 v transformer control
- 1 inversion module and asymmetric phases (three phase)
- 1 thermal 2 A breaker control
- 1 buzzer

CONNECTION :

A terminal comprising:

- 2 engine power, a power supply
- an emergency float "low"
- 1 stop pumps, a pump start one, start a pump 2
- a level too high (alarm), an alarm report, a strip of land



Type	Intensity A	
ALT 2451 Monophase	de 6 à 10	
ALT 2451 Monophase	de 9 à 14	
ALT 2451 Triphase	de 1,6 à 2,5	
ALT 2451 Three-phase	de 2,5 à 4,0	
ALT 2451 Three-phase	de 6 à 10	
ALT 2451 Three-phase	de 9 à 14	

FEATURES :

Package startup and thermal protection for single phase pump 230V or 400V three-phase

Electrical box without probe**Electric Box****INCLUDES :**

- On / off switch
- Thermal protection (overcurrent, overload, phase failure)
- Protection against dry running without electrodes, by measuring the Cos ϕ
- Terminal block for remote
- Report alarm
- Motor power from 0.37 to 5.5 kW and 14 A max



May receive a starting capacitor

Type	Intensity A	
Monophasé	12 A	
Triphasé	12A	



Rua do Campo Grande, nº 15
Zona Ind. Esmoriz - Sector C
3885-530 ESMORIZ - Portugal
Tél: +351 256 780 910
Fax: +351 256 783 880
oliju@oliju.com
www.oliju.com



SPECIFIC CONDITIONS FOR 2015 RATES :



General Sales Conditions



1. SHIPPING

2. GUARANTEES

3. RESPONSABILITES

4. PAYMENT

5. DELIVERY

6. DIVERSE



YOUR PUMPING SOLUTION

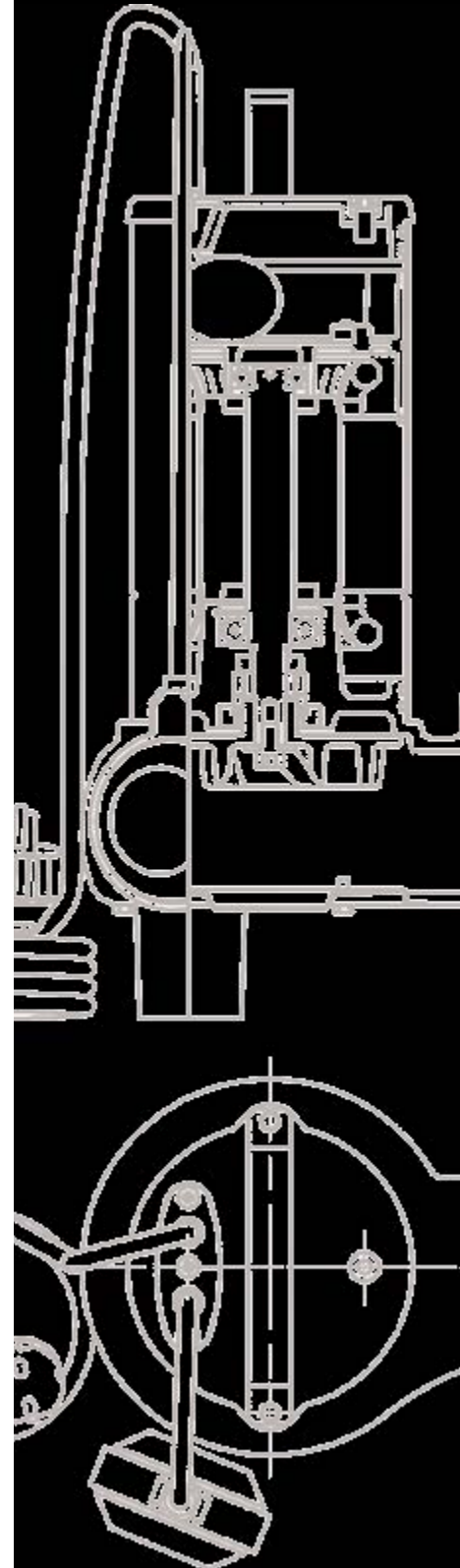

motralec

4 rue Lavoisier . ZA Lavoisier . 95223 HERBLAY CEDEX
Tel. : 01.39.97.65.10 / Fax. : 01.39.97.68.48
Demande de prix / e-mail : service-commercial@motralec.com
www.motralec.com