

OPERATING LIMITS

Flow rates up to:	3,2 m³/h
Heads up to:	6 m
Max. operating pressure: :	10 bar
Temperature range :	+15°C to 110°C

DYL

DOMESTIC CIRCULATORS

Individual heating

Special body with degasser

50 Hz

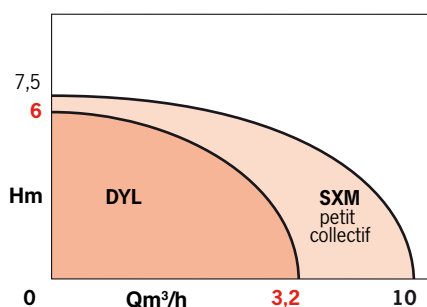

APPLICATIONS

- Circulator specially designed for fitting in a boiler.
- For the quick circulation of hot water in central heating systems in houses or apartments with individual gas or fuel oil boilers.

ADVANTAGES

- No noise problems when the boiler starts up:
- When a new system fills with water.
- After complete or partial draining of an existing system.
- No more risk of boiler safety low water level cut-outs because of air in the circulator.
- Motor self-protected against overloads.
- Multiple speeds, for better adapting to all types of system.
- High starting torque preventing the shaft from sticking.
- Low consumption of energy.
- No maintenance.

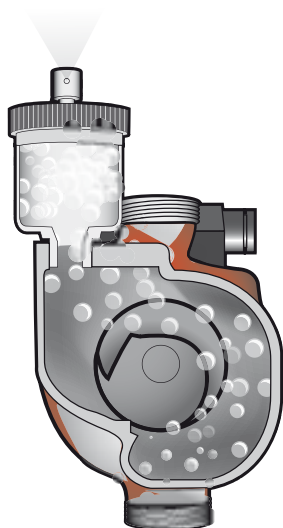

• DYL53-15P



• DYL53-15P

DYL

DESIGN

• Hydraulic part

Body with threaded orifices for direct fitting on the pipe ensuring:

- The separating of the water and air in the upper part of the body.
- The constant evacuation of the air held in the body through an automatic bleeder (option).

• Motor

Three speeds through manual selection.

Wet rotor; bearings self-lubricated by the liquid pumped.

Speed : see table
Winding : single-phase, 230 V
Frequency : 50 Hz
Insulation class : 155 (F)
Temperature class : TF110
Protection index : IP 42
Compliance : NF EN 60.335-2-51
CE

Approvals : VDE - IMQ

STANDARD CONSTRUCTION

Main part	Material
Pump casing	Cast iron
Impeller	Composite material
Airgap shaft-shell	Stainless steel
Impeller seal ring	Stainless steel
Bearing bushes	Graphite
Seals	Ethyl.-Propylene

FEATURES

a) Electrical

- All 230V-50Hz single-phase types with built-in capacitor..
- Motor protection via non-vital circuit breaker

b) Montage

- Motor axis always horizontal.

Connection to system:

- Via union fittings
- To ensure the correct operating of the degasser, the circulator must be installed in a vertical position.

c) Packaging

- Without union fittings and counterflanges.
- Without air duct (optional)

d) Maintenance

- Standard replacing of appliance.

HYDRAULIC PERFORMANCE

• 3 speeds

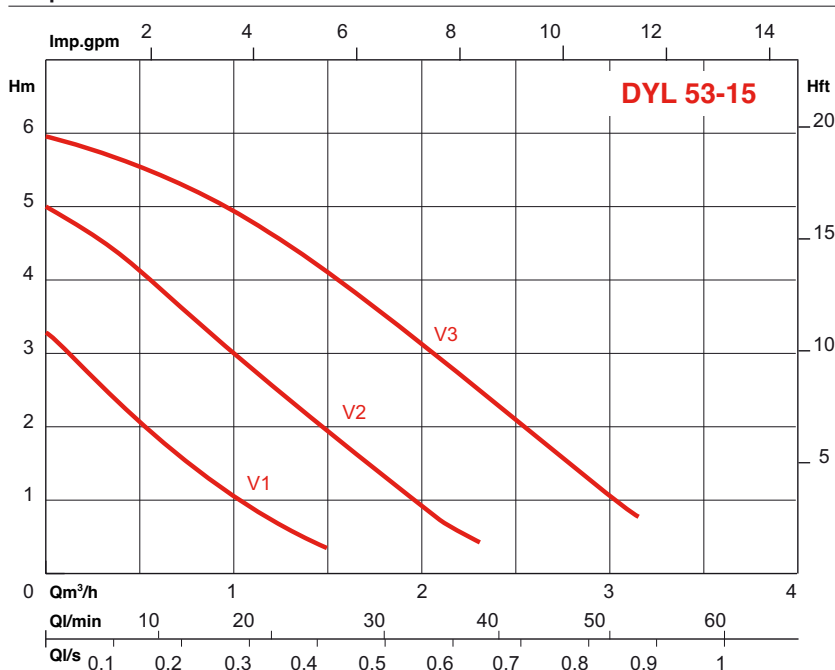

ELECTRICAL DATA AND DIMENSIONS

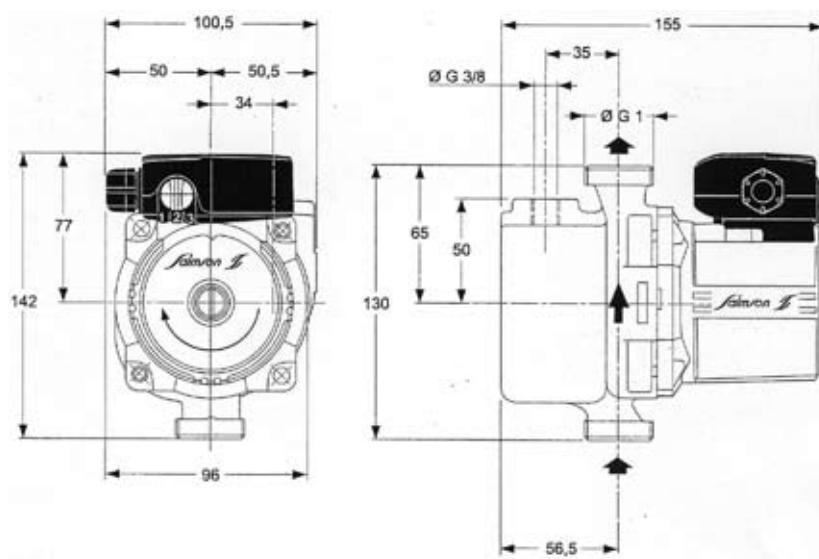

DYL 53-15P			
μF x V capacitor	2,6 x 400		
selector position	1	2	3
speed in rpm	1450	1900	2200
P1 (W)	46	67	93
intensity (A)	0,2	0,3	0,4
ØG	1 "		
mass (kg)	3		
Connection possible on ø1" threaded pipe RU 1521			

OPTIONS ET ACCESSORIES

- Automatic degasser
- Union fittings